

PRODUCT NUMBER	PITCH
V8xx31x000J0G	3.81 mm

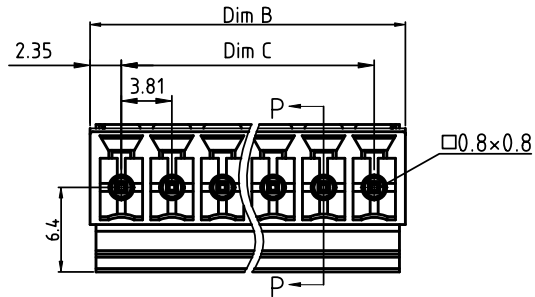
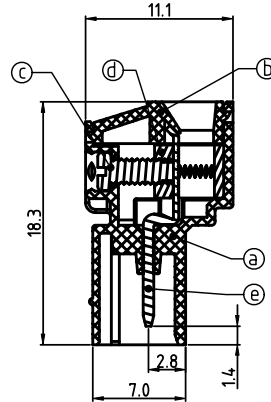
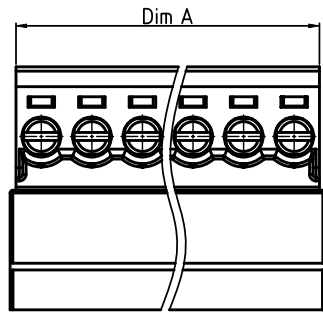
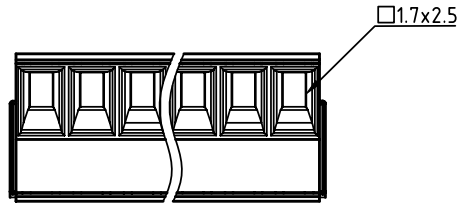

Material:

- Item (a) Insulator (Body): Thermoplastic (UL94V-0)
- Item (b) Insulator (Cover): Thermoplastic (UL94V-0)
- Item (c) Terminal screw: Steel Zinc plating "-" slot type
- Item (d) Terminal body: Brass (CuZn) Ni plating
- Item (e) Pin: Brass, Tin plated

Electrical cULus

- Voltage rating: 300VAC
- Current rating: 8A
- Solid wire (AWG): 14-30
- Stranded wire (AWG): 14-30
- Torque (Lb-In): 2.6
- Screw: M2
- Wire strip length: 7mm
- Withstanding Voltage: 1.6KV
- Operating temperature: -40°C to +115°C
- Safety Approval:

Dimension

Dim A	N x 3.81
Dim B	N x 3.81 + 0.88
Dim C	(N-1) x 3.81

N=Number of poles

POLES	Tolerance
2p-6p	±0.15
7p-13p	±0.20
14p-18p	±0.30
19p-24p	±0.40

PART NO.: V8 xx 31 x 0 00J0 G

Solid block	0	Color	Black (RAL9005)	RoHS compliant	(lead<4%)
No. of poles	2		Red (RAL3001/D)	In copper Alloy	
02	2 poles	3	Orange (RAL2011/P)		
03	3 poles	4	Yellow (RAL1018/A)		
...	...	5	Green (RAL6018/T)		
24	24 poles	6	Blue (RAL5015/A)		
		8	Grey (RAL7035/D)		
		9	White (RAL1102)		
		C	Green (RAL6018/U)		

mat'l. code		surface	tolerance	projection	product family	
		ASME Y14.5 ✓	ASME Y14.5		TERMINAL BLOCK	
ltr ecn no dr date		tolerances unless otherwise specified			title	
		angles	X.±0.5			TERMINAL BLOCK
		±	X.X±0.3			PLUGGABLE PLUG
		X*±1"	X.XX±0.1	scale		
dr		EVIN ZHONG	050514		dwg no	
enr		EVIN ZHONG	050514		sheet 1 of 1	
chr		HANKE FENG	050514		V8xx31x000J0G	
appd		SHI JUN	050514		A4	
sheet index	revision sheet	A	1		type CUSTOMER Drawing	