

1

2

3

4

5

6

7

A

A

P.C.B. LAYOUT

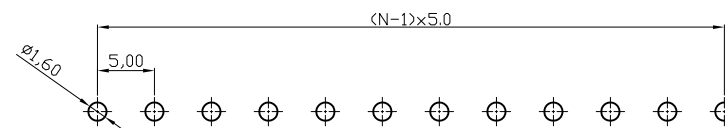

B

B

C

C

N = Number of contact

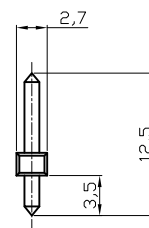
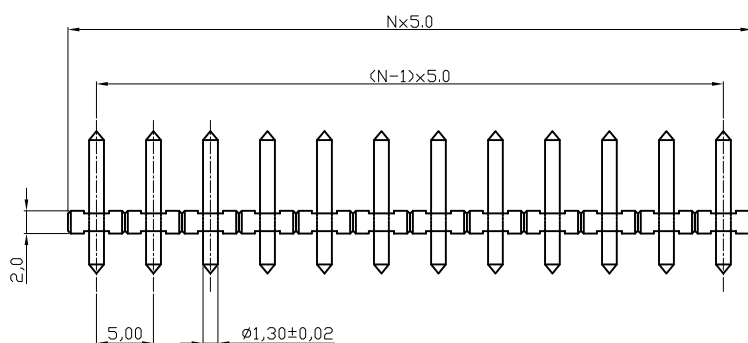

Material:

Solid PIN: Brass(CuZn)

Surface of solder tail: Matte Tin plated ④

Insulator(housing): Thermoplastic (UL94V-0)

Electrical:	UL	VDE	TUV
Voltage rating:	300V	300V	300V
Current rating:	10A	12A	15A
Withstanding Voltage:	1.6KV	2.5KV	2.5KV
Operating temperature:	-40°C to +115°C		
Soldering temperature:	250°C±10°C/5 Sec		
Safety Approval:			

D

D

E

E

F

F

RoHS compliant
Unit: mm

Scale	Free					Date	Name	Customer-No.
TOLERANCE						Drawn	07.12.2006	Hellwig
X.	±0.50							
X.X	±0.30	④	Update the plating to Matte Tin	23.07.2014	Amy	Approved	23.07.2014	Amy
X.XX	±0.10	③	Update	29.07.2009	Dean			
DIM	TOL	②	Update technical date	28.07.2008	N.Schulz			
X.°	±1°	①	Drawn	07.12.2006	Hellwig			
Angle	TOL	Id.	Modification	Date	Name			

ASSMANN
WSW components

Drawing-No. ASS 1157 CO rev04

Replace Sheet

1

2

3

4

5

6

7

SV1071

G

G

H

H