

PC board drilling dimensions (after plating)
(thickness ≤ 3.20±0.30mm)

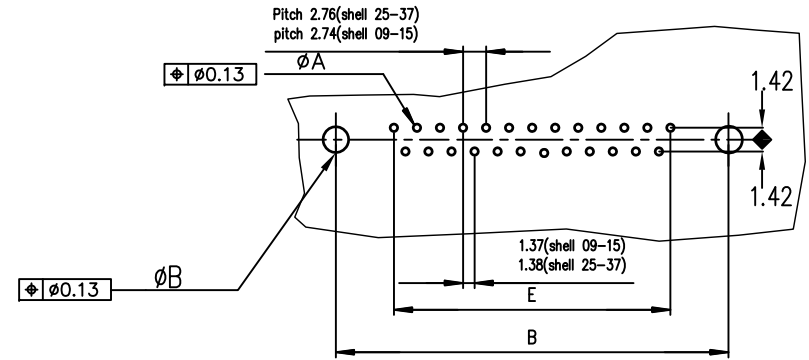

ROHS PART NUMBER

SHELL	A±0.38	B±0.12	C±0.10	D±0.25	E±0.07	PART NUMBER
09	30.81	24.99	16.96	16.21	10.96	D09S91C*GL00LF
15	39.14	33.32	25.18	24.54	19.18	D15S91C*GL00LF
25	53.03	47.04	39.12	38.25	33.12	D25S91C*GL00LF
37	69.32	63.50	55.68	54.71	49.68	D37S91C*GL00LF

Plating: 4 --> 200 mating
Plating: 6 --> 500 Mating
Plating: 8 --> 1.25µ Equivalent PdNi/Au

GENERAL CHARACTERISTICS AND ROHS INFORMATIONS:
SEE DRAWING C01-8646-0001

mat'l. code		surface ISO 1302 ✓		tolerance ISO 406 ISO 1101		projection mm		product family D-SUB	
ltr	ecn no	dr	date	tolerances unless otherwise specified		mm		title	
J	ELX-I-21654	AB	2015-10-26	angles	linear	.0±0.1	scale 2:1	FEMALE DELTA-D STRAIGHT PRESS-FIT	
K	ELX-I-24020	AAB	2016-06-06	0°±2'		.00±0.1			
						.000±0.1			
		dr	PESSON	1995-10-03			dwg no		sheet 1 of 1
		engr	MITHUN PAUL	2016-06-06			Amphenol FCi		C01-8646-0303
		chr	ATHUL A.B	2016-06-06			type		Product Customer Drawing
		appd	BIJU K PAUL	2016-06-06					
sheet index	revision	K							
	sheet	1							