

A	B	C	D	E	F
MATERIAL: NYLON 6/6 UL-94 V-2, RMS-01 COLOUR:NATURAL	MATERIAL: NYLON 6/6 UL-94 V-0, RMS- 19 COLOUR:NATURAL	"A"	"B" REF.	BUNDLE Ø	
STL-J#-250-4M-01	STL-J#-250-4M-19	4[0.157]			
STL-J#-250-3-01	STL-J#-250-3-19	4.8[0.189]			
STL-J#-250-6M-01	STL-J#-250-6M-19	6[0.236]			
STL-J#-250-8M-01	STL-J#-250-8M-19	8[0.315]			
STL-J#-250-10M-01	STL-J#-250-10M-19	10[0.394]			
STL-J#-250-12M-01	STL-J#-250-12M-01	12[0.472]			
STL-J#-250-8-01	STL-J#-250-8-19	12.7[0.500]			
STL-J#-250-12-01	STL-J#-250-12-19	19.1[0.752]			
STL-J#-250-16-01	STL-J#-250-16-19	25.4[1]			
STL-J#-250-20-01	STL-J#-250-20-19	31.8[1.252]			
STL-J#-350-4M-01	STL-J#-350-4M-19	4[0.157]			
STL-J#-350-3-01	STL-J#-350-3-19	4.8[0.189]			
STL-J#-350-6M-01	STL-J#-350-6M-19	6[0.236]			
STL-J#-350-8M-01	STL-J#-350-8M-19	8[0.315]			
STL-J#-350-10M-01	STL-J#-350-10M-19	10[0.394]			
STL-J#-350-12M-01	STL-J#-350-12M-19	12[0.472]			
STL-J#-350-8-01	STL-J#-350-8-19	12.7[0.500]			
STL-J#-350-12-01	STL-J#-350-12-19	19.1[0.752]			
STL-J#-350-16-01	STL-J#-350-16-19	25.4[1]			
STL-J#-350-20-01	STL-J#-350-20-19	31.8[1.252]			
STL-J#-450-4M-01	STL-J#-450-4M-19	4[0.157]			
STL-J#-450-3-01	STL-J#-450-3-19	4.8[0.189]			
STL-J#-450-6M-01	STL-J#-450-6M-19	6[0.236]			
STL-J#-450-8M-01	STL-J#-450-8M-19	8[0.315]			
STL-J#-450-10M-01	STL-J#-450-10M-19	10[0.394]			
STL-J#-450-12M-01	STL-J#-450-12M-19	12[0.472]			
STL-J#-450-8-01	STL-J#-450-8-19	12.7[0.500]			
STL-J#-450-12-01	STL-J#-450-12-19	19.1[0.752]			
STL-J#-450-16-01	STL-J#-450-16-19	25.4[1]			
STL-J#-450-20-01	STL-J#-450-20-19	31.8[1.252]			
STL-J#-600-4M-01	STL-J#-600-4M-19	4[0.157]			
STL-J#-600-3-01	STL-J#-600-3-19	4.8[0.189]			
STL-J#-600-6M-01	STL-J#-600-6M-19	6[0.236]			
STL-J#-600-8M-01	STL-J#-600-8M-19	8[0.315]			
STL-J#-600-10M-01	STL-J#-600-10M-19	10[0.394]			
STL-J#-600-12M-01	STL-J#-600-12M-19	12[0.472]			
STL-J#-600-8-01	STL-J#-600-8-19	12.7[0.500]			
STL-J#-600-12-01	STL-J#-600-12-19	19.1[0.752]			
STL-J#-600-16-01	STL-J#-600-16-19	25.4[1]			
STL-J#-600-20-01	STL-J#-600-20-19	31.8[1.252]			
STL-J#-750-4M-01	STL-J#-750-4M-19	4[0.157]			
STL-J#-750-3-01	STL-J#-750-3-19	4.8[0.189]			
STL-J#-750-6M-01	STL-J#-750-6M-19	6[0.236]			
STL-J#-750-8M-01	STL-J#-750-8M-19	8[0.315]			
STL-J#-750-10M-01	STL-J#-750-10M-19	10[0.394]			
STL-J#-750-12M-01	STL-J#-750-12M-19	12[0.472]			
STL-J#-750-8-01	STL-J#-750-8-19	12.7[0.500]			
STL-J#-750-12-01	STL-J#-750-12-19	19.1[0.752]			
STL-J#-750-16-01	STL-J#-750-16-19	25.4[1]			
STL-J#-750-20-01	STL-J#-750-20-19	31.8[1.252]			

OTHER COLOURS AVAILABLE BY SPECIAL ORDER

STANDARD FIX
(DELETE THE # IN
THE PART NUMBER)

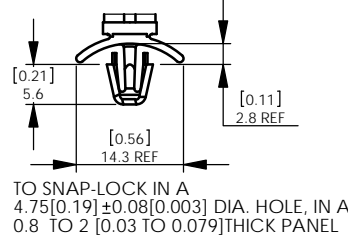

FIX 1

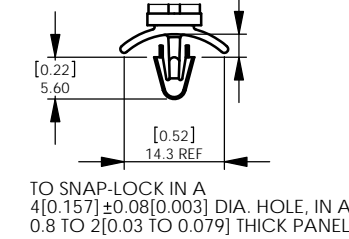

FIX 2

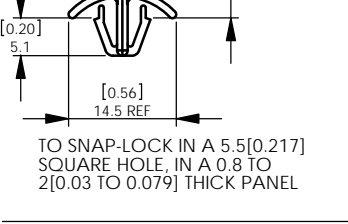

FIX 3

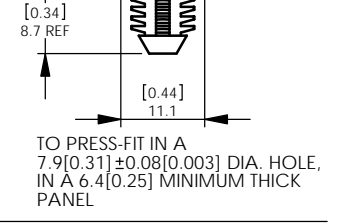

FIX 5

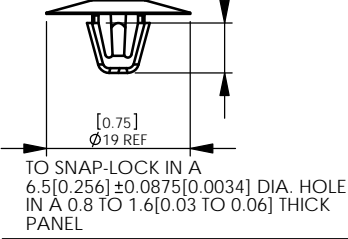

FIX 6

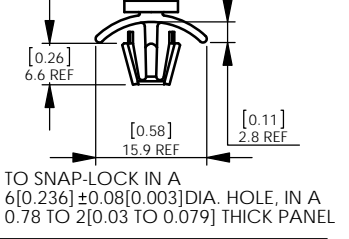

FIX 7

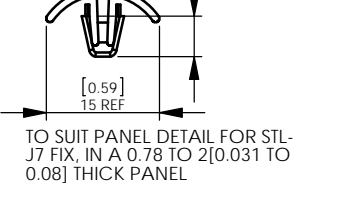

FIX-9

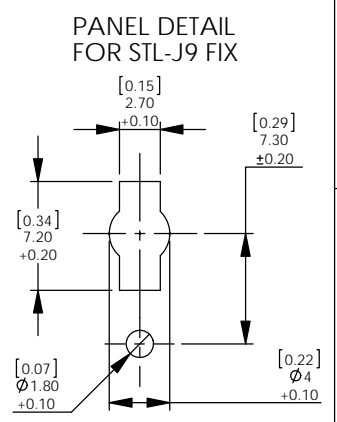
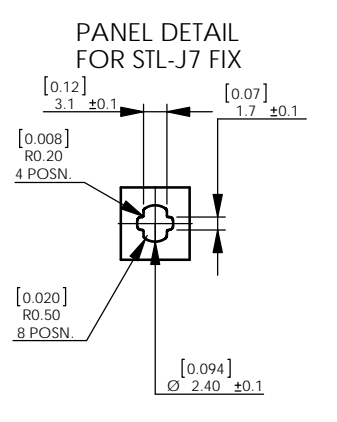
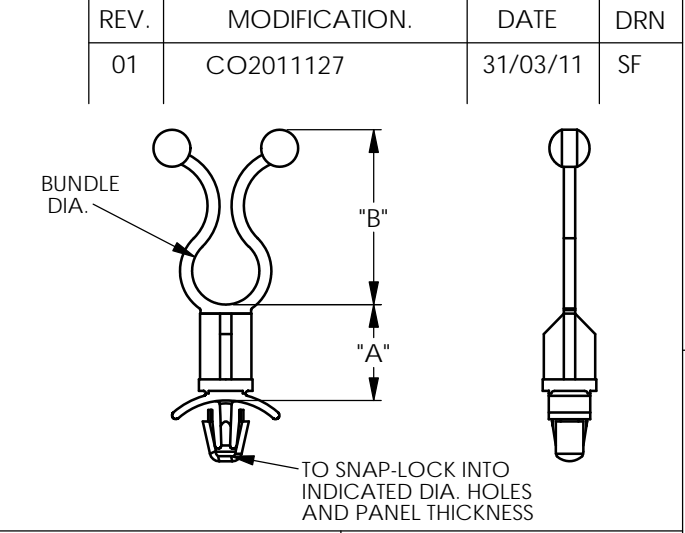
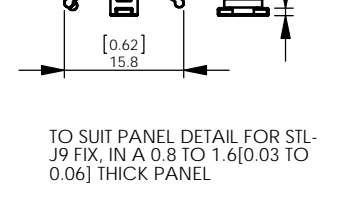

INFORMATION CONTAINED IN THIS DOCUMENT IS CONFIDENTIAL TO RICHCO INTERNATIONAL Co. Ltd. AND MAY NOT BE DISCLOSED OR REPRODUCED IN WHOLE OR PART WITHOUT THEIR WRITTEN CONSENT.

RICHCO, INC.
WWW.RICHCO-INC.COM

ALL DIMENSIONS IN mm[inches]
GENERAL TOLERANCES ±0.25
UNLESS OTHERWISE STATED
1 DECIMAL PLACE ±
2 DECIMAL PLACES ±
ANGULAR ±1°

THIRD ANGLE

MATERIAL: See table

COLOUR: See table

DESCRIPTION: STAND-OFF TWIST LOCK

PART No: See Table

DRG No: 011-014

NPR No: RR10-0002

SHEET SIZE A4

DRN	DATE	CHKD	DATE	SCALE	SHEET No.
SF	14/02/11	TC	14/02/11	NTS	1 OF 1

NOTE:
ALTERNATE DIMENSIONS FOR REFERENCE ONLY

REPLACE # WITH FIX STYLE REQUIRED.
EXAMPLE:
"STL-J1-250-4M-01"