

PRODUCT NUMBER	PITCH
VMxx55x000J0G	5.08 mm

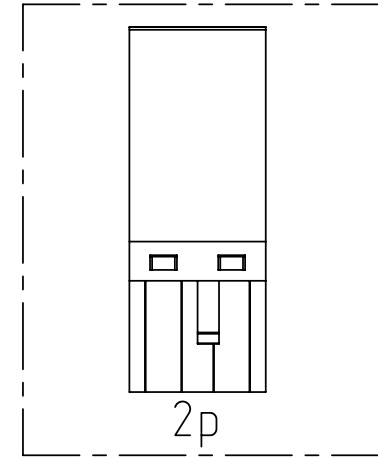
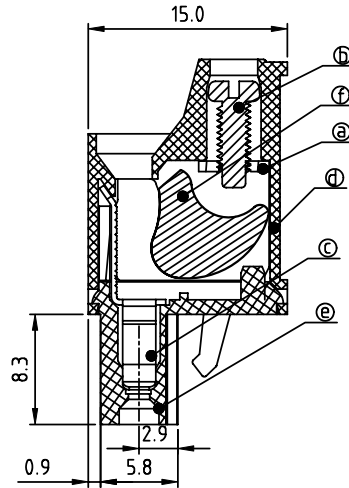
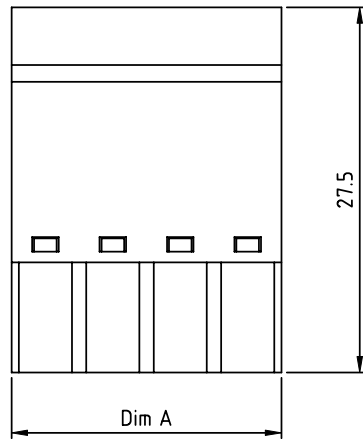
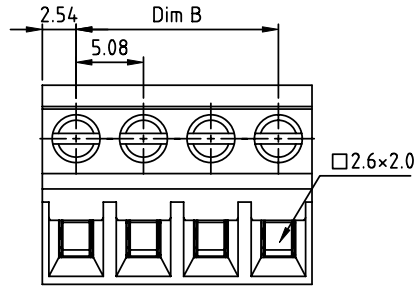

Material:

- Item ③ Clamp: Steel zinc plated.
- Item ④ Terminal screw: Steel Zinc plating "-" slot type
- Item ⑤ Female contact: High conductivity copper ,Tin plated
- Item ⑥ Terminal (top body): Thermoplastic (UL94V-0)
- Item ⑦ Terminal (bottom body): Thermoplastic (UL94V-0)
- Item ⑧ Clampage: Steel Zinc plated

Electrical cULus/TUV

- Voltage rating: 300VAC/300VAC
- Current rating: 20A/20A
- Wire range: 0.34-2.5mm<sup>2</sup>
- Solid wire(AWG): 12-22
- Stranded wire(AWG): 12-22
- Torque: 3.5Lb-In / 0.4Nm
- Screw: M2.5
- Wire strip length: 6-7mm
- Withstanding Voltage: 1.6KV/2.5KV
- Operating temperature: -40°C to +115°C
- Safety approval: us

N = Number of poles  
Dim A=Nx5.08  
Dim B=(N-1)x5.08

poles	Tolerance
2P-6P	±0.20
7P-12P	±0.25
13P-18P	±0.30
19P-24P	±0.40

PART NO.: VM xx 55 x 0 00J0 G

- Solid block
  - No. of poles
  - Color
  - RoHS compliant (lead<4%) In copper Alloy
- |     |          |   |                   |
|-----|----------|---|-------------------|
| 02  | 2 poles  | 0 | Black (RAL9005)   |
| 03  | 3 poles  | 1 | Red (RAL3001/D)   |
| ... | ...      | 2 | Orange(RAL2011/P) |
| ... | ...      | 3 | Yellow(RAL1018/A) |
| 24  | 24 poles | 4 | Green(RAL6018/T)  |
|     |          | 5 | Blue (RAL5015/A)  |
|     |          | 6 | Grey(RAL7035/D)   |
|     |          | 7 | White(RAL1102)    |
|     |          | 8 | Green(RAL6018/U)  |

mat'l. code		surface ASME Y14.5	tolerance ASME Y14.5	projection 	product family TERMINAL BLOCK		
ltr	ecn no	dr	date		title TERMINAL BLOCK		
				tolerances unless otherwise specified	PLUGGABLE PLUG, WIHTOUT FLANGE		
				angles 	scale		
				parallelism 	MM		
				perpendicularity 	scale		
				X*±1"	X.XX±0.1		
dr		EVIN ZHONG	042114		dwg no	sheet 1 of 1	size
enr		EVIN ZHONG	042114		VMxx55x000J0G	A4	
chr		HANKE FENG	042114				
appd		SHI JUN	042114		type	CUSTOMER Drawing	
sheet index	revision sheet	A	1				