

IEC Appliance Outlet J, Screw-on Mounting, Front Side, Quick-connect Terminal



Description

- Panel Mount :
Screw-on mounting , from front side
- 1 Function :

- Connector , Pin temperature 70 °C , Protection class I
- Quick connect terminals

Approvals

- VDE Certificate Number: 40012242
- UL File Number: E103791

Weblinks

[pdf datasheet](#), [html-datasheet](#), [General Product Information](#), [RoHS](#), [CHINA-RoHS](#), [REACH](#), [Distributor-Stock-Check](#), [Accessories](#), [Detailed request for product](#)

Technical Data

| | |
|---------------------------------|---|
| Ratings IEC | 16A / 250VAC; 50Hz |
| Ratings UL/CSA | 20A / 250VAC; 60Hz |
| Dielectric Strength | > 4 kVAC between L-N > 2 kVAC between L/N-PE (1 min/50Hz) |
| Allowable Operation Temperature | -25 °C to 70 °C |
| IP-Protection | from front side IP 40 acc. to IEC 60529 |
| Insulation cover | Suitable for appliances with protection class I acc. to IEC 61140 |
| Material: Housing | PA6, black / grey / white, UL 94V-0 |

Detailed information on product approvals, code requirements, usage instructions and detailed test conditions can be looked up in [General Product Information](#)

Dimensions

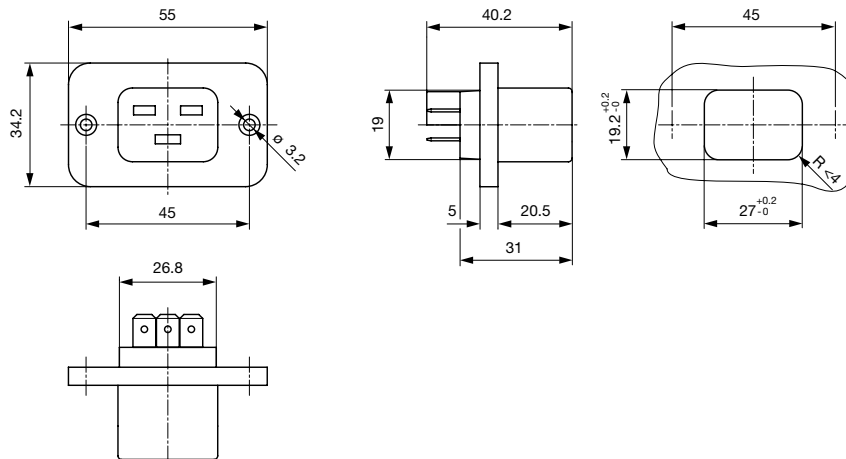

Length of the terminal please find at the order code configuration table

Config. Code

5017 - H - A B C 0 - D - E O

The characters are placeholders for the correspondingly keys of selections from the key tables.

5017 - H - A B C 0 - D - E O = Type

| Type | Configuration key |
|--------------------|-------------------|
| protection class I | X |

5017 - H - A B C 0 - D - E O = Terminals

| Terminal L | Configuration key |
|---|-------------------|
| Blade terminal (6.3 x 0.8 mm)  | 9 |

5017 - H - A B C 0 - D - E O = Terminals

| Terminal N | Configuration key |
|-------------------------------|-------------------|
| Blade terminal (6.3 x 0.8 mm) | 9 |

Symbols similar as in table A

5017 - H - A B C 0 - D - E O = Terminals

| Terminal Ground | Configuration key |
|-------------------------------|-------------------|
| Blade terminal (6.3 x 0.8 mm) | 9 |

Symbols similar as in table A

5017 - H - A B C 0 - D - E O = Color

| Color | Configuration key |
|-------|-------------------|
| Black | A |

| Color | Configuration key |
|-------|-------------------|
| Grey | B |
| White | D |

5017 - H - A B C 0 - D - E O = Style

| Style | Configuration key |
|-------------------------------|-------------------|
| flange with countersunk holes | 1 |
| flange with through holes | 2 |

5017 - H - A B C 0 - D - E O = Features

| Features | Configuration key |
|--|-------------------|
| not used | 0 |
| dead cover | 1 |
| holder for 1 fuse (text legible, when inlet on top) | 2 |
| holder for 1 fuse (text legible, when inlet on bottom) | 3 |
| holder for 1 or 2 fuses (text legible, when inlet on top) | 4 |
| holder for 1 or 2 fuses (text legible, when inlet on bottom) | 5 |
| voltage selector with 1 fuse | 6 |
| voltage selector with 2 fuses | 7 |
| thermal circuit breaker for rated current 4A | A |
| thermal circuit breaker for rated current 6A | B |
| thermal circuit breaker for rated current 8A | C |
| thermal circuit breaker for rated current 10A | D |
| thermal circuit breaker for rated current 15A | E |
| thermal circuit breaker for rated current 20A | F |
| V-Lock | V |

All Variants

| Config. Code | Description | Order Number |
|-----------------|--|--------------|
| 5017-X-9990-A-1 | 5017, IEC Appliance Outlet, 70°C, version: I, L: Blade terminal (6.3 x 0.8 mm), N: Blade terminal (6.3 x 0.8 mm), ground: Blade terminal (6.3 x 0.8 mm), color: Black, design: flange with countersunk holes, dimension S: | 6183.0004 |

The listet variants should be available from stock Other versions on request www.schurter.com/contactAvailability for all products can be searched real-time: <http://www.schurter.com/en/Stock-Check/Stock-Check-SCHURTER>

Packaging unit 50 Pcs

Mating Inlets/Plugs

Category / Description



[Plug Overview complete](#)

IEC Plug I, Cord Connector (Rewireable), Straight

4796

IEC Plug I, Cord Connector (Rewireable), Angled

4789

[Plug further types to 5017](#)