

THIS DRAWING IS UNPUBLISHED. RELEASED FOR PUBLICATION 2003  
 (C) COPYRIGHT 2003 ALL RIGHTS RESERVED.

| LOC | DIST | REVISIONS |     |               |           |     |      |
|-----|------|-----------|-----|---------------|-----------|-----|------|
| A   | I    | P         | LTR | DESCRIPTION   | DATE      | DWH | APVD |
|     |      | B         |     | ECR-12-002845 | 17APR2012 | MKD | RRP  |
|     |      | B1        |     | ECR-14-006224 | 28APR2014 | KD  | BW   |

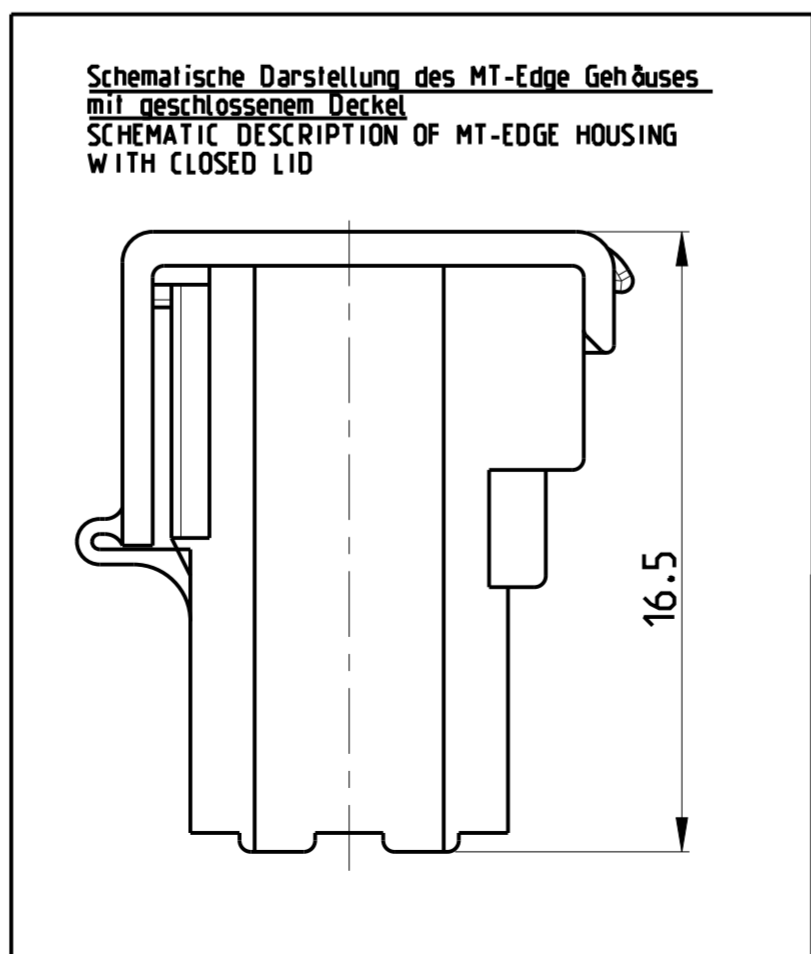
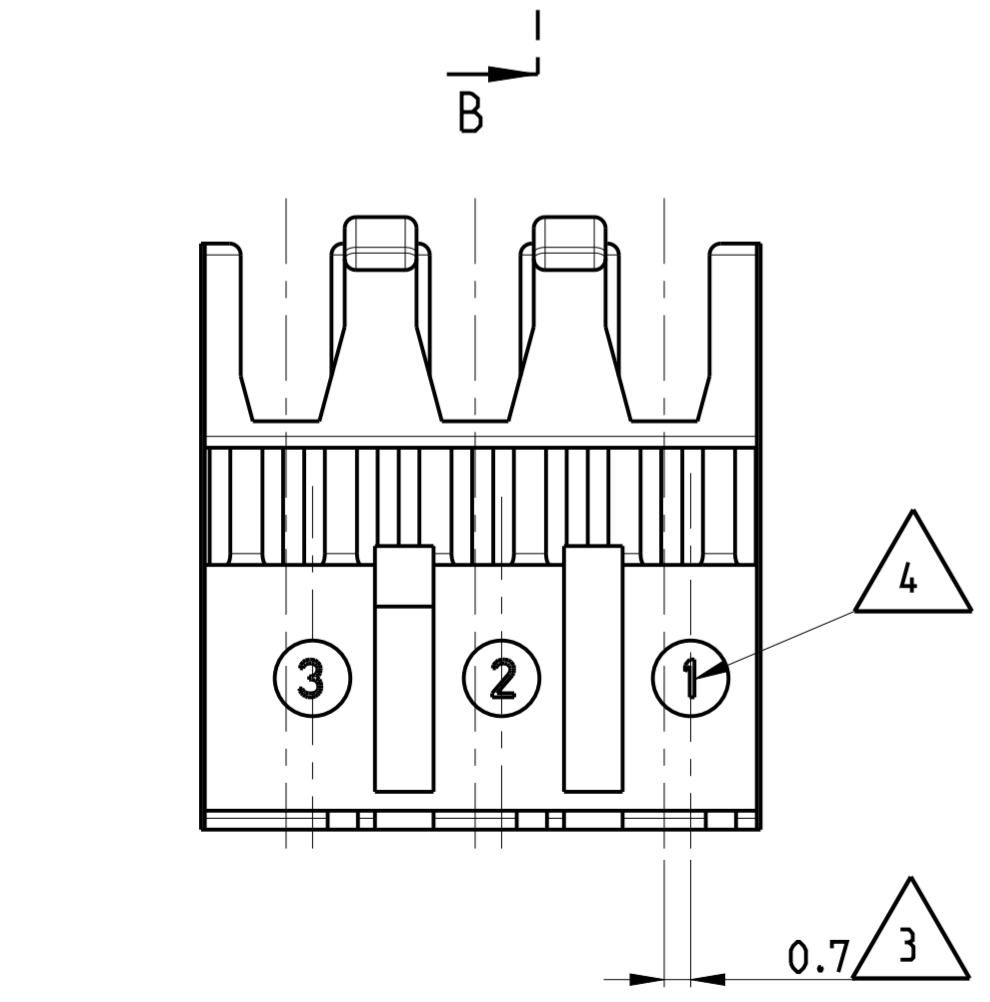
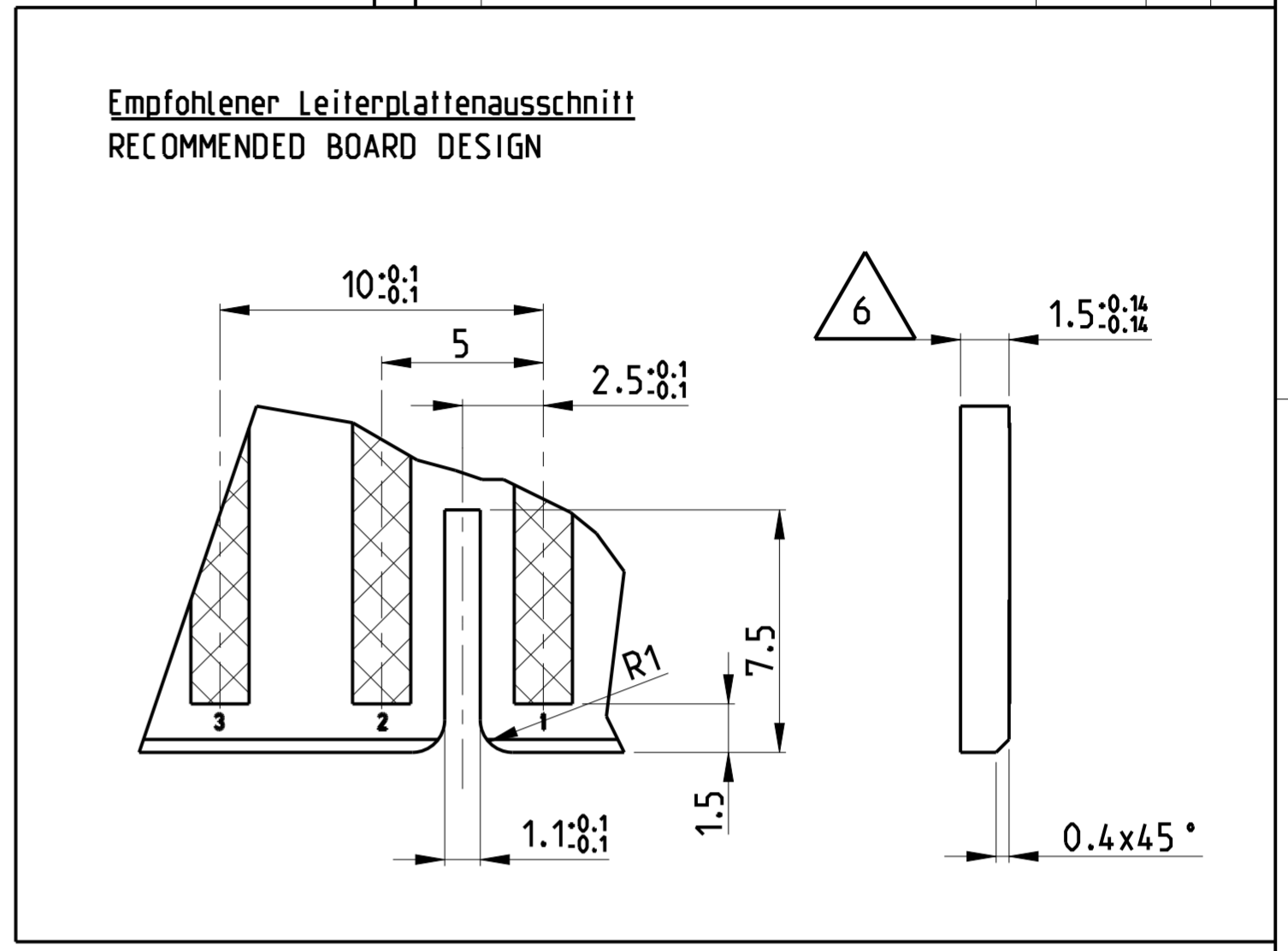
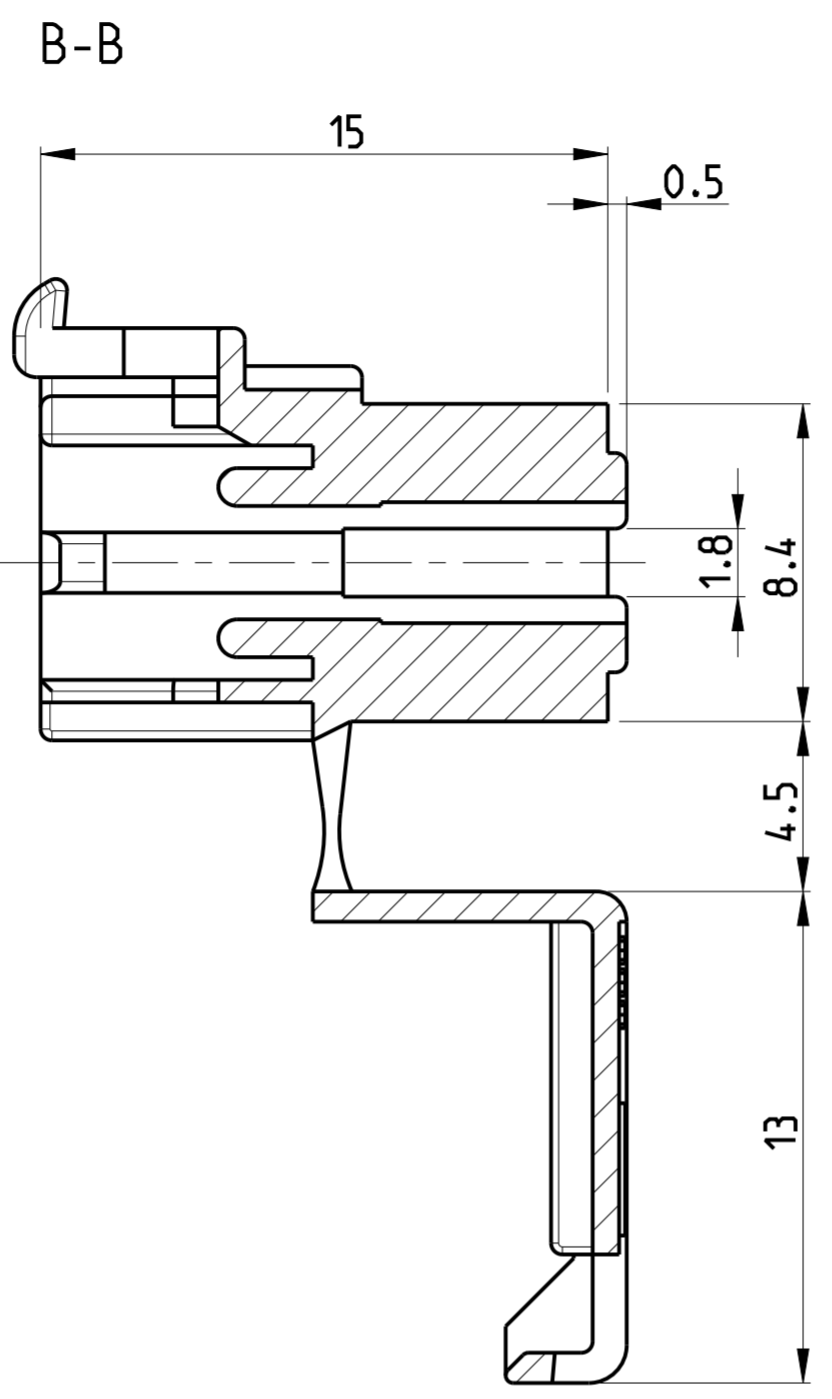
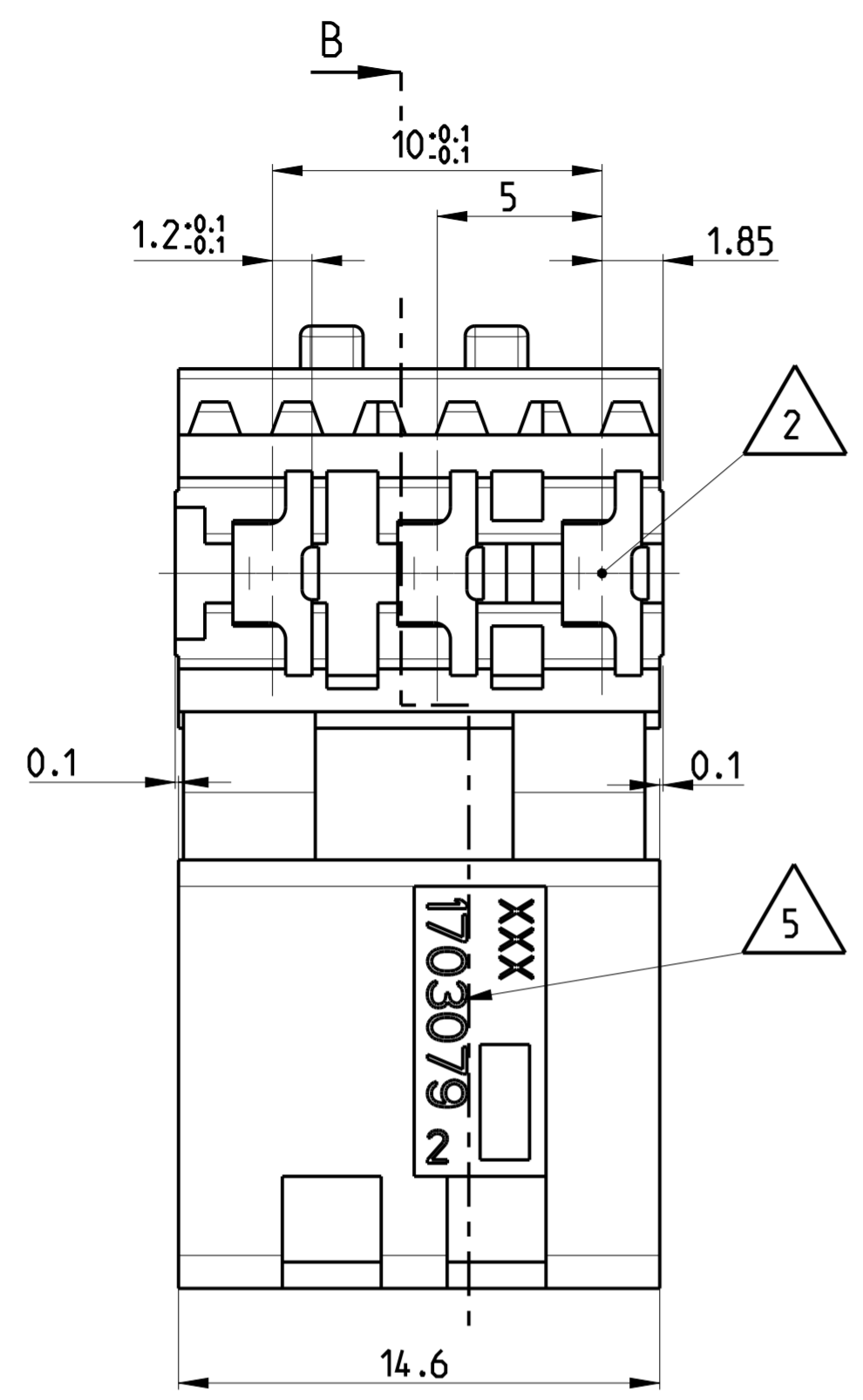

Bemerkungen  
NOTES

- 1 Massgebend ist der deutsche Text  
ONLY THE GERMAN-LANGUAGE VERSION SHALL BE BINDING
- 2 Lage des Kontaktpunktes auf der Leiterplatte; Abweichung ±0.4  
POSITION OF CONTACT POINT ON BOARD; DEVIATION ±0.4
- 3 Kontaktierung zur Drahtmitte um 0.7mm versetzt  
CONTACTING 0.7mm DISPLACED TO WIRE CENTRELINE
- 4 Kontaktkammer-Nr.  
CONTACT CAVITY #
- 5 Firmenlogo und Leergehäuse-Nr.  
ARTWORK LOGO AND HOUSING # (NON LOADED)
- 6 Ausführung nach DIN 60249-2-4  
BOARD DESIGN ACCORDING TO DIN 60249-2-4
- 7 Crimp Kontakt-Nr.:  
Material: CuSn4 926770-1, 926917-1  
CRIMP CONTACT #:  
MATERIAL: CuSn4

|             |                 |        |
|-------------|-----------------|--------|
| 1-1703079-1 | MT-EDGE HOUSING | NATURE |
| PART NO.    | DESCRIPTION     | COLOR  |

THIS DRAWING IS A CONTROLLED DOCUMENT.

|                             |  |  |  |
|-----------------------------|--|--|--|
| DIMENSIONS:<br>mm           | TOLERANCES UNLESS OTHERWISE SPECIFIED:<br>0 PLC ±<br>1 PLC ±0.15mm<br>2 PLC ±<br>3 PLC ±<br>4 PLC ±<br>ANGLES ±°<br>FINISH | DWH MAHNKE, B. 24SEP2004<br>CHK STREDAK, F. 20DEC2004<br>APVD BLFICHER, M. 21DEC2004 | NAME<br>3 POS. MT-EDGE HOUSING<br>RAST 5mm |
| MATERIAL<br>PA6.6 / UL94V-2 | PRODUCT SPEC<br>108-18003<br>APPLICATION SPEC<br>114-18002   | WEIGHT<br>1.491 g  | SIZE<br>A2                                 |
| CUSTOMER DRAWING            |  | SCALE<br>5:1   | RESTRICTED TO<br>-                         |

STE TE Connectivity

SCALE 5:1 SHEET 1 OF 1 REV B1