

NOTES:

1. PARTS ARE (c UL us) LISTED.
2. FOR COPPER WIRE ONLY
3. PANDUIT PART NUMBERS WITH A "T" ARE TIN PLATED
4. PKG QTY: Q = 25
L = 50
C = 100
D = 500
5. SEE LABEL FOR SCREW TURQUE VALUES

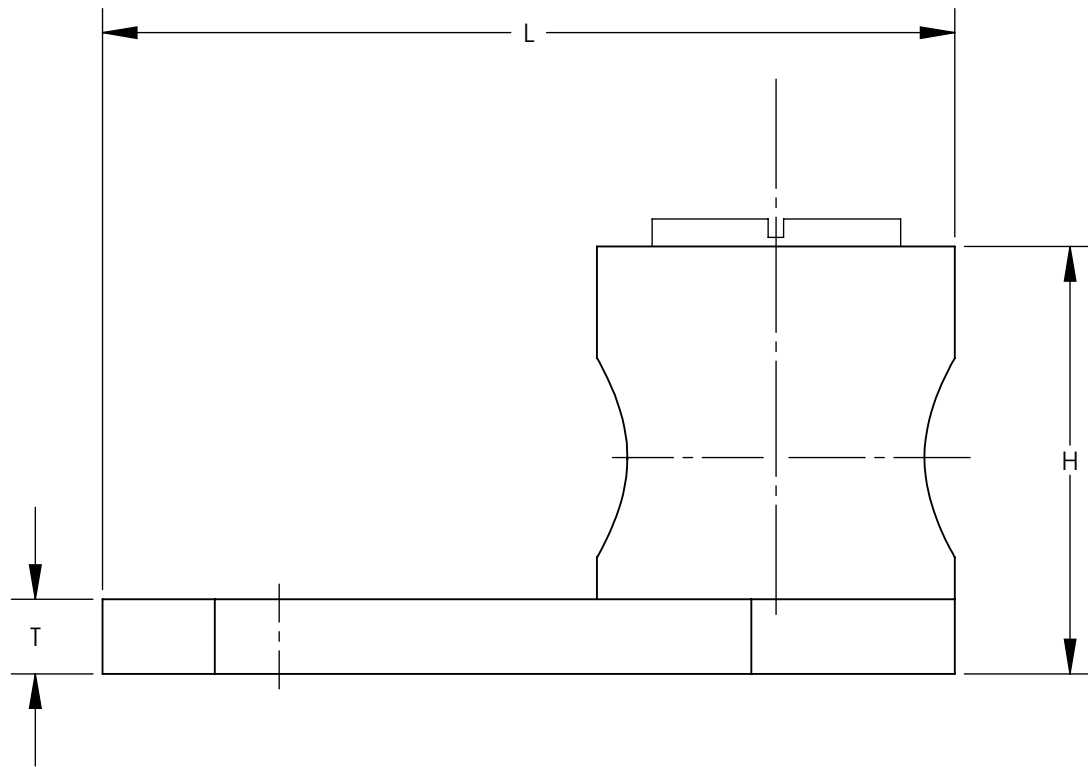

PANDUIT PART NUMBER	CONDUCTOR RANGE	APPROXIMATE DIMENSIONS +/- .02					INSTALLATION TOOL
		BOLT SIZE	W	H	T	L	
ML8-CY	14 SOL. - 8 STR.	3/16	0.38	0.42	0.08	0.81	SLOT SCREWDRIVER
ML8T-CY	14 SOL. - 8 STR.	3/16	0.38	0.42	0.08	0.81	
ML4-CY	14 SOL. - 4 STR.	1/4	0.54	0.55	0.09	1.11	
ML4T-CY	14 SOL. - 4 STR.	1/4	0.54	0.55	0.09	1.11	
ML1/0-LY	14 SOL. - 1/0 STR.	5/16	0.73	0.79	0.09	1.57	1/4" HEX WRENCH
ML1/0T-LY	14 SOL. - 1/0 STR.	5/16	0.73	0.79	0.09	1.57	
ML250-QY	6 STR. - 250kcmil	3/8	0.94	1.06	0.12	1.94	
ML250T-QY	6 STR. - 250kcmil	3/8	0.94	1.06	0.12	1.94	

REV	DATE	BY	CHK	APR	DESCRIPTION	ECN
06	2/13	JHNU	JHNU	RGB	REVISED TITLE BLOCK	N41569BB-C41569

TITLE ML SERIES COPPER MECHANICAL LUGS CUSTOMER DRAWING	
ITEM REVISION NAME C41569/06	PANDUIT
DATASET FILE NAME C41569/06.SLDDRW	
UNLESS OTHERWISE SPECIFIED, DIMENSIONAL TOLERANCES ARE: IN [mm] .X ± .XXX ± .XX ± ANGLES ±	
THIRD ANGLE PROJECTION	
DRAWN BY JHNU	DATE 7/06
CHK JHNU	SCALE NONE
DRAWING NUMBER C41569_11	
SHEET 1 OF 1	
SIZE B	