

THIS IS A C.A.D. GENERATED DRAWING  
DO NOT MAKE MANUAL REVISIONS TO MASTER  
ALL TOLERANCES UNLESS OTHERWISE SPECIFIED 2/98

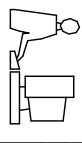

ISSUE NUMBER  
ORIGINAL  
. 1

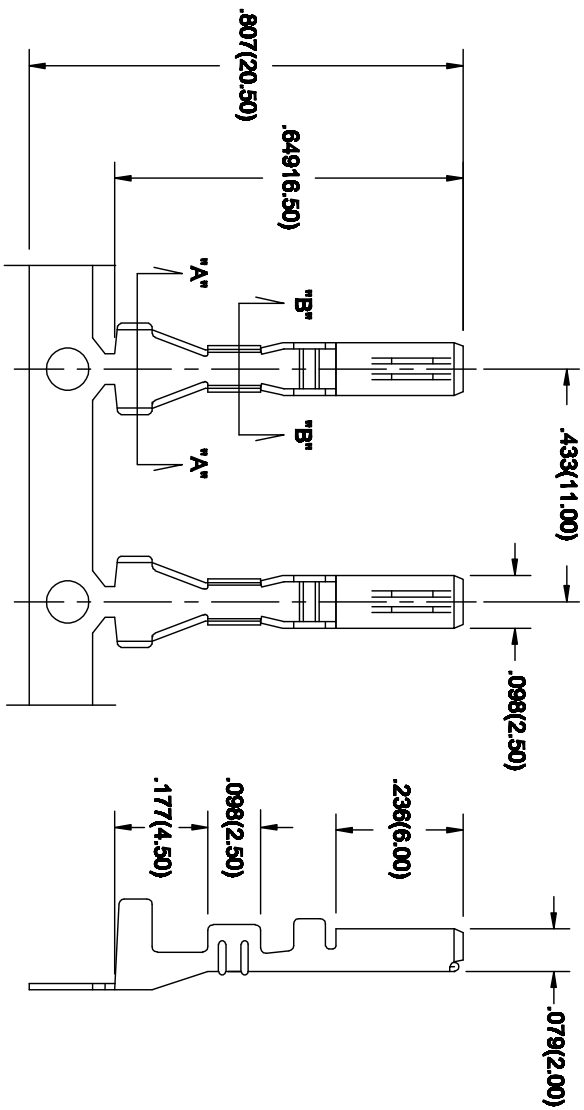

MATERIAL: BRASS, TIN PLATED

PART NUMBER 570-290-721 WILL BE IN REEL 4,000 PCS  
PART NUMBER 570-290-721P60 WILL BE IN STRIP 40 PCS

570 SERIES FEMALE CRIMP CONTACT  
WIRE RANGE AWG 22 TO 20

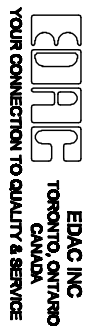

THESE DRAWINGS AND SPECIFICATIONS  
ARE THE PROPERTY OF EDAC INC. AND  
SHALL NOT BE REPRODUCED, COPIED,  
MANIPULATED OR SAID FOR REPRODUCTION  
WITHOUT WRITTEN PERMISSION.

ACAD REF DWG NUMBER	570-290-721
DRAWN: F.BRONES	DATE: JUN 01/14
CHECKED:	DATE:
PART NUMBER	570-290-721
DRAWING NUMBER	570-290-721
ISSUE	1