

# INTERCONNECTS

## SERIES 714...00X • .100" GRID LOW PROFILE CARRIERS • SINGLE AND DOUBLE ROW STRIPS

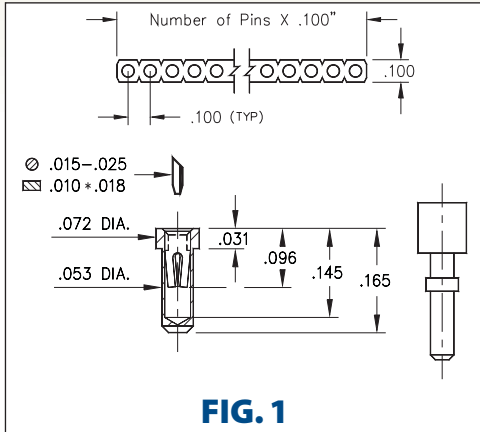

**FIG. 1**

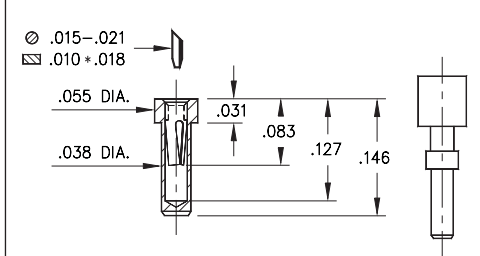

**FIG. 2**



**FIG. 3**

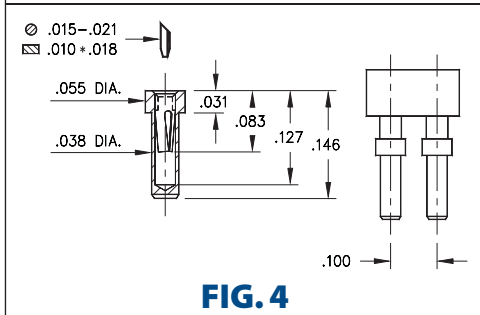

**FIG. 4**

- Low profile receptacles sit .031" above the board
- Series 714 use MM #1401 and MM #1407 pin receptacles. See pages 157 and 170 for details
- Hi-Rel, 4-finger BeCu #30 contact is used in the #1401 receptacle and a BeCu #11 contact is used in the #1407. Both contacts are rated at 3 amps. See pages 251 and 253 for details
- Insulators are high temperature thermoplastic, suitable for all soldering operations



### ORDERING INFORMATION

<b>FIG. 1</b>	<b>Single Row (.055" min. mounting hole)</b>
	714-XX-1__-41-001000 Specify number of pins      01-64
<b>FIG. 2</b>	<b>Single Row (.039" min. mounting hole)</b>
	714-XX-1__-31-007000 Specify number of pins      01-64
<b>FIG. 3</b>	<b>Double Row (.055" min. mounting hole)</b>
	714-XX-2__-41-001000 Specify number of pins      04-64
<b>FIG. 4</b>	<b>Double Row (.039" min. mounting hole)</b>
	714-XX-2__-31-007000 Specify number of pins      04-64



XX=Plating Code  
See Below

For  
Electrical, Mechanical  
& Environmental Data,  
See page 264

<b>SPECIFY PLATING CODE XX=</b>		91	93		41	43	
Sleeve (Pin)		200 μ"Sn/Pb	200 μ"Sn/Pb		200 μ"Sn	200 μ"Sn	
Contact (Clip)		10 μ"Au	30 μ"Au		10 μ"Au	30 μ"Au	

