

PIN RECEPTACLES

FOR .015" - .022" DIAMETER PINS

6561

6561-0-15-XX-05-XX-10-0

Solder mount in .051 min. mounting hole

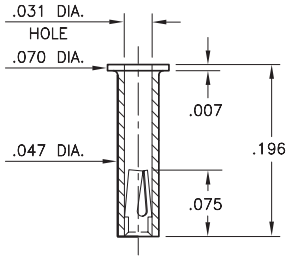

<p>6561 6561-0-15-XX-05-XX-10-0 Solder mount in .051 min. mounting hole</p>			

SPECIFICATIONS:

Shell Material: Brass Alloy 360, 1/2 Hard

Contact Material: Beryllium Copper Alloy 172, HT

Dimensions: Inches

Tolerances On: Lengths: ±.005

Diameters: ±.002

Angles: ± 2°



ORDER CODE: XXXX - X - XX - XX - 05 - XX - 10 - 0

BASIC PART #

SPECIFY SHELL FINISH:

01 200 μ" TIN/LEAD OVER NICKEL

◆ 80 200 μ" TIN OVER NICKEL (RoHS)

◆ 15 10 μ" GOLD OVER NICKEL (RoHS)

SPECIFY CONTACT FINISH:

02 100 μ" TIN/LEAD OVER NICKEL

◆ 84 100 μ" TIN OVER NICKEL (RoHS)

◆ 27 30 μ" GOLD OVER NICKEL (RoHS)

SELECT CONTACT:

#05 CONTACT (DATA ON PAGE 251)

(For alternate contact choices, see group A on page 248)