

IPL1-1XX-XX-XXX-S-XX-X-XX

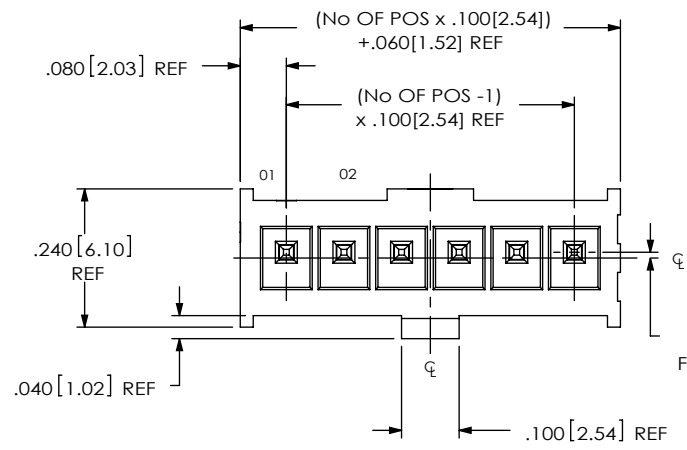

No OF POSITIONS
-02 THRU -25

LEAD STYLE
-01: THROUGH HOLE (USE T-1S64-XX-XX)
-02: SURFACE MOUNT (SEE FIG. 2, SHT 2) (USE T-1S64-XX-XX)

PACKAGING OPTION
-TR: TAPE & REEL (AVAILABLE WITH -02 LEAD STYLE ONLY) (MUST USE K-DOT-.177-.281-.005) (SEE FIG 5, SHT 3)

POLARIZATION OPTION
-K: KEYED POLARIZATION (USE IPL1-XX-S-K) (SEE FIG 4, SHEET 3) (LEAVE BLANK FOR NO POLARIZATION, SAMTEC WILL ONLY SUPPORT EXISTING BUSINESS AS OF REV J)

OPTION
-RA: RIGHT ANGLE (SEE FIG 3, SHT 3) (AVAILABLE WITH -01 LEAD STYLE ONLY)

ROW SPECIFICATION
-S: SINGLE (USE IPL1-XX-S)

PLATING SPECIFICATION
-F: FLASH SELECTIVE (USE T-1S64-XX-F)
-L: LIGHT SELECTIVE (USE T-1S64-XX-L)
-S: SELECTIVE (USE T-1S64-XX-S)
-H: HEAVY GOLD (USE T-1S64-XX-H)
-FM: FLASH SELECTIVE/MATTE TIN TAILS (USE T-1S64-XX-F)
-LM: LIGHT SELECTIVE/MATTE TIN TAILS (USE T-1S64-XX-L)
-SM: SELECTIVE/MATTE TIN TAILS (USE T-1S64-XX-S)
-STL: LIGHT SELECTIVE TIN/LEAD (USE T-1S64-XX-STL)

FIG 1
IPL1-106-01-XXX-S SHOWN

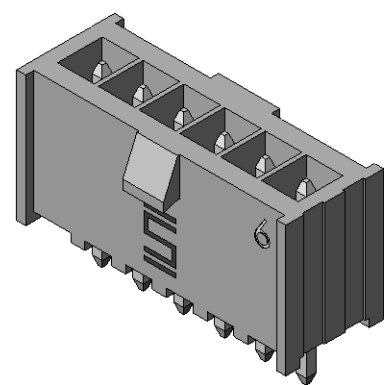
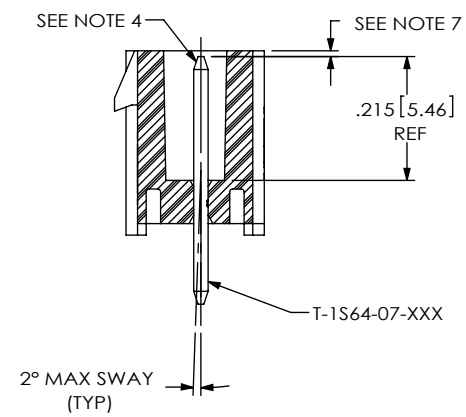
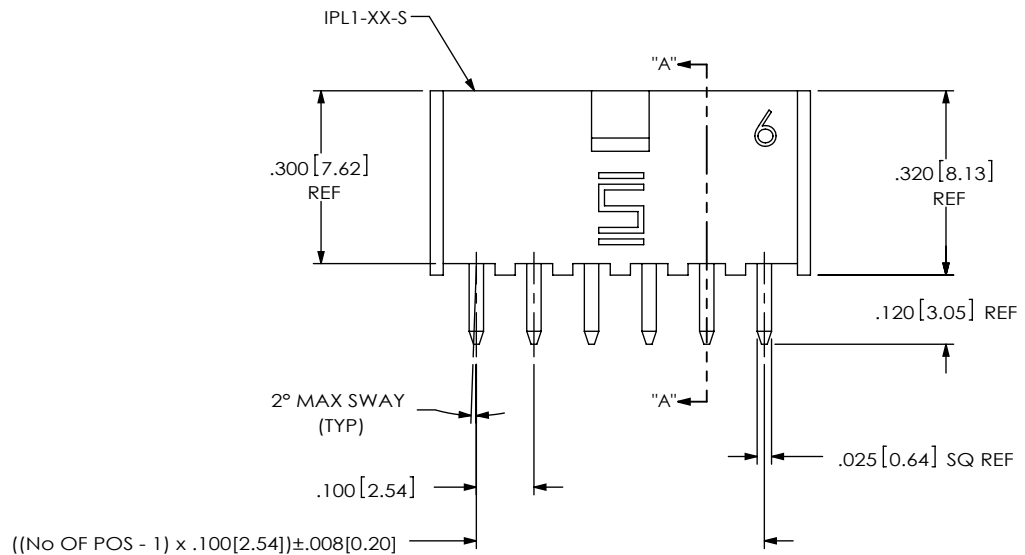

TABLE 1

LEAD STYLE	OPTION	TERMINAL 1	OAL REF	-TR
-01	NONE	T-1S64-07-XX	.430 [10.92]	N/A
-01	-RA	T-1S64-19-XX	.545 [13.84]	N/A
-02	NONE	T-1S64-08-XX	.445 [11.30]	K-DOT-.177-.281-.005

NOTES:

1. REPRESENTS A CRITICAL DIMENSION.
2. MINIMUM TERMINAL RETENTION: 1 LB [4.45 N].
3. PARTS TO BE MOLDED TO POSITION.
4. POST MUST BE WITHIN .005 [0.13] OF EACH OTHER.
5. ALL PIN TO PIN DIMENSIONS TO BE MEASURED FROM TIP TO TIP.
6. DIMENSION TO BE MEASURED AT BEND.
7. TIP TO BE FLUSH TO .015 [0.38] BELOW TOP OF SHROUD.
8. NOTE DELETED.
9. PACKAGE ALL POSITIONS.

CPC FREQUENCY THIS SHEET	A	C1, C2, C3, C5	UNLESS OTHERWISE SPECIFIED, DIMENSIONS ARE IN INCHES. TOLERANCES ARE: DECIMALS .XX: ±.01 [0.3] .XXX: ±.005 [0.13] .XXXX: ±.0020 [0.051]	PROPRIETARY NOTE THIS DOCUMENT CONTAINS INFORMATION CONFIDENTIAL AND PROPRIETARY TO SAMTEC, INC. AND SHALL NOT BE REPRODUCED OR TRANSFERRED TO OTHER DOCUMENTS OR DISCLOSED TO OTHERS OR USED FOR ANY PURPOSE OTHER THAN THAT WHICH IT WAS OBTAINED WITHOUT THE EXPRESSED WRITTEN CONSENT OF SAMTEC, INC.	 520 PARK EAST BLVD, NEW ALBANY, IN 47150 PHONE: 812-944-6733 FAX: 812-948-5047 e-Mail info@SAMTEC.com code 55322		
	B	C4				MATERIAL: DO NOT SCALE DRAWING SHEET SCALE: 3:1	DESCRIPTION: .100 [2.54] SINGLE ROW TERMINAL ASSEMBLY
	C					STANDARD INSULATOR: LCP UL94-V0, COLOR: BLACK -K INSULATOR: LCP UL94-V0, COLOR: NATURAL TERMINAL: PHOS BRONZE	DWG. NO. IPL1-1XX-XX-XXX-S-XX-X-XX
	D					F:\DWG\MISC\MKTG\IPL1-1XX-XX-XXX-S-XX-X-XX-MKT.SLDDRW	BY: D PURVIS 05/02/2005 SHEET 1 OF 3

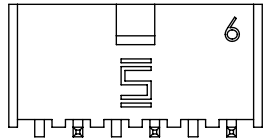
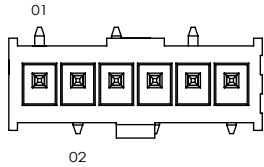
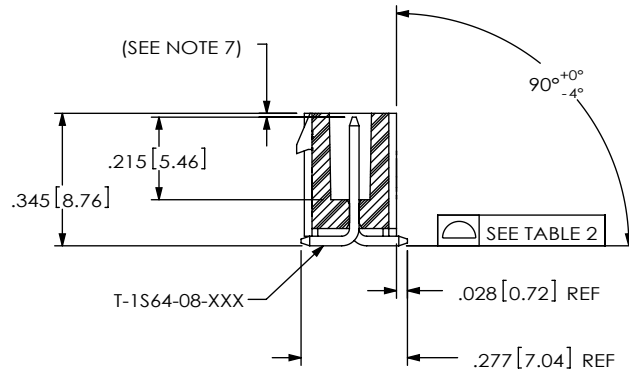

FIG 2
STYLE -02: SURFACE MOUNT
 IPL1-106-02-XXX-S SHOWN
 [DIFFERENT AS SHOWN, OTHERWISE SAME AS FIG 1]



-02: SURFACE MOUNT IN-PROCESS 1

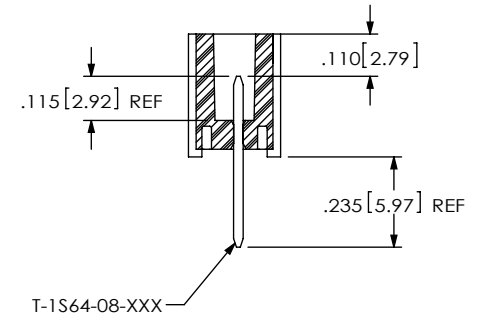
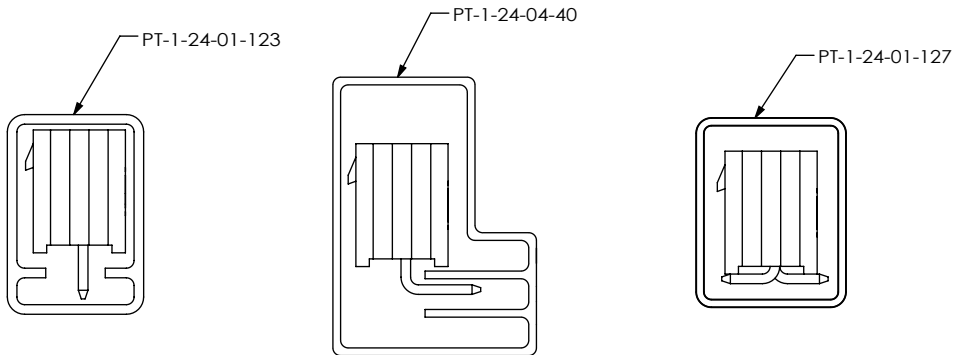

TABLE 2

No OF POS.	COPLANARITY
-02 THRU -05	.004[0.10]
-06 THRU -10	.005[0.13]

PACKAGING VIEWS
 (PARTS TO HAVE POSITION #1 LOADED
 IN SAME DIRECTION AS ARROW ON TUBE)



-02: SURFACE MOUNT IN-PROCESS 2

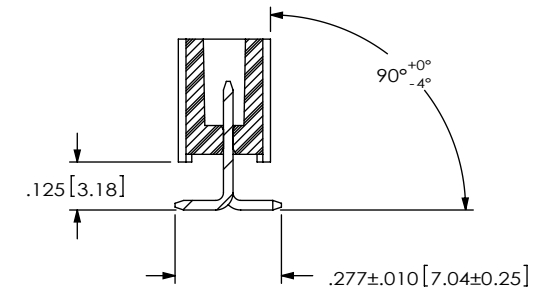

F:\DWG\MISC\MKTG\IPL1-1XX-XX-XXX-S-XX-X-XX-MKT.SLDDRW

PACKAGING TABLE			
LEAD STYLE	OPTION	PACKAGING TUBE	PLUG
-01	NONE	PT-1-24-01-123	TP-09
-01	-RA	PT-1-24-04-40	TP-07
-02	NONE	PT-1-24-01-127	TP-07

CPC FREQUENCY THIS SHEET	
A	
B	C6, C7, C10
C	
D	

PROPRIETARY NOTE
 THIS DOCUMENT CONTAINS INFORMATION CONFIDENTIAL AND PROPRIETARY TO SAMTEC, INC. AND SHALL NOT BE REPRODUCED OR TRANSFERRED TO OTHER DOCUMENTS OR DISCLOSED TO OTHERS OR USED FOR ANY PURPOSE OTHER THAN THAT WHICH IT WAS OBTAINED WITHOUT THE EXPRESSED WRITTEN CONSENT OF SAMTEC, INC.

DO NOT SCALE DRAWING

SHEET SCALE: 2:1



520 PARK EAST BLVD, NEW ALBANY, IN 47150
 PHONE: 812-944-6733 FAX: 812-948-5047
 e-Mail: info@SAMTEC.com code 55322

DESCRIPTION:
 .100[2.54] SINGLE ROW TERMINAL ASSEMBLY

DWG. NO.
IPL1-1XX-XX-XXX-S-XX-X-XX

BY: D PURVIS 05/02/2005 SHEET 2 OF 3

-RA: IN-PROCESS 1

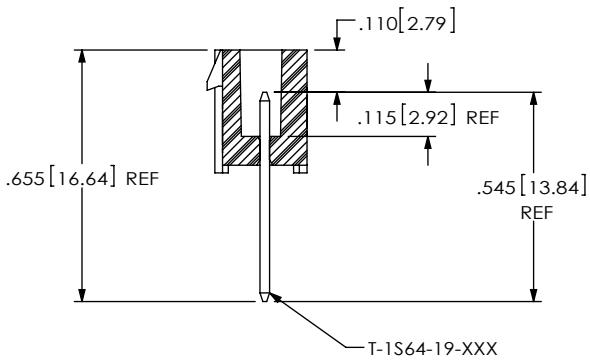

-RA: IN-PROCESS 2

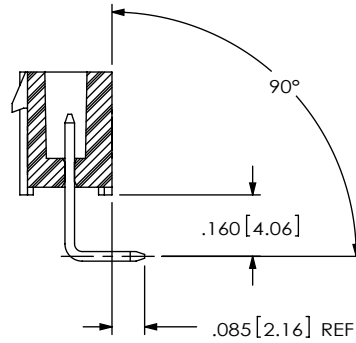

FIG 4

-K: KEYED POLARIZATION
(IPL1-106-01-XXX-S-K SHOWN)
(SAME AS FIG 1 UNLESS OTHERWISE STATED)

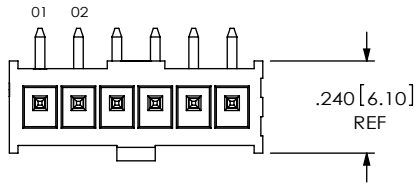
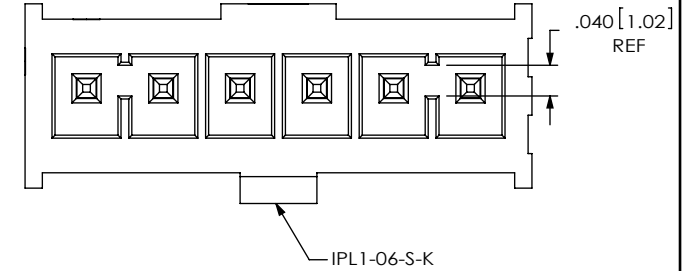
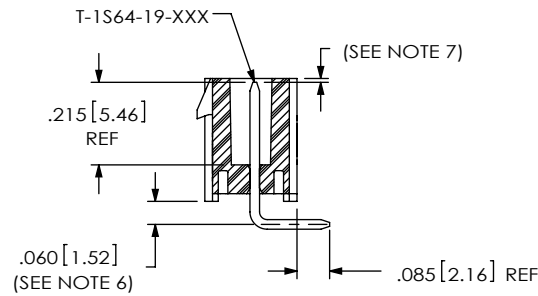
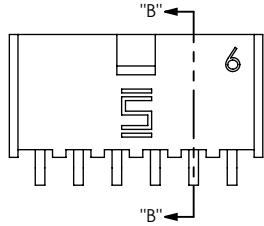

FIG 3

-RA: RIGHT ANGLE
IPL1-106-01-XXX-S-RA SHOWN
(DIFFERENT AS SHOWN, OTHERWISE SAME AS FIG 1)



SECTION "B"- "B"

FIG 5

(IPL1-106-02-XXX-S-TR SHOWN)
(MUST USE K-DOT-177-281-.005)
(SAME AS FIG 2, UNLESS OTHERWISE STATED)

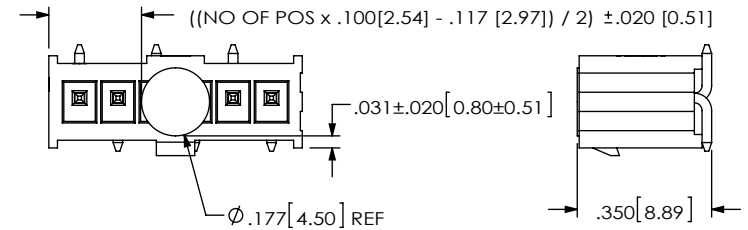

CPC
FREQUENCY
THIS SHEET

A	
B	C8, C9, C11
C	
D	

PROPRIETARY NOTE
THIS DOCUMENT CONTAINS INFORMATION
CONFIDENTIAL AND PROPRIETARY TO
SAMTEC, INC. AND SHALL NOT BE REPRODUCED
OR TRANSFERRED TO OTHER DOCUMENTS OR
DISCLOSED TO OTHERS OR USED FOR ANY
PURPOSE OTHER THAN THAT WHICH IT WAS
OBTAINED WITHOUT THE EXPRESSED WRITTEN
CONSENT OF SAMTEC, INC.

DO NOT SCALE DRAWING

SHEET SCALE: 2:1

samtec

520 PARK EAST BLVD, NEW ALBANY, IN 47150
PHONE: 812-944-6733 FAX: 812-948-5047
e-Mail: info@SAMTEC.com code 55322

DESCRIPTION:
.100 [2.54] SINGLE ROW TERMINAL ASSEMBLY

DWG. NO.
IPL1-1XX-XX-XXX-S-XX-X-XX

BY: D PURVIS 05/02/2005 SHEET 3 OF 3