

PART NO.	HRS NO.	CONTACTS	A	B	C	D	E
DF14A- 2P-1.25H(25)	CL538-0033-3-25	2	7.45	1.25	2.95	3.65	8.05
DF14A- 3P-1.25H(25)	CL538-0034-6-25	3	8.70	2.50	4.20	4.90	9.30
DF14A- 4P-1.25H(25)	CL538-0035-9-25	4	9.95	3.75	5.45	6.15	10.55
DF14A- 5P-1.25H(25)	CL538-0036-1-25	5	11.20	5.00	6.70	7.40	11.80
DF14A- 6P-1.25H(25)	CL538-0037-4-25	6	12.45	6.25	7.95	8.65	13.05
DF14A- 7P-1.25H(25)	CL538-0038-7-25	7	13.70	7.50	9.20	9.90	14.30
DF14A- 8P-1.25H(25)	CL538-0039-0-25	8	14.95	8.75	10.45	11.15	15.55
DF14A- 9P-1.25H(25)	CL538-0040-9-25	9	16.20	10.00	11.70	12.40	16.80
DF14A-10P-1.25H(25)	CL538-0041-1-25	10	17.45	11.25	12.95	13.65	18.05
DF14A-15P-1.25H(25)	CL538-0114-3-25	15	23.70	17.50	19.20	19.90	24.30
DF14A-20P-1.25H(25)	CL538-0119-7-25	20	29.95	23.75	25.45	26.15	30.55
DF14A-25P-1.25H(25)	CL538-0124-7-25	25	36.20	30.00	31.70	32.40	36.80
DF14A-30P-1.25H(25)	CL538-0045-2-25	30	42.45	36.25	37.95	38.65	43.05

NOTE 1. LEAD CO-PLANALITY INCLUDE REINFORCED METAL FITTINGS SHALL BE 0.1 MAX.  
 2 WHEN THIS CONNECTOR MATES WITH DF14-\*S-1.25C , THE MATTING LENGTH IS 7.3mm.  
 3 FOR CONNECTORS , 2 OR 3 CONTACTS , SIMPLIFIED LOCK HOLE SHALL BE SET AT THE CENTER OF HOUSING.

NO.	MATERIAL	FINISH .	REMARKS	NO.	MATERIAL	FINISH .	REMARKS
3	PHOSPHOR BRONZE	TIN-COPPER PLATED 1#m min UNDER PLATING:NICKEL PLATED 0.5#m min		5	S. PVC		
2	BRASS	TIN-COPPER PLATED 1#m min UNDER PLATING:NICKEL PLATED 0.5#m min		4	RIGID VINYLCHLORIDE		ELECTROSTATIC PROTECTION
1	POLYAMIDE	BEIGE . UL94V-0					

UNITS	SCALE	COUNT	DESCRIPTION OF REVISIONS	DESIGNED	CHECKED	DATE
mm	5 : 1	2	DIS-H-008680	MI. SAKIMURA	TS. FUKUSHIMA	14. 04. 11

APPROVED	DATE	DRAWING NO.
:KJ. KATAYOSE	05. 01. 05	EDC3-160309-16
CHECKED	DATE	PART NO.
:TY. OMA	05. 01. 05	DF14A-*P-1.25H(25)
DESIGNED	DATE	CODE NO.
:TS. KUMAZAWA	05. 01. 05	CL538-
DRAWN	DATE	
:TS. KUMAZAWA	05. 01. 05	

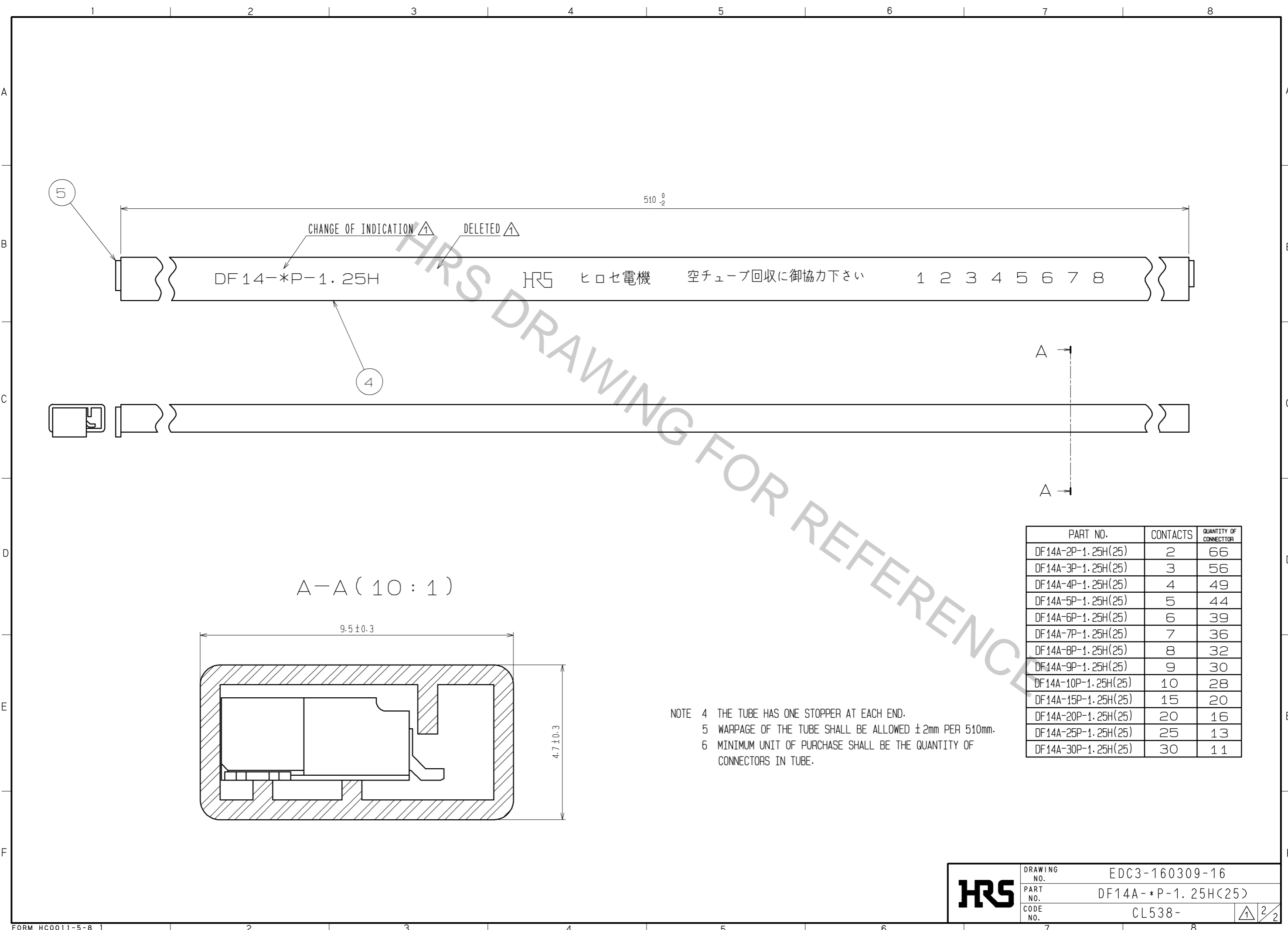

510  $\begin{smallmatrix} 0 \\ -2 \end{smallmatrix}$

CHANGE OF INDICATION  $\triangle$

DELETED  $\triangle$

DF 14-\*P-1.25H

HRS ヒロセ電機

空チューブ回収に御協力下さい

1 2 3 4 5 6 7 8

A-A (10:1)

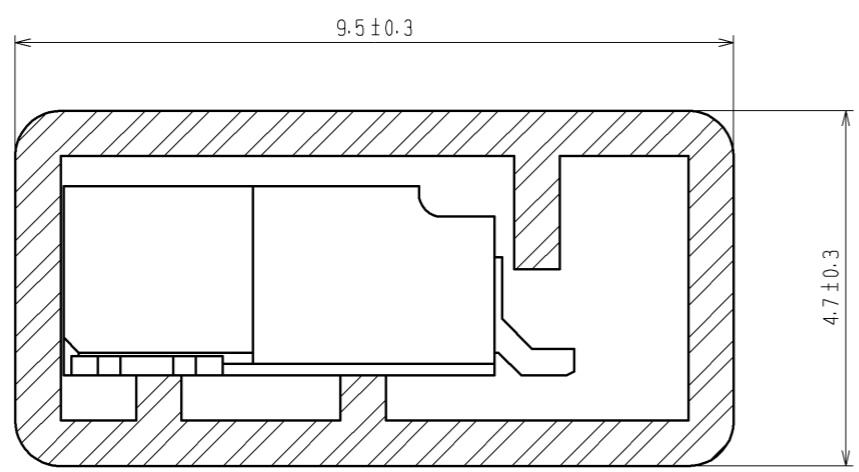

PART NO.	CONTACTS	QUANTITY OF CONNECTOR
DF14A-2P-1.25H(25)	2	66
DF14A-3P-1.25H(25)	3	56
DF14A-4P-1.25H(25)	4	49
DF14A-5P-1.25H(25)	5	44
DF14A-6P-1.25H(25)	6	39
DF14A-7P-1.25H(25)	7	36
DF14A-8P-1.25H(25)	8	32
DF14A-9P-1.25H(25)	9	30
DF14A-10P-1.25H(25)	10	28
DF14A-15P-1.25H(25)	15	20
DF14A-20P-1.25H(25)	20	16
DF14A-25P-1.25H(25)	25	13
DF14A-30P-1.25H(25)	30	11

NOTE 4 THE TUBE HAS ONE STOPPER AT EACH END.  
 5 WARPAGE OF THE TUBE SHALL BE ALLOWED  $\pm 2$ mm PER 510mm.  
 6 MINIMUM UNIT OF PURCHASE SHALL BE THE QUANTITY OF CONNECTORS IN TUBE.

<b>HRS</b>	DRAWING NO.	EDC3-160309-16
	PART NO.	DF14A-*P-1.25H(25)
	CODE NO.	CL538-
		$\triangle$ 2/2