

- NOTE 1. THIS PRODUCT IS DELIVERED SEPARATELY.  
 2 AS SHOWN IN THE FIGURE, THIS PRODUCT SHALL BE USED ASSEMBLED TO A CONNECTOR UNIT 'DH3+B-27S'. A CLAMP 'DH-27-CMB(\*\*\*)' IS NEEDED WHEN ASSEMBLING THE UNIT.  
 3 THIS PRODUCT SHALL BE MATED WITH A RECEPTACLE 'DH60-27P\*' WHICH ASSEMBLED LOCK SCREWS 'DH-LNA\*\*\*'.  
 4 A RECOMMENDED SCREW TIGHTENING TORQUE TO THE LOCK SCREWS TO BE FROM 0.06 TO 0.07 N · m.  
 5 A RECOMMENDED SCREW TIGHTENING TORQUE FOR COVERS TO BE FROM 0.1 TO 0.15 N · m.

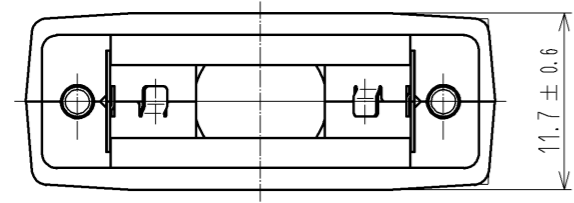

3	STAINLESS STEEL	PLATING : NICKEL 0.1 μm MIN	5	STEEL	TRIVALENT BLACK CHROMATE
2	PC	UL94V-O (BLACK)	4	STEEL	OVER PLATING : NICKEL 2 μm MIN
1					UNDER PLATING : COPPER 1 μm MIN
NO.	MATERIAL	FINISH . REMARKS	NO.	MATERIAL	FINISH . REMARKS
UNITS mm		SCALE 4 : 1	COUNT △	DESCRIPTION OF REVISIONS	
DESIGNED		CHECKED		DATE	
APPROVED : KN. ICHIKAWA 09.11.17			DRAWING NO. EDC3-126587-00		
CHECKED : KN. ICHIKAWA 09.11.17			PART NO. DH-27-CV1B		
DESIGNED : MO. SHIMOYAMA 09.11.17			CODE NO. CL244-0010-5-00		
DRAWN : TM. ONO 09.11.16			△ 1/2		

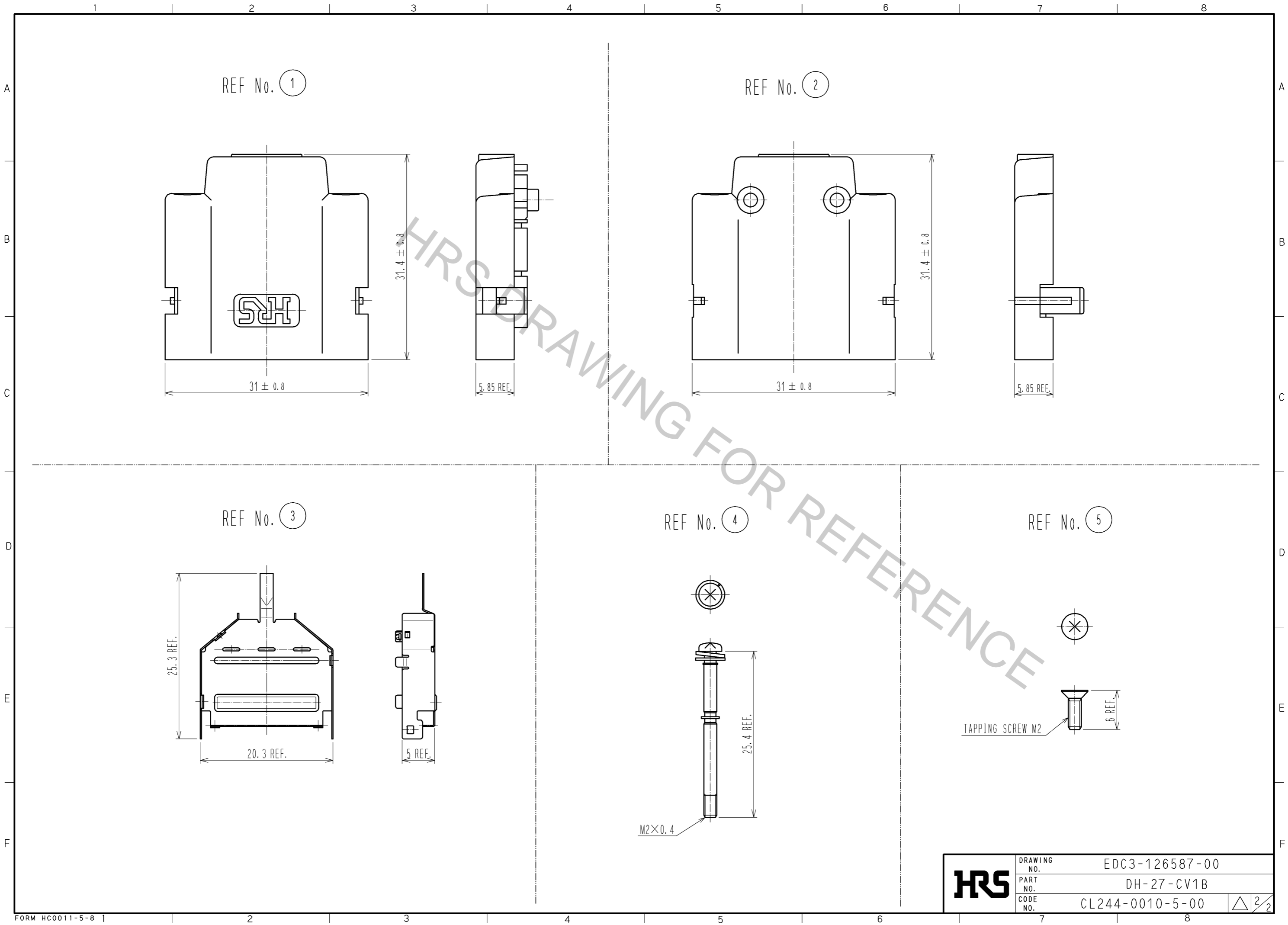

REF No. ①

REF No. ②

REF No. ③

REF No. ④

REF No. ⑤

<b>HRS</b>	DRAWING NO.	EDC3-126587-00	△ 2/2
	PART NO.	DH-27-CV1B	
	CODE NO.	CL244-0010-5-00	