

DETAIL OF FORCE-FIT PEGS

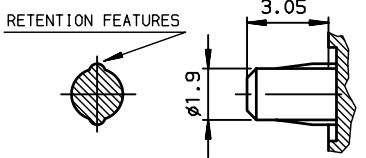

LAYOUT FOR P.C.B (PER 12mm LENGTH)

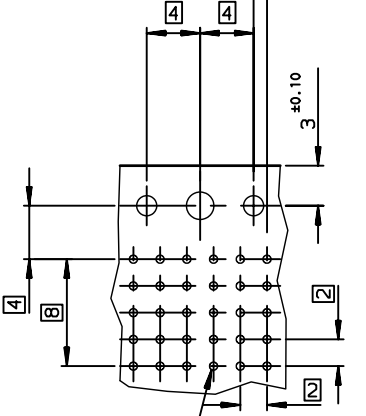

Hole according to product spec: GS-12-445 (for press-fit), GS-12-446 (for STB)

TIN LEAD PART NUMBER

Part Number: HM1L54xyP000Hz / 000H6									
MATING LENGTH DIM-P / REPLACE 'x' BY:									
	ROW-A	ROW-B	ROW-C	ROW-D	ROW-E				
A =	5.00	5.00	5.00	5.00	5.00				
L =	5.75	5.75	5.75	5.75	5.75				
D =	6.50	6.50	6.50	6.50	6.50				
B =	6.50	5.00	5.00	5.00	5.00				
C =	6.50	5.75	5.75	6.50	5.75				
TERMINATION LENGTH						D=2.90 ± 0.3, replace y by A			
DIM-D						D=3.70 ± 0.3, replace y by B			

LEAD-FREE PART NUMBER

Part Number: HM1L54xyP000HzLF/000H6LF									
MATING LENGTH DIM-P / REPLACE 'x' BY:									
	ROW-A	ROW-B	ROW-C	ROW-D	ROW-E				
A =	5.00	5.00	5.00	5.00	5.00				
L =	5.75	5.75	5.75	5.75	5.75				
D =	6.50	6.50	6.50	6.50	6.50				
B =	6.50	5.00	5.00	5.00	5.00				
C =	6.50	5.75	5.75	6.50	5.75				
TERMINATION LENGTH						D=2.90 ± 0.3, replace y by A			
DIM-D						D=3.70 ± 0.3, replace y by B			

GENERAL CHARACTERISTICS AND ROHS INFORMATIONS:

SEE PRODUCT SPECIFICATION GS-12-446

- NOTE-2: INSERTION IN PCB, HANDLING OR BENCH PRESS
- NOTE-3: IF SUFFIX "P" IS ADDED IN P/N PACKAGING IS IN TRAYS BUT CONNECTOR MARKING IS WITHOUT "P"
EXAMPLE: HM1XXXXXXXXXH6P, MARKED HM1XXXXXXXXXH6
- NOTE-4: REAR CENTRAL SUPPORT FOR BETTER ASSY ON PCB

www.fciconnect.com		surface ISO 1302	tolerance std ISO 406 ISO 1101	projection	mm
TOLERANCES UNLESS OTHERWISE SPECIFIED				size A2	Scale 2.5
Dr	CHAMPION	1997/06/17	ANGULAR	0.X	± 0.1
Eng	LENOIR	1997/06/17	LINEAR	0.XX	± 0.1
Chr	LEGARE	1997/06/17	0.XX ± 2	0.XXX	± 0.1
Appr	LEGARE	1997/06/17	Product family	METRAL	Spec ref -
rev	ecn no	dr	date		
C	-	MAS	2000/08/31		
D	LS05-001	MLE	2005/03/15		
E	LS06-0095	LGO	2006/07/10		
F	LS07-0184	MLE	2007/07/24		
FCI title			METRAL RA HEADER 5 ROW		
catalog no			STANDARD SOLDER 240 WAY		
dwg no			C-8626-0242		
customer			sheet 1 of 1		