

PRODUCT NUMBER	PITCH
Klxx50x100J0G	5.08 mm

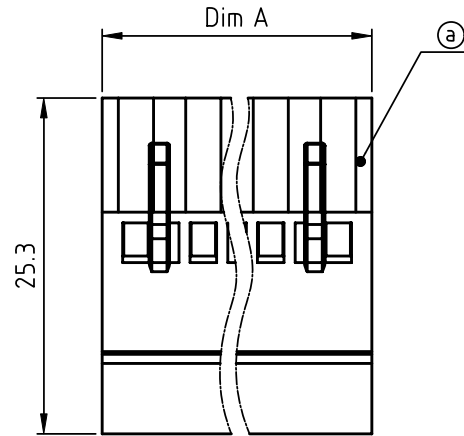
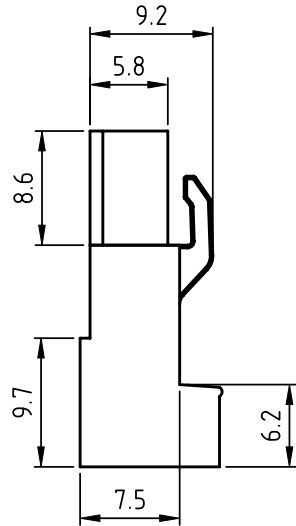
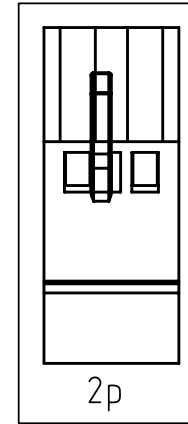
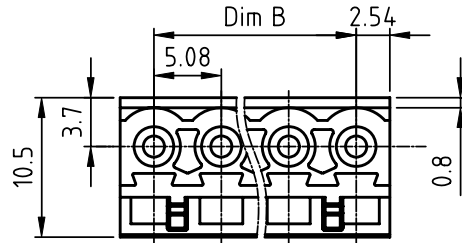

Material:

- Item@Terminal housing:Thermoplastic (UL94 V-0)

Electrical cULus

- Voltage rating: 300V
- Current rating: 10A
- Wire range: 0.5-1.0mm<sup>2</sup>/1.5-2.5mm<sup>2</sup>
- Withstanding Voltage: 1.6KV
- Corresponding female crimp contacts:A0 5.08 series

N = Number of poles  
 Dim A=Nx5.08  
 Dim B=(N-1)x5.08

Poles	Dim A	Dim B
2-6p	±0.20	±0.20
7-12p	±0.25	±0.25
13-16p	±0.30	±0.30
17-24p	±0.40	±0.35

PART NO.: **KI xx 50 x 1 00J0 G**

		Color	RoHS compliant (lead<4%) In copper Alloy
Solid block	0	Black (RAL9005)	
No. of poles	2	Red (RAL3001/D)	
02 2 poles	3	Orange(RAL2011/P)	
03 3 poles	4	Yellow(RAL1018/A)	
...	...	5 Green(RAL6018/T)	
24 24 poles	6	Blue (RAL5015/A)	
	8	Grey(RAL7035/D)	
	9	White(RAL1102)	
	C	Green(RAL6018/U)	

mat'l. code		surface ASME Y14.5 ✓	tolerance ASME Y14.5	projection	product family	
ltr ecn no dr date		tolerances unless otherwise specified		MM	TERMINAL BLOCK	
		angles	X.±0.5	scale	title	
		X'±1"	X.X±0.3			
			X.XX±0.1		TERMINAL BLOCK PLUGGABLE PLUG, CRIMP CONNECTION WITH HIGH PROFILE	
		dr	EVIN ZHONG 050414	FCI	dwg no	
		enr	EVIN ZHONG 050414		sheet 1 of 1	size
		chr	HANKE FENG 050414		Klxx50x100J0G	A4
		appd	SHI JUN 050414		type	CUSTOMER Drawing
sheet index	revision sheet	A	1			