

PRODUCT NUMBER	PITCH
VQxx31x100J0G	3.81mm

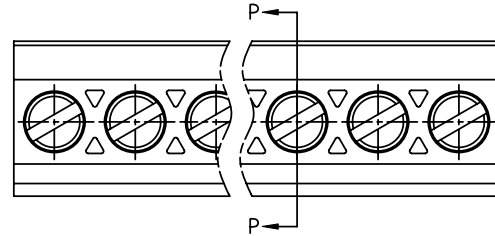

Diameter of metal-plated hole:  $\phi 1.0 \pm 0.05$

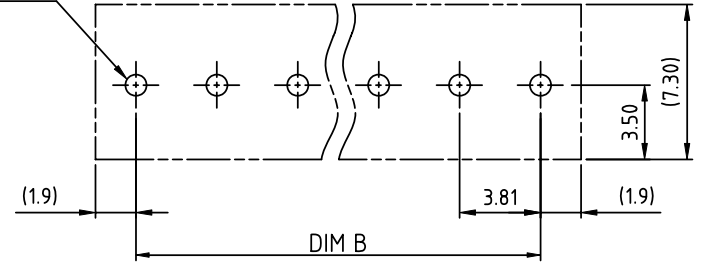

RECOMMENDED P.C.B LAYOUT  
TOP VIEW

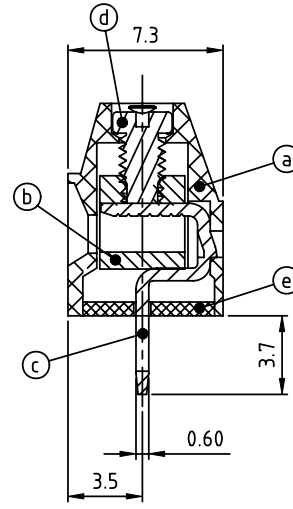
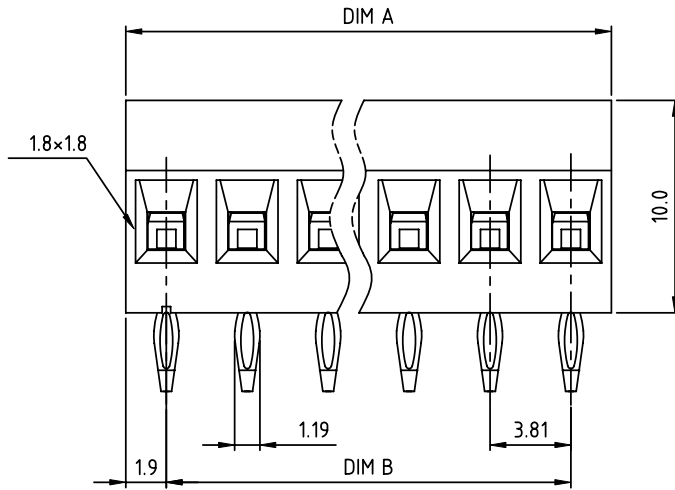

SECTION P-P

Material:

- Item ① Terminal housing : Thermoplastic (UL 94V-0)
- Item ② Clamp : Brass, Ni plated
- Item ③ solder pin : Brass, Tin plated
- Item ④ Terminal screw: Steel Zinc plating"-slot type
- Item ⑤ Terminal housing (cover): Thermoplastic (UL 94V-0)

Electrical:

- Voltage rating: 300V
- Current rating: 10A
- Wire range:
- Solid wire(AWG): 16-30
- Stranded wire(AWG): 16-30
- Torque: 1.7 Lb-In
- Diameter of metal - plated hole :  $\phi 1.0$
- Screw: M2
- Wire strip length: 5-6mm
- Withstanding Voltage: 1.6 KV
- Operating temperature: -40°C to +115°C
- Soldering temperature: 260°C $\pm$ 5°C/5 Sec
- Safety Approval:

N= Number of poles

DIM A	Nx3.81
DIM B	(N-1)x3.81

Poles	Tolerance
2p-6p	$\pm 0.15$
7p-12p	$\pm 0.25$
13p-19p	$\pm 0.35$
20p-24p	$\pm 0.40$

PART NO.: VQ xx 3 1 x 1 00J0 G

- |              |          |                     |  |
|--------------|----------|---------------------|--|
| Solid Block  | 0        | Black (RAL9005)     | RoHS compliant<br>(lead<4%)<br>In copper Alloy |
| No. of poles | 2        | Red (RAL3001/D)     |  |
| 02           | 2 poles  | 3 Orange(RAL2011/P) |  |
| 03           | 3 poles  | 4 Yellow(RAL1018/A) |  |
| ...          | ...      | 5 Green(RAL6018/T)  |  |
| 24           | 24 poles | 6 Blue (RAL5015/A)  |  |
|              |          | 8 Grey(RAL7035/D)   |  |
|              |          | 9 White(RAL1102)    |  |
|              |          | C Green(RAL6018/U)  |  |

mat'l. code		surface ASME Y14.5	tolerance ASME Y14.5	projection	product family TERMINAL BLOCK		
ltr	ecn no	dr	date	 MM	title TERMINAL BLOCK RISING CLAMP, 180D WIRE INLET, PRESS FIT		
tolerances unless otherwise specified						scale	
angles		X. $\pm$ 0.5			dwg no VQxx31x100J0G		
X $\pm$ 1°		X.XX $\pm$ 0.1					
dr	EVIN ZHONG	040714				sheet 1 of 1	size A4
enr	EVIN ZHONG	040714				type CUSTOMER Drawing	
chr	HANKE FENG	040714					
appd	SHI JUN	040714					
sheet index	revision sheet	A	1				