

13

12

11

10

9

8

7

6

5

4

3

2

1

0.50MM CENTER GOLD (Au) FFC JUMPER CABLE CHART

| "A" DIM.  | 1.18 ± .079 INCHES<br>30 ± 2.00 |           | 2 ± .079 INCHES<br>51 ± 2.00 MM |           | 3 ± .118 INCHES<br>76 ± 3.00 MM |           | 4 ± .118 INCHES<br>102 ± 3.00 MM |           | 5 ± .157 INCHES<br>127 ± 4.00 MM |           | 6 ± .157 INCHES<br>152 ± 4.00 MM |           | 7 ± .157 INCHES<br>178 ± 4.00 MM |           | 8 ± .157 INCHES<br>203 ± 4.00 MM |           | 9 ± .197 INCHES<br>229 ± 5.00 MM |           | 10 ± .197 INCHES<br>254 ± 5.00 MM |           | 12 ± .197 INCHES<br>305 ± 5.00 MM |           |
|-----------|---------------------------------|-----------|---------------------------------|-----------|---------------------------------|-----------|----------------------------------|-----------|----------------------------------|-----------|----------------------------------|-----------|----------------------------------|-----------|----------------------------------|-----------|----------------------------------|-----------|-----------------------------------|-----------|-----------------------------------|-----------|
| STIFFENER | TYPE "A"                        | TYPE "D"  | TYPE "A"                        | TYPE "D"  | TYPE "A"                        | TYPE "D"  | TYPE "A"                         | TYPE "D"  | TYPE "A"                         | TYPE "D"  | TYPE "A"                         | TYPE "D"  | TYPE "A"                         | TYPE "D"  | TYPE "A"                         | TYPE "D"  | TYPE "A"                         | TYPE "D"  | TYPE "A"                          | TYPE "D"  | TYPE "A"                          | TYPE "D"  |
| CKTS: 6   | 150200051                       | 150200052 | 150200053                       | 150200054 | 150200055                       | 150200056 | 150200057                        | 150200058 | 150200059                        | 150200060 | 150200061                        | 150200062 | 150200063                        | 150200064 | 150200065                        | 150200066 | 150200067                        | 150200068 | 150200069                         | 150200070 | 150200071                         | 150200072 |
| CKTS: 8   | 150200073                       | 150200074 | 150200075                       | 150200076 | 150200077                       | 150200078 | 150200079                        | 150200080 | 150200081                        | 150200082 | 150200083                        | 150200084 | 150200085                        | 150200086 | 150200087                        | 150200088 | 150200089                        | 150200090 | 150200091                         | 150200092 | 150200093                         | 150200094 |
| CKTS: 10  | 150200095                       | 150200096 | 150200097                       | 150200098 | 150200099                       | 150200100 | 150200101                        | 150200102 | 150200103                        | 150200104 | 150200105                        | 150200106 | 150200107                        | 150200108 | 150200109                        | 150200110 | 150200111                        | 150200112 | 150200113                         | 150200114 | 150200115                         | 150200116 |
| CKTS: 12  | 150200117                       | 150200118 | 150200119                       | 150200120 | 150200121                       | 150200122 | 150200123                        | 150200124 | 150200125                        | 150200126 | 150200127                        | 150200128 | 150200129                        | 150200130 | 150200131                        | 150200132 | 150200133                        | 150200134 | 150200135                         | 150200136 | 150200137                         | 150200138 |
| CKTS: 14  | 150200139                       | 150200140 | 150200141                       | 150200142 | 150200143                       | 150200144 | 150200145                        | 150200146 | 150200147                        | 150200148 | 150200149                        | 150200150 | 150200151                        | 150200152 | 150200153                        | 150200154 | 150200155                        | 150200156 | 150200157                         | 150200158 | 150200159                         | 150200160 |
| CKTS: 16  | 150200161                       | 150200162 | 150200163                       | 150200164 | 150200165                       | 150200166 | 150200167                        | 150200168 | 150200169                        | 150200170 | 150200171                        | 150200172 | 150200173                        | 150200174 | 150200175                        | 150200176 | 150200177                        | 150200178 | 150200179                         | 150200180 | 150200181                         | 150200182 |
| CKTS: 18  | 150200183                       | 150200184 | 150200185                       | 150200186 | 150200187                       | 150200188 | 150200189                        | 150200190 | 150200191                        | 150200192 | 150200193                        | 150200194 | 150200195                        | 150200196 | 150200197                        | 150200198 | 150200199                        | 150200200 | 150200201                         | 150200202 | 150200203                         | 150200204 |
| CKTS: 20  | 150200205                       | 150200206 | 150200207                       | 150200208 | 150200209                       | 150200210 | 150200211                        | 150200212 | 150200213                        | 150200214 | 150200215                        | 150200216 | 150200217                        | 150200218 | 150200219                        | 150200220 | 150200221                        | 150200222 | 150200223                         | 150200224 | 150200225                         | 150200226 |
| CKTS: 22  | 150200227                       | 150200228 | 150200229                       | 150200230 | 150200231                       | 150200232 | 150200233                        | 150200234 | 150200235                        | 150200236 | 150200237                        | 150200238 | 150200239                        | 150200240 | 150200241                        | 150200242 | 150200243                        | 150200244 | 150200245                         | 150200246 | 150200247                         | 150200248 |
| CKTS: 24  | 150200249                       | 150200250 | 150200251                       | 150200252 | 150200253                       | 150200254 | 150200255                        | 150200256 | 150200257                        | 150200258 | 150200259                        | 150200260 | 150200261                        | 150200262 | 150200263                        | 150200264 | 150200265                        | 150200266 | 150200267                         | 150200268 | 150200269                         | 150200270 |
| CKTS: 26  | 150200271                       | 150200272 | 150200273                       | 150200274 | 150200275                       | 150200276 | 150200277                        | 150200278 | 150200279                        | 150200280 | 150200281                        | 150200282 | 150200283                        | 150200284 | 150200285                        | 150200286 | 150200287                        | 150200288 | 150200289                         | 150200290 | 150200291                         | 150200292 |
| CKTS: 28  | 150200293                       | 150200294 | 150200295                       | 150200296 | 150200297                       | 150200298 | 150200299                        | 150200300 | 150200301                        | 150200302 | 150200303                        | 150200304 | 150200305                        | 150200306 | 150200307                        | 150200308 | 150200309                        | 150200310 | 150200311                         | 150200312 | 150200313                         | 150200314 |
| CKTS: 30  | 150200315                       | 150200316 | 150200317                       | 150200318 | 150200319                       | 150200320 | 150200321                        | 150200322 | 150200323                        | 150200324 | 150200325                        | 150200326 | 150200327                        | 150200328 | 150200329                        | 150200330 | 150200331                        | 150200332 | 150200333                         | 150200334 | 150200335                         | 150200336 |
| CKTS: 32  | 150200337                       | 150200338 | 150200339                       | 150200340 | 150200341                       | 150200342 | 150200343                        | 150200344 | 150200345                        | 150200346 | 150200347                        | 150200348 | 150200349                        | 150200350 | 150200351                        | 150200352 | 150200353                        | 150200354 | 150200355                         | 150200356 | 150200357                         | 150200358 |
| CKTS: 34  | 150200359                       | 150200360 | 150200361                       | 150200362 | 150200363                       | 150200364 | 150200365                        | 150200366 | 150200367                        | 150200368 | 150200369                        | 150200370 | 150200371                        | 150200372 | 150200373                        | 150200374 | 150200375                        | 150200376 | 150200377                         | 150200378 | 150200379                         | 150200380 |
| CKTS: 36  | 150200381                       | 150200382 | 150200383                       | 150200384 | 150200385                       | 150200386 | 150200387                        | 150200388 | 150200389                        | 150200390 | 150200391                        | 150200392 | 150200393                        | 150200394 | 150200395                        | 150200396 | 150200397                        | 150200398 | 150200399                         | 150200400 | 150200401                         | 150200402 |
| CKTS: 38  | 150200403                       | 150200404 | 150200405                       | 150200406 | 150200407                       | 150200408 | 150200409                        | 150200410 | 150200411                        | 150200412 | 150200413                        | 150200414 | 150200415                        | 150200416 | 150200417                        | 150200418 | 150200419                        | 150200420 | 150200421                         | 150200422 | 150200423                         | 150200424 |
| CKTS: 40  | 150200425                       | 150200426 | 150200427                       | 150200428 | 150200429                       | 150200430 | 150200431                        | 150200432 | 150200433                        | 150200434 | 150200435                        | 150200436 | 150200437                        | 150200438 | 150200439                        | 150200440 | 150200441                        | 150200442 | 150200443                         | 150200444 | 150200445                         | 150200446 |
| CKTS: 42  | 150200447                       | 150200448 | 150200449                       | 150200450 | 150200451                       | 150200452 | 150200453                        | 150200454 | 150200455                        | 150200456 | 150200457                        | 150200458 | 150200459                        | 150200460 | 150200461                        | 150200462 | 150200463                        | 150200464 | 150200465                         | 150200466 | 150200467                         | 150200468 |
| CKTS: 44  | 150200469                       | 150200470 | 150200471                       | 150200472 | 150200473                       | 150200474 | 150200475                        | 150200476 | 150200477                        | 150200478 | 150200479                        | 150200480 | 150200481                        | 150200482 | 150200483                        | 150200484 | 150200485                        | 150200486 | 150200487                         | 150200488 | 150200489                         | 150200490 |
| CKTS: 46  | 150200491                       | 150200492 | 150200493                       | 150200494 | 150200495                       | 150200496 | 150200497                        | 150200498 | 150200499                        | 150200500 | 150200501                        | 150200502 | 150200503                        | 150200504 | 150200505                        | 150200506 | 150200507                        | 150200508 | 150200509                         | 150200510 | 150200511                         | 150200512 |
| CKTS: 48  | 150200513                       | 150200514 | 150200515                       | 150200516 | 150200517                       | 150200518 | 150200519                        | 150200520 | 150200521                        | 150200522 | 150200523                        | 150200524 | 150200525                        | 150200526 | 150200527                        | 150200528 | 150200529                        | 150200530 | 150200531                         | 150200532 | 150200533                         | 150200534 |
| CKTS: 50  | 150200535                       | 150200536 | 150200537                       | 150200538 | 150200539                       | 150200540 | 150200541                        | 150200542 | 150200543                        | 150200544 | 150200545                        | 150200546 | 150200547                        | 150200548 | 150200549                        | 150200550 | 150200551                        | 150200552 | 150200553                         | 150200554 | 150200555                         | 150200556 |

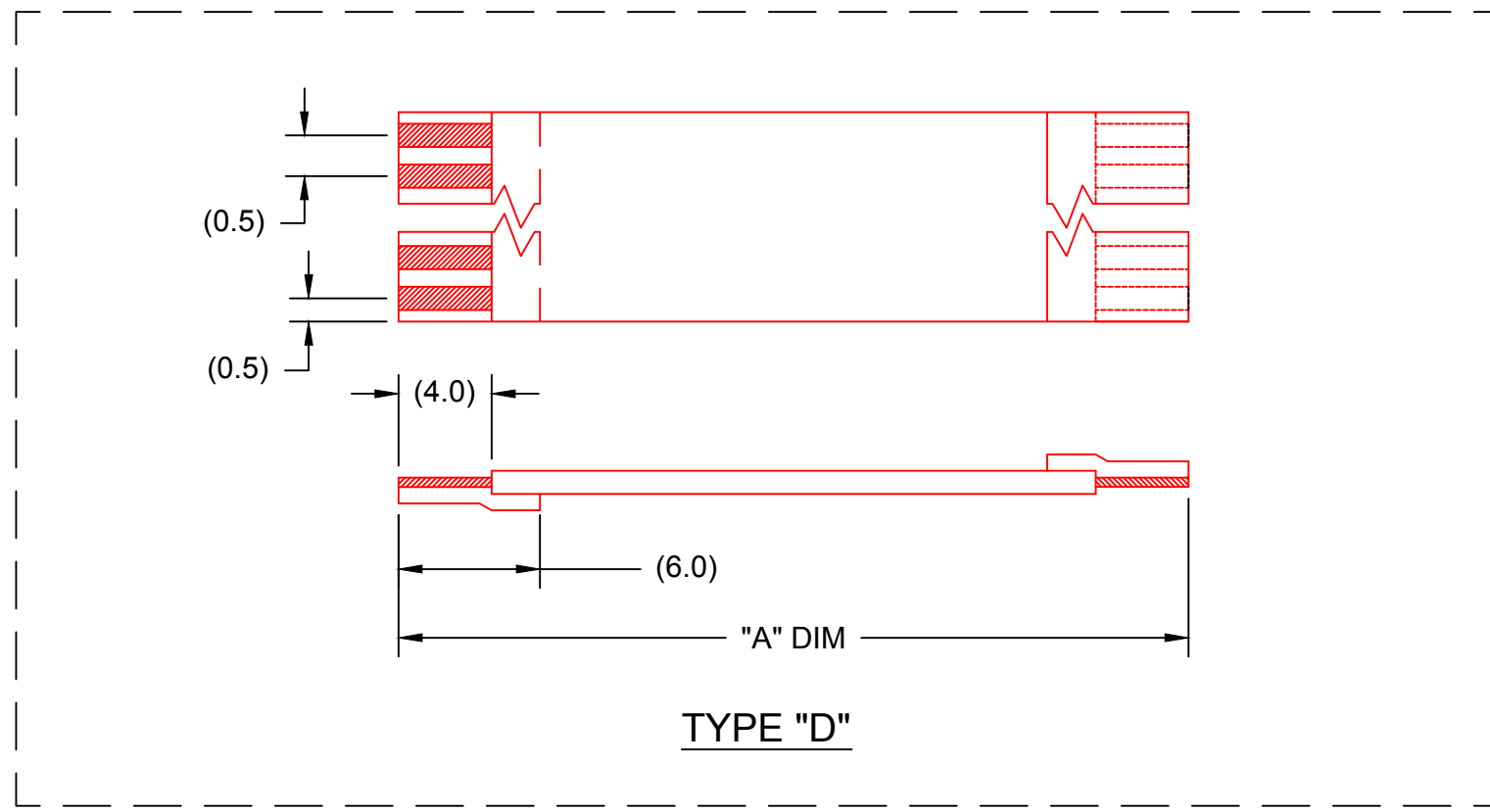
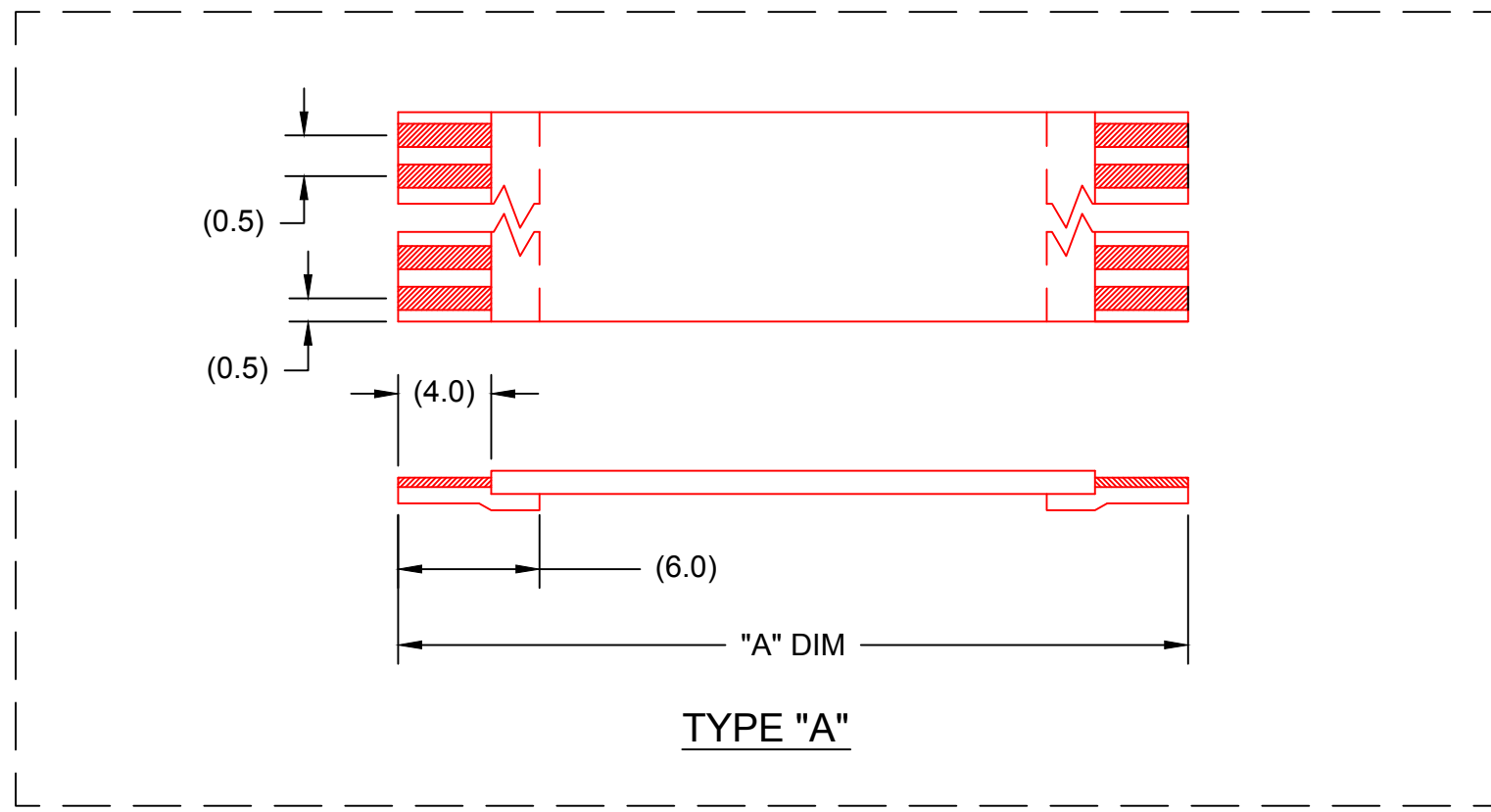

**NOTES:**  
 1. NO PRINTING ON JUMPER CABLE UNLESS OTHERWISE SPECIFIED. IF PRINTING IS REQUIRED, THEN IT WOULD BE CONSIDERED A SPECIAL JUMPER CABLE.

|  |   |              |                |                                       |   |             |              |   |
|--|---|--------------|----------------|---------------------------------------|---|-------------|--------------|---|
| REINFORCEMENT LENGTH WAS (8.0)                       | EC NO: USW2012-0098<br>DRWN: MFI 2011/09/29 | DESCRIPTION  | QUALITY SYMBOL | GENERAL TOLERANCES (UNLESS SPECIFIED) | DIMENSION STYLE   | SCALE       | DESIGN UNITS | THIRD ANGLE PROJECTION                    |
|  |   |              | ▽=0<br>▽C=0    | mm INCH                               | MM  | ---         | METRIC       |   |
| 2  | REV   | MATERIAL NO. | 4 PLACES       | ±---                                  | ±---  | DRAWN BY    | DATE         | TITLE                                     |
|  |   |              | 3 PLACES       | ±---                                  | ±---  | CHECKED BY  | DATE         | 0.50MM CENTER FFC JUMPER CABLE AU PLATING |
|  |   |              | 2 PLACES       | ±---                                  | ±---  | APPROVED BY | DATE         |   |
|  |   |              | 1 PLACE        | ±---                                  | ±---  | DRASMUSS    | 2010/11/30   | DOCUMENT NO.                              |
| DRAFT WHERE APPLICABLE MUST REMAIN WITHIN DIMENSIONS |   |              | ANGULAR ±1/2°  | SEE CHART                             | THIS DRAWING CONTAINS INFORMATION THAT IS PROPRIETARY TO MOLEX INCORPORATED AND SHOULD NOT BE USED WITHOUT WRITTEN PERMISSION |             |              |   |

13

12

11

10

9

8

7

6

5

4

3

2

1

# 0.50MM CENTER GOLD (Au) FFC JUMPER CABLE CHART

| "A" DIM.  | 1.18 ± .079 INCHES<br>30 ± 2.00 |           | 2 ± .079 INCHES<br>51 ± 2.00 MM |           | 3 ± .118 INCHES<br>76 ± 3.00 MM |           | 4 ± .118 INCHES<br>102 ± 3.00 MM |           | 5 ± .157 INCHES<br>127 ± 4.00 MM |           | 6 ± .157 INCHES<br>152 ± 4.00 MM |           | 7 ± .157 INCHES<br>178 ± 4.00 MM |           | 8 ± .157 INCHES<br>203 ± 4.00 MM |           | 9 ± .197 INCHES<br>229 ± 5.00 MM |           | 10 ± .197 INCHES<br>254 ± 5.00 MM |           | 12 ± .197 INCHES<br>305 ± 5.00 MM |           |
|-----------|---------------------------------|-----------|---------------------------------|-----------|---------------------------------|-----------|----------------------------------|-----------|----------------------------------|-----------|----------------------------------|-----------|----------------------------------|-----------|----------------------------------|-----------|----------------------------------|-----------|-----------------------------------|-----------|-----------------------------------|-----------|
| STIFFENER | TYPE "D"                        | TYPE "A"  | TYPE "D"                        | TYPE "A"  | TYPE "D"                        | TYPE "A"  | TYPE "D"                         | TYPE "A"  | TYPE "D"                         | TYPE "A"  | TYPE "D"                         | TYPE "A"  | TYPE "D"                         | TYPE "A"  | TYPE "D"                         | TYPE "A"  | TYPE "D"                         | TYPE "A"  | TYPE "D"                          | TYPE "A"  | TYPE "D"                          | TYPE "A"  |
| CKTS: 7   | 150200744                       | 150200745 | 150200746                       | 150200747 | 150200748                       | 150200749 | 150200750                        | 150200751 | 150200752                        | 150200753 | 150200754                        | 150200755 | 150200756                        | 150200757 | 150200758                        | 150200759 | 150200760                        | 150200761 | 150200762                         | 150200763 | 150200764                         | 150200765 |
| CKTS: 9   | 150200766                       | 150200767 | 150200768                       | 150200769 | 150200770                       | 150200771 | 150200772                        | 150200773 | 150200774                        | 150200775 | 150200776                        | 150200777 | 150200778                        | 150200779 | 150200780                        | 150200781 | 150200782                        | 150200783 | 150200784                         | 150200785 | 150200786                         | 150200787 |
| CKTS: 11  | 150200788                       | 150200789 | 150200790                       | 150200791 | 150200792                       | 150200793 | 150200794                        | 150200795 | 150200796                        | 150200797 | 150200798                        | 150200799 | 150200800                        | 150200801 | 150200802                        | 150200803 | 150200804                        | 150200805 | 150200806                         | 150200807 | 150200808                         | 150200809 |
| CKTS: 13  | 150200810                       | 150200811 | 150200812                       | 150200813 | 150200814                       | 150200815 | 150200816                        | 150200817 | 150200818                        | 150200819 | 150200820                        | 150200821 | 150200822                        | 150200823 | 150200824                        | 150200825 | 150200826                        | 150200827 | 150200828                         | 150200829 | 150200830                         | 150200831 |
| CKTS: 15  | 150200832                       | 150200833 | 150200834                       | 150200835 | 150200836                       | 150200837 | 150200838                        | 150200839 | 150200840                        | 150200841 | 150200842                        | 150200843 | 150200844                        | 150200845 | 150200846                        | 150200847 | 150200848                        | 150200849 | 150200850                         | 150200851 | 150200852                         | 150200853 |
| CKTS: 17  | 150200854                       | 150200855 | 150200856                       | 150200857 | 150200858                       | 150200859 | 150200860                        | 150200861 | 150200862                        | 150200863 | 150200864                        | 150200865 | 150200866                        | 150200867 | 150200868                        | 150200869 | 150200870                        | 150200871 | 150200872                         | 150200873 | 150200874                         | 150200875 |
| CKTS: 19  | 150200876                       | 150200877 | 150200878                       | 150200879 | 150200880                       | 150200881 | 150200882                        | 150200883 | 150200884                        | 150200885 | 150200886                        | 150200887 | 150200888                        | 150200889 | 150200890                        | 150200891 | 150200892                        | 150200893 | 150200894                         | 150200895 | 150200896                         | 150200897 |
| CKTS: 21  | 150200898                       | 150200899 | 150200900                       | 150200901 | 150200902                       | 150200903 | 150200904                        | 150200905 | 150200906                        | 150200907 | 150200908                        | 150200909 | 150200910                        | 150200911 | 150200912                        | 150200913 | 150200914                        | 150200915 | 150200916                         | 150200917 | 150200918                         | 150200919 |
| CKTS: 23  | 150200920                       | 150200921 | 150200922                       | 150200923 | 150200924                       | 150200925 | 150200926                        | 150200927 | 150200928                        | 150200929 | 150200930                        | 150200931 | 150200932                        | 150200933 | 150200934                        | 150200935 | 150200936                        | 150200937 | 150200938                         | 150200939 | 150200940                         | 150200941 |
| CKTS: 25  | 150200942                       | 150200943 | 150200944                       | 150200945 | 150200946                       | 150200947 | 150200948                        | 150200949 | 150200950                        | 150200951 | 150200952                        | 150200953 | 150200954                        | 150200955 | 150200956                        | 150200957 | 150200958                        | 150200959 | 150200960                         | 150200961 | 150200962                         | 150200963 |
| CKTS: 27  | 150200964                       | 150200965 | 150200966                       | 150200967 | 150200968                       | 150200969 | 150200970                        | 150200971 | 150200972                        | 150200973 | 150200974                        | 150200975 | 150200976                        | 150200977 | 150200978                        | 150200979 | 150200980                        | 150200981 | 150200982                         | 150200983 | 150200984                         | 150200985 |
| CKTS: 29  | 150200986                       | 150200987 | 150200988                       | 150200989 | 150200990                       | 150200991 | 150200992                        | 150200993 | 150200994                        | 150200995 | 150200996                        | 150200997 | 150200998                        | 150200999 | 150201000                        | 150201001 | 150201002                        | 150201003 | 150201004                         | 150201005 | 150201006                         | 150201007 |
| CKTS: 31  | 150201008                       | 150201009 | 150201010                       | 150201011 | 150201012                       | 150201013 | 150201014                        | 150201015 | 150201016                        | 150201017 | 150201018                        | 150201019 | 150201020                        | 150201021 | 150201022                        | 150201023 | 150201024                        | 150201025 | 150201026                         | 150201027 | 150201028                         | 150201029 |
| CKTS: 33  | 150201030                       | 150201031 | 150201032                       | 150201033 | 150201034                       | 150201035 | 150201036                        | 150201037 | 150201038                        | 150201039 | 150201040                        | 150201041 | 150201042                        | 150201043 | 150201044                        | 150201045 | 150201046                        | 150201047 | 150201048                         | 150201049 | 150201050                         | 150201051 |
| CKTS: 35  | 150201052                       | 150201053 | 150201054                       | 150201055 | 150201056                       | 150201057 | 150201058                        | 150201059 | 150201060                        | 150201061 | 150201062                        | 150201063 | 150201064                        | 150201065 | 150201066                        | 150201067 | 150201068                        | 150201069 | 150201070                         | 150201071 | 150201072                         | 150201073 |
| CKTS: 37  | 150201074                       | 150201075 | 150201076                       | 150201077 | 150201078                       | 150201079 | 150201080                        | 150201081 | 150201082                        | 150201083 | 150201084                        | 150201085 | 150201086                        | 150201087 | 150201088                        | 150201089 | 150201090                        | 150201091 | 150201092                         | 150201093 | 150201094                         | 150201095 |
| CKTS: 39  | 150201096                       | 150201097 | 150201098                       | 150201099 | 150201100                       | 150201101 | 150201102                        | 150201103 | 150201104                        | 150201105 | 150201106                        | 150201107 | 150201108                        | 150201109 | 150201110                        | 150201111 | 150201112                        | 150201113 | 150201114                         | 150201115 | 150201116                         | 150201117 |
| CKTS: 41  | 150201118                       | 150201119 | 150201120                       | 150201121 | 150201122                       | 150201123 | 150201124                        | 150201125 | 150201126                        | 150201127 | 150201128                        | 150201129 | 150201130                        | 150201131 | 150201132                        | 150201133 | 150201134                        | 150201135 | 150201136                         | 150201137 | 150201138                         | 150201139 |
| CKTS: 43  | 150201140                       | 150201141 | 150201142                       | 150201143 | 150201144                       | 150201145 | 150201146                        | 150201147 | 150201148                        | 150201149 | 150201150                        | 150201151 | 150201152                        | 150201153 | 150201154                        | 150201155 | 150201156                        | 150201157 | 150201158                         | 150201159 | 150201160                         | 150201161 |
| CKTS: 45  | 150201162                       | 150201163 | 150201164                       | 150201165 | 150201166                       | 150201167 | 150201168                        | 150201169 | 150201170                        | 150201171 | 150201172                        | 150201173 | 150201174                        | 150201175 | 150201176                        | 150201177 | 150201178                        | 150201179 | 150201180                         | 150201181 | 150201182                         | 150201183 |
| CKTS: 47  | 150201184                       | 150201185 | 150201186                       | 150201187 | 150201188                       | 150201189 | 150201190                        | 150201191 | 150201192                        | 150201193 | 150201194                        | 150201195 | 150201196                        | 150201197 | 150201198                        | 150201199 | 150201200                        | 150201201 | 150201202                         | 150201203 | 150201204                         | 150201205 |
| CKTS: 49  | 150201206                       | 150201207 | 150201208                       | 150201209 | 150201210                       | 150201211 | 150201212                        | 150201213 | 150201214                        | 150201215 | 150201216                        | 150201217 | 150201218                        | 150201219 | 150201220                        | 150201221 | 150201222                        | 150201223 | 150201224                         | 150201225 | 150201226                         | 150201227 |



**NOTES:**  
 1. NO PRINTING ON JUMPER CABLE UNLESS OTHERWISE SPECIFIED. IF PRINTING IS REQUIRED, THEN IT WOULD BE CONSIDERED A SPECIAL JUMPER CABLE.

|             |                 |      |             |   |  |  |              |                        |                           |          |      |          |                     |   |                    |
|-------------|-----------------|------|-------------|---|--|--|--------------|------------------------|---------------------------|----------|------|----------|---------------------|---|--------------------|
| SEE SHEET 1 | EC NO:<br>DRWN: | REV  | DESCRIPTION | QUALITY SYMBOL  | GENERAL TOLERANCES<br>(UNLESS SPECIFIED) | DIMENSION STYLE<br>MM  | SCALE<br>--- | DESIGN UNITS<br>METRIC | THIRD ANGLE<br>PROJECTION |          |      |          |                     |   |                    |
|             |                 |      |             | ▼=0   |  |  |              |                        |                           | mm       | INCH | DRAWN BY | DATE                | TITLE<br><b>0.50MM CENTER<br/>FFC JUMPER CABLE<br/>AU PLATING</b> |                    |
|             |                 |      |             | ▽=0   |  |  |              |                        |                           | 4 PLACES | ±--- | ±---     | CHECKED BY          |   | DATE               |
|             |                 |      |             |   |  |  |              |                        |                           | 3 PLACES | ±--- | ±---     | APPROVED BY         |   | DATE               |
|             |                 |      |             |   |  |  |              |                        |                           | 2 PLACES | ±--- | ±---     | DRASMUSS 2010/11/30 |   | MOLEX INCORPORATED |
|             | 1 PLACE         | ±--- | ±---        | MATERIAL NO.<br><b>SEE CHART</b>                              |  | DOCUMENT NO.<br><b>SD-15020-001</b>  |              |                        |                           |          |      |          |                     |   |                    |
| 2           |                 |      |             | DRAFT WHERE<br>APPLICABLE<br>MUST REMAIN<br>WITHIN DIMENSIONS | SIZE<br><b>C</b>                         | THIS DRAWING CONTAINS INFORMATION THAT IS PROPRIETARY TO MOLEX<br>INCORPORATED AND SHOULD NOT BE USED WITHOUT WRITTEN PERMISSION |              |                        |                           |          |      |          |                     |   |                    |