

| | |
|--------------|--------------------|
| MODEL NUMBER | DCB-3510-FF-SMA-02 |
| REV. | D1 |

- NOTES:
- 1.0 ELECTRICAL SPECIFICATIONS:
 - 1.1 FREQUENCY RANGE: 250 MHz to 18.5 GHz
 - 1.2 IMPEDANCE: 50 OHMS, NOM.
 - 1.3 VSWR: 1.35:1 MAX.
 - 1.4 INSERTION LOSS: 0.5dB MAX.
 - 1.5 INSERTION LOSS AT 1 KHz: > 60dB
 - 1.6 DC WORKING VOLTAGE: 200 VOLTS, MIN.
 - 1.7 OPERATING TEMPERATURE: -65°C to +125°C
 - 1.8 TYPE: INNER ONLY

2.0 MARKING: MARK UNIT AS SHOWN
(REF.: INK-04702-27-03)

3.0 DIMENSIONS IN PARENTHESIS ARE IN MILLIMETERS.

SMA FEMALE CONN.
PER MIL-PRF-39012

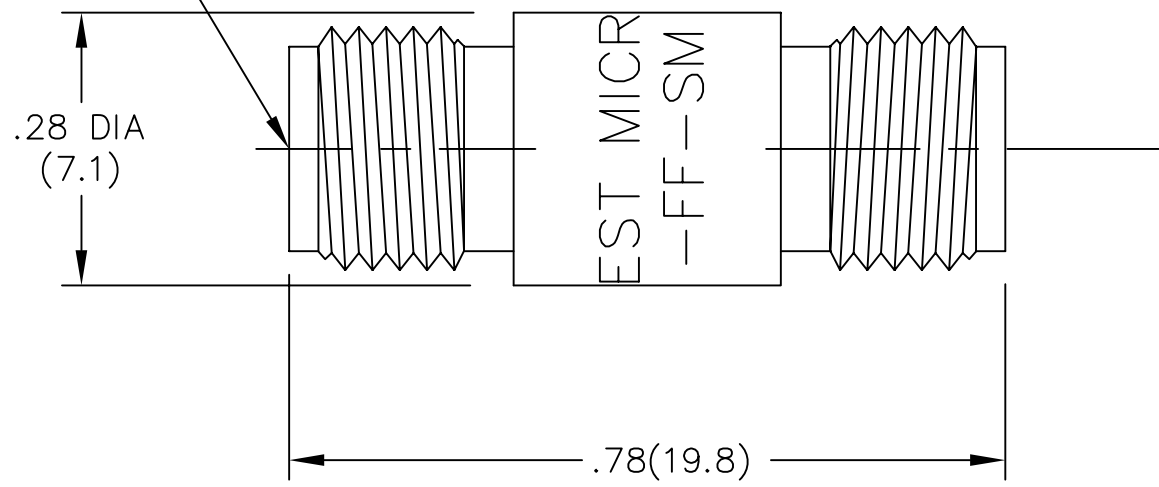

DWG NO. WAS: 03973-01-00

| REV. | DESCRIPTION | DATE |
|------|------------------|---------|
| - | RELEASED | 3/5/82 |
| A | ECR 2201 | 5/23/83 |
| B | ECR 6545 | 7/10/89 |
| C | ECN 12424 | 2/11/93 |
| D | ECN 12489 | 3/16/93 |
| D1 | ADDED TITLEBLOCK | 5/25/05 |

| | | | |
|---|---|---------------------------------|--------------------------------------|
| UNLESS OTHERWISE NOTED DIMENSIONS ARE IN INCHES AND TOLERANCES ARE: 3 PLACE DECIMALS ±.005 2 PLACE DECIMALS ±.02 FRACTIONS ±1/64 PARALLELITY: T.I.R. FLATNESS: T.I.R. CONCENTRICITY: T.I.R. ANGLES AND PERPENDICULARITY: | FSCM NO. 34078 | MIDWEST MICROWAVE | |
| | NOTICE: The information contained in this drawing is proprietary and must not be used without the permission of Midwest Microwave | TITLE DC BLOCK | |
| | DRAWN/DATE A.BEATTY 2/12/93 | ENG./DATE G.KOZAK 2/18/93 | DRAWING NUMBER DCB-3510-FF-SMA-02 |
| | CHECKED/DATE M.HOLLMAN 2/17/93 | APPROVED/DATE | SCALE: 5=1 SHEET 1 of 1 |