

THIS DRAWING IS UNPUBLISHED. RELEASED FOR PUBLICATION ,19 .  
 © COPYRIGHT 19 BY AMP INCORPORATED. ALL RIGHTS RESERVED.

| LOC | DIST | REVISIONS   |                          |         |       |
|-----|------|-------------|--------------------------|---------|-------|
| P   | LTR  | DESCRIPTION | DATE                     | DWN     | APVD  |
| G   | 14   | H           | REDRAWN PER 0720-0470-95 | 23JAN95 | LO ME |

|                                |                                |                                |
|--------------------------------|--------------------------------|--------------------------------|
| <b>AMP</b><br>WIRE RANGE       | E13288                         | LR7189<br>Certified            |
| 22-16 AWG<br>SOLID OR STRANDED | 22-16 AWG<br>SOLID OR STRANDED | 22-16 AWG<br>SOLID OR STRANDED |

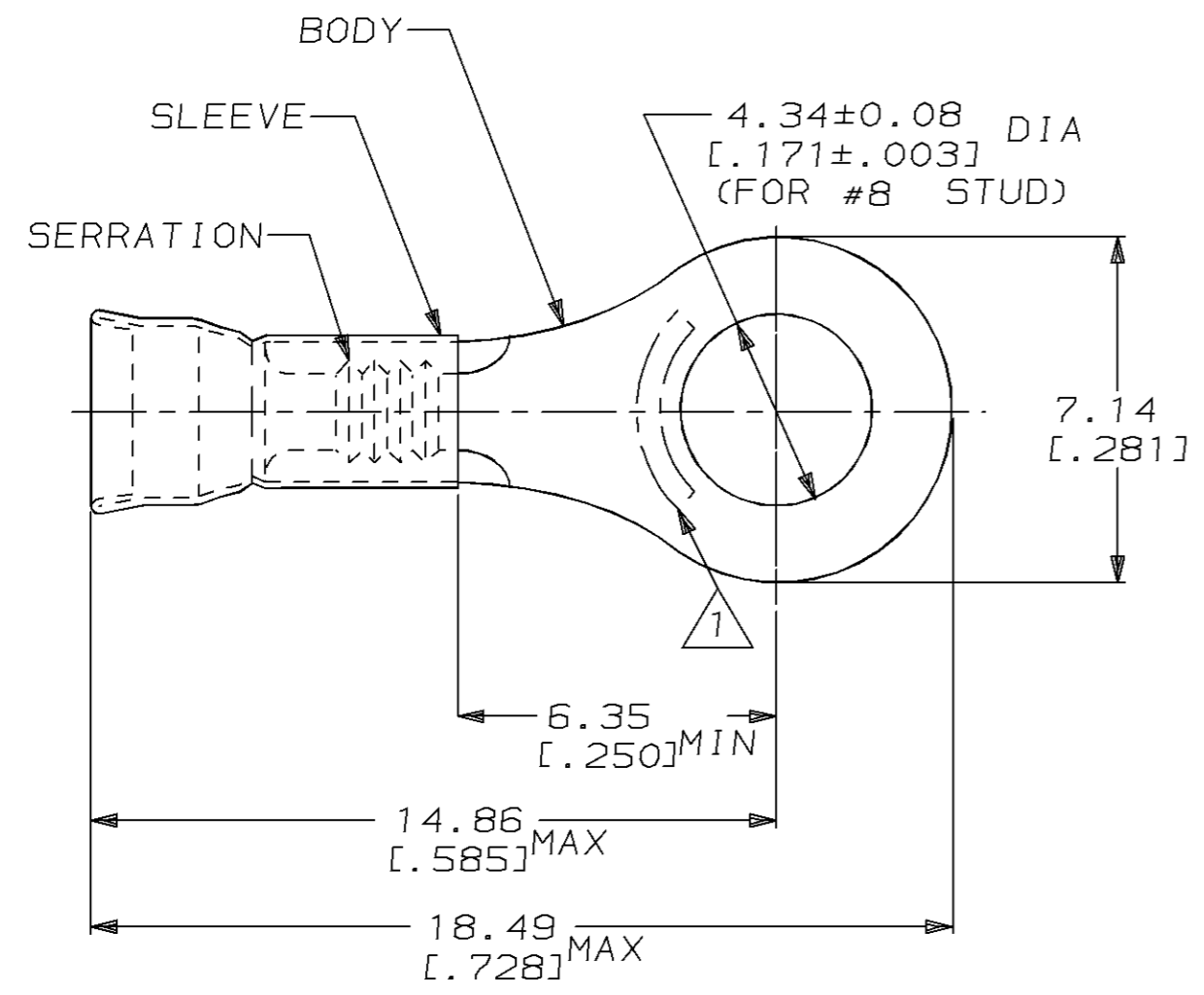

1. STAMP AMP 22-18\* APPROX AS SHOWN  
22-16 TERMINALS ARE STAMPED 22-18 IN  
ACCORDANCE WITH MILITARY SPEC MIL-T-7928  
COMMERCIAL WIRE RANGE IS 22-16
2. WIRE INSUL DIA, 2.03-3.18 [.080-.125]
3. TONGUE MATL THK, 0.79±0.05 [.031±.002]

|      |               |           |
|------|---------------|-----------|
| 5000 | ON TAPE, REEL | 2-31270-1 |
| 1000 | LOOSE PIECE   | 31270     |
| QTY  | PACKAGE TYPE  | PART NO   |

|  |  |   |  |  |   |  |  |
|--|--|---|--|--|---|--|--|
| AMP INCORPORATED<br>CUSTOMER SERVICE SYSTEM                                      |  | MAX RECOMMENDED OPERATING TEMPERATURE:<br>170°C [338°F] | THIS DRAWING IS A CONTROLLED DOCUMENT FOR AMP INCORPORATED.<br>IT IS SUBJECT TO CHANGE AND THE CONTROLLING ENGINEERING ORGANIZATION SHOULD BE CONTACTED FOR THE LATEST REVISION. |  | DWN<br>L OLMEDA<br>23JAN95  | <b>AMP</b> AMP Incorporated<br>Harrisburg, PA 17105-3608 |  |
| FOR ADDITIONAL PRODUCT INFORMATION OR COPIES OF DRAWINGS AND TECHNICAL DOCUMENTS | PRODUCT INFORMATION CENTER<br>1-800-522-6752 |   | VOLTAGE RATING:<br>-   | DIMENSIONS:<br>mm [in]                         | TOLERANCES UNLESS OTHERWISE SPECIFIED:<br>0 PLC ±-<br>1 PLC ±-<br>2 PLC ±0.20 [.008]<br>3 PLC ±-<br>4 PLC ±-<br>ANGLES ±- |  | CHK<br>M ELLIS<br>23JAN95                                |
| FOR APPLICATION TOOLING INFORMATION  | TOOLING ASSISTANCE CENTER<br>1-800-722-1111  | CIRCULAR MIL AREA:<br>0.26mm²-1.65mm² [509-3260]        |  | MATERIAL<br>BODY, CU, SLV, CU PER<br>ASTM B152 | FINISH<br>TIN PLATE<br>PER MIL-T-10727  | PRODUCT SPEC<br>UL486A                                   | TERMINAL, RING,<br>DIAMOND GRIP,<br>WIRE SIZE, 22-16 AWG |
| FOR ORDER ENTRY  | 1-800-526-5142                               | -   |  |  |   | APPLICATION SPEC<br>-                                    | SIZE<br>A3   |
|  |  |   |  |  |   | WEIGHT<br>-  | CAGE CODE<br>00779                                       |
|  |  |   |  |  |   |  | DRAWING NO<br>C-31270                                    |
|  |  |   |  |  |   |  | SCALE<br>6:1   |
|  |  |   |  |  |   |  | SHEET<br>1 OF 1  |
|  |  |   |  |  |   |  | REV<br>H   |
|  |  |   |  |  |   |  | CUSTOMER DRAWING   |