

DO NOT SCALE PRINT

AUGAT CONFIDENTIAL

THIS DOCUMENT CONTAINS INFORMATION WHICH IS THE EXCLUSIVE PROPERTY OF AUGAT INC. REPRODUCTION OR USE BY OTHERS IS NOT PERMITTED WITH THE EXPRESSED WRITTEN CONSENT OF AUGAT INC.

REV.	
DWG. NO.	

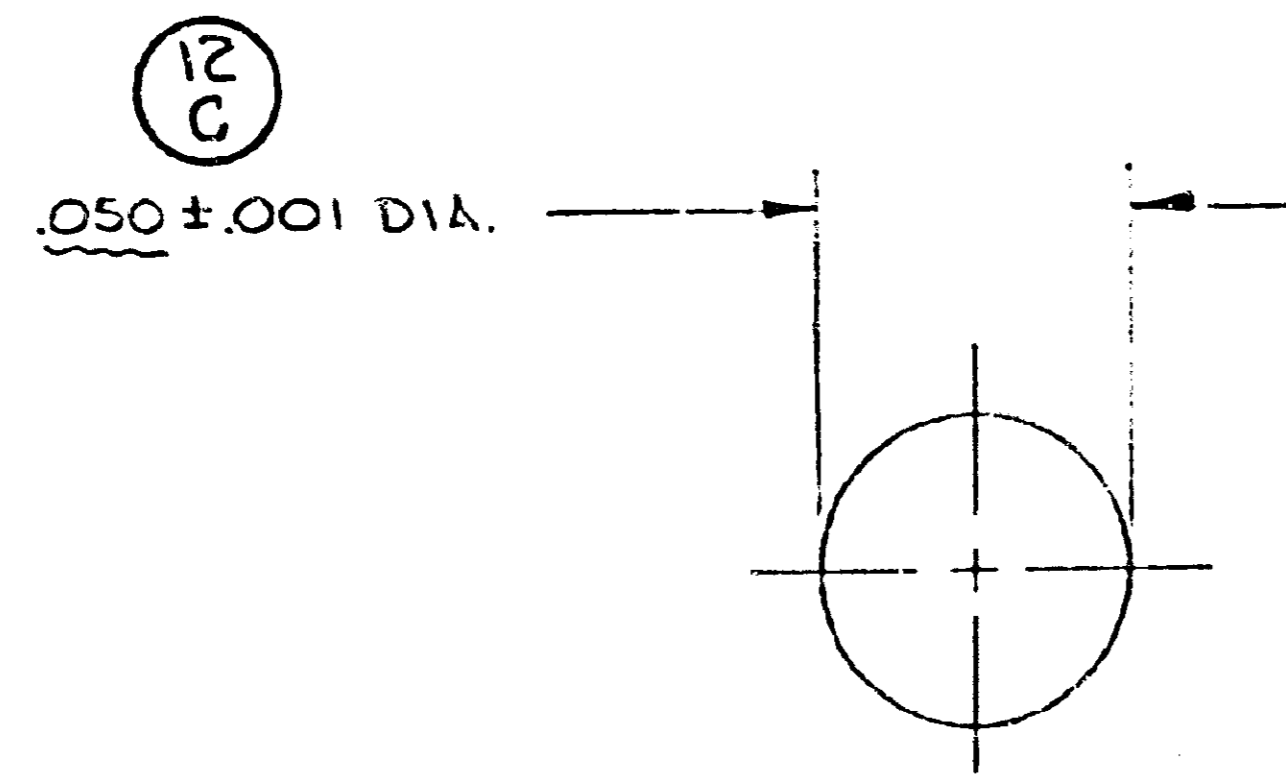

PART No	'A'	'B'
P1	.062	.233
P3	.125	.300

LEGEND:

C = CRITICAL DIMENSION
M = MAJOR DIMENSION
MN = MINOR DIMENSION

CRITICAL DIM.	MAJOR DIM.	LAST USED	DELETED
3,4,7,11,12	1,2,6	12	

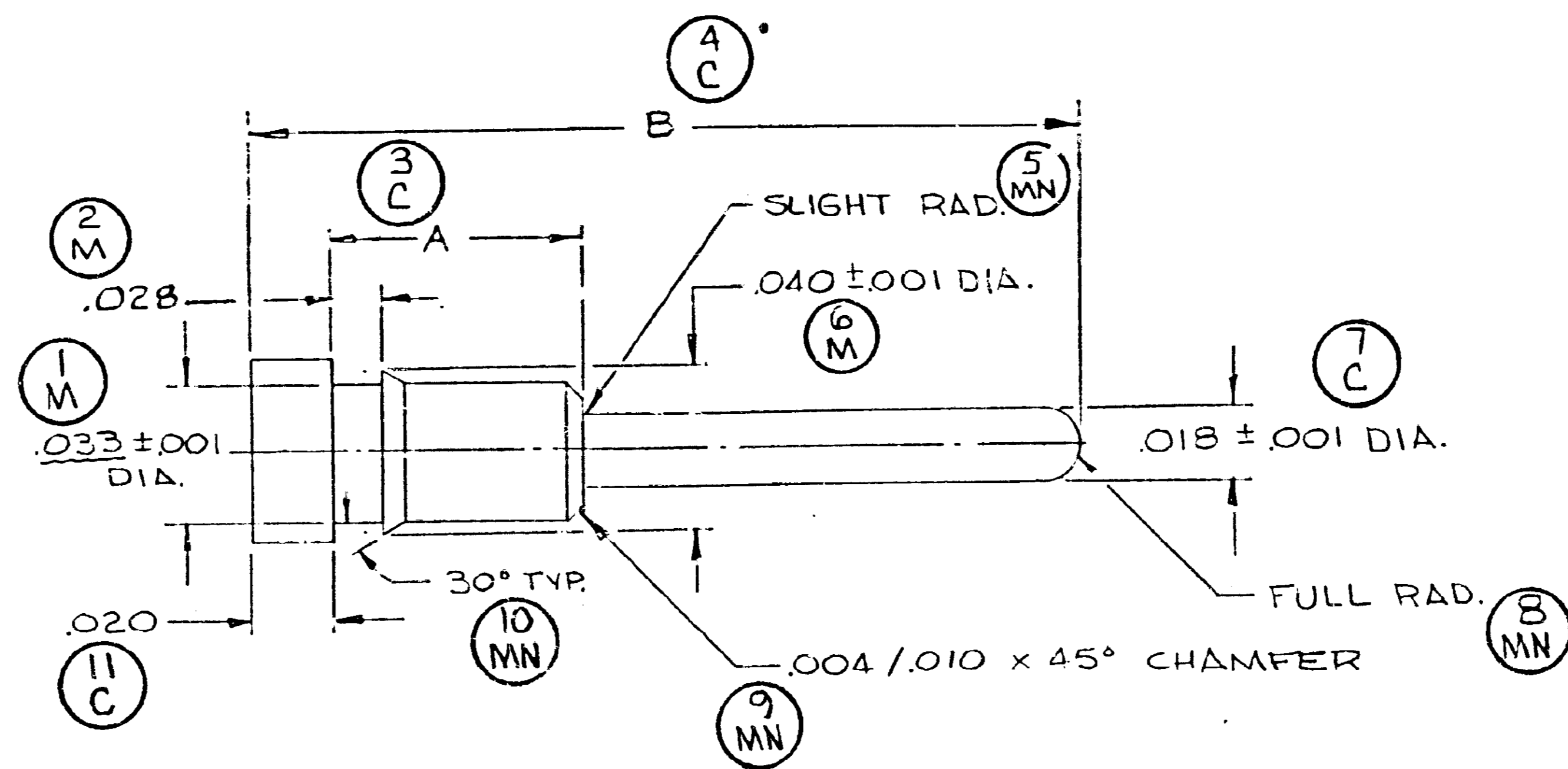

- (P1) (P3) PHOSPHOR BRONZE PER QQ-P-330, COMP. A
- (P2) GOLD PLATE P1 PER AUGAT SPEC. 151 PARA. 3.1.2. Δ
- (P4) GOLD PLATE P3 PER AUGAT SPEC. 151 PARA. 3.1.2. Δ
- (P6) TIN-LEAD W/PLATE P1 PER AUGAT SPEC. 151 PARA. 3.3.12 Δ Δ
- (P7) GOLD PLATE P3 PER AUGAT SPEC. 151, PARA. 3.2.11. Δ

REV.	DESCRIPTION
1	NAS AX215-67-B 050 ± .001 DIA. WAS 045 ± .001 DIA STOCK 033 WAS .034 DELETED .050, ADDED 028 .233 WAS .207 4 DDED SLIGHT RAD. .004 / .010 X45° CHAMFER WAS .004 X45° CHAMFER ADDED DIA. TO .040 ± .001 E.C.O. 12-68 N. DESLOIS 5-3-68 APPD. DAE. 5-3-68
2	ADDED PER IP4 ADDED TABULATION E.C.O. NO. 303-69 E.C.D. 12-73-69 APPD. E.C. 2-23-74
3	UPDATED PLATING TO CURRENT AUGAT SPEC. E.C.C. 224-75, R.S. 3-18-75 APPRO.
4	E.C.O. NO. 56-77 E.K. 1-18-77
5	APP'D C.E.D. 1-18-77
6	E.C.O. NO. 51031-79 E.K. 10-4-79 APP'D R.H. 10-9-79
7	ECO 525-92 M.M. 4-24-92 APP'D A.S.C. 4-27-92
8	ECO 1071-92 M.M. 9-25-92 APP'D: A.J.F. 9/28/92

UNLESS OTHERWISE SPECIFIED
DIMENSIONS ARE IN INCHES
TOLERANCES ON
FRACTIONS DECIMALS ANGLES
 $\pm \frac{1}{32}$ $\pm .005$ $\pm 1^\circ$

MATERIAL:
AS NOTED

FINISH:
AS NOTED

DESCRIPTION	DWG. SIZE	PART NUMBER	ITEM NO.
PC 11			
ORIGINAL DATE OF DRAWING:	12-19-67	AUGAT INC. 33 Perry Avenue Attleboro, Mass. 02703	
DRAWN: N. DEBLOIS	DATE: 5-3-68		
CHECKED: BAR	DATE: 5-3-68	TITLE: PIN DWG. NO. 3149-3 REV. 7	
APPROVED: <i>[Signature]</i>	DATE: 5-3-68		
CODE IDENT NO. 91506	DWG. SIZE B	SCALE: 20-1 SHEET OF 1	
NEXT ASSY: 12		Printed in U.S.A.	