

THIS DRAWING IS A CONTROLLED DOCUMENT

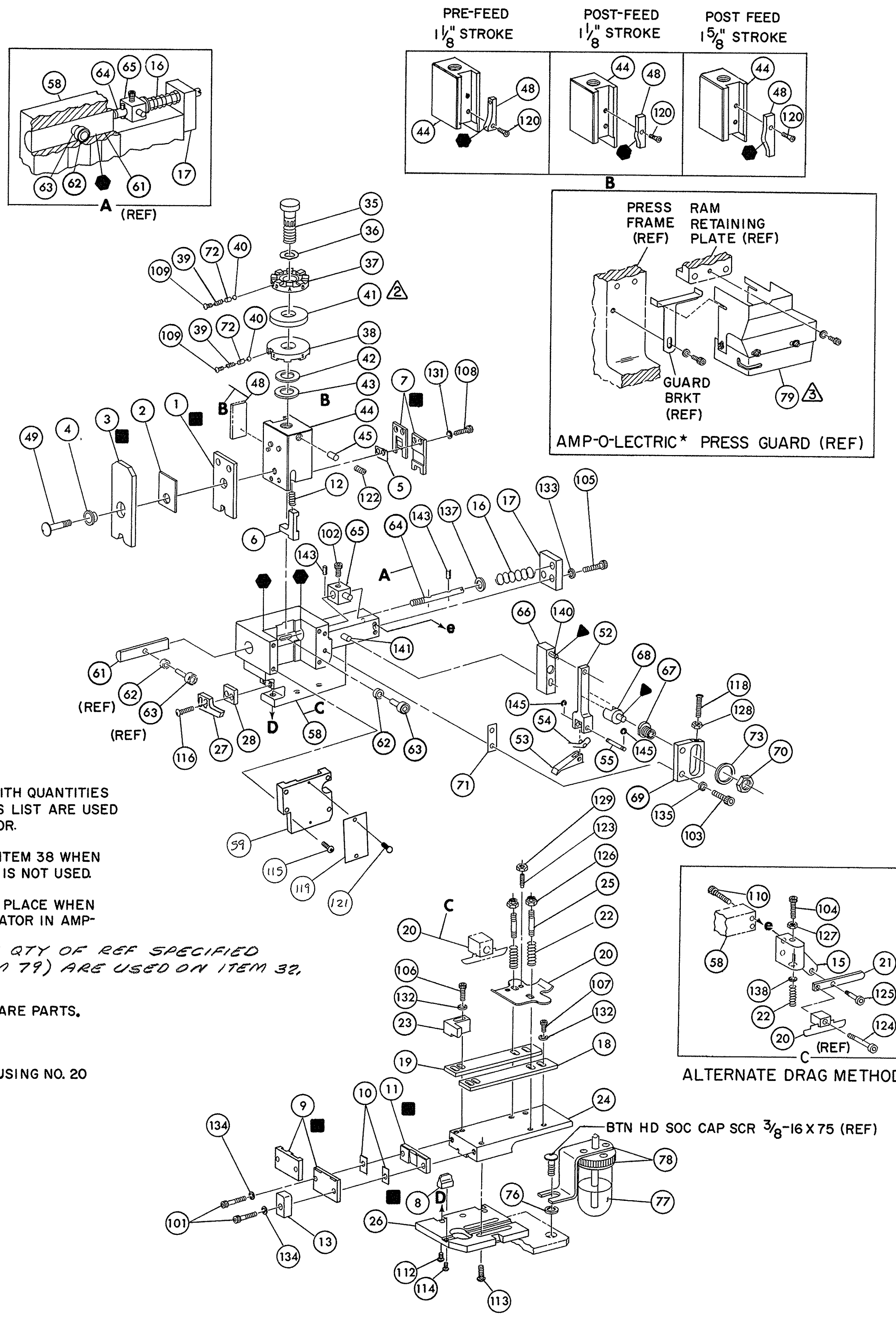

NOTES:

1. ONLY THE ITEMS WITH QUANTITIES SPECIFIED ON PARTS LIST ARE USED ON THIS APPLICATOR.

△ USED IN PLACE OF ITEM 38 WHEN INSULATION CRIMP IS NOT USED.

▲ GUARD MUST BE IN PLACE WHEN OPERATING APPLICATOR IN AMP-O-LECTRIC PRESS.

4. PARTS WITH QTY OF REF SPECIFIED (EXCEPT ITEM 79) ARE USED ON ITEM 32.

KEY:

- RECOMMENDED SPARE PARTS.
- ▲ LUBRICATE DAILY USING NO. 20 MACHINE OIL.
- GREASE LIGHTLY.

ALTERNATE DRAG METHOD

REF	QTY	PART NO	DESCRIPTION	ITEM NO
21045-3	145	REF	RING, RETAINING 'C' (.187 DIA) FEED PIN	REF
5-21028-1	143	REF	PIN, SLOT SPG (.12 DIA X .50) FD ADJ ROD	REF
1-21030-7	141	REF	PIN, DOWEL (.187 DIA X 1.50) HOUSING	REF
1-21030-1	140	REF	PIN, DOWEL (.187 DIA X .50) LEVER	REF
22260-5	139	REF	WASHER, FLAT (NO 6) DRAG SPRING	REF
21899-4	138	REF	WASHER, FLAT (5/16 DIA) SCR ADJ	REF
21024-5	136	REF	WASHER, LOCK (NO 10) FEED ADJ PLATE	REF
21024-5	135	1	WASHER, LOCK (NO 10) SHEAR PLATES	7-21002-9
21024-5	134	1	WASHER, LOCK (NO 10) FEED ROD GUIDE	690501-4
21024-4	133	REF	WASHER, LOCK (NO 8) STRIP GUIDE	REF
21024-4	132	REF	WASHER, LOCK (NO 8) SHEAR BLADE	240634-1
21018-4	131	1	NUT, HEX MACH (4-40) DRAG	690191-1
21068-5	129	1	NUT, HEX MACH (6-32) FD ADJ PLATE	455674-1
21018-7	128	1	NUT, HEX MACH (10-32) DRAG SPRING	690125-1
21022-2	127	REF	NUT, HEX SELF-LKG (8-32) DRAG STUD	690124-1
5-21004-7	126	2	SCR, SKT HD SHLD (250 DIA X .25) DRAG ARM	23241-6
21004-5	125	2	SCR, SKT HD SHLD (250 DIA X 1.00) DRAG	690170-1
4-21078-8	124	1	SCR, SKT SET OVAL POINT (4-40 X .75) DRAG	690192-1
21009-2	123	1	SCR, SKT SET (1/4-20 X 25) (LOC-WEL) RAM	9-690692-9
21017-2	122	1	SCR, DRIVE (#2 X .19) ID PLATE	22480-5
2-21003-0	121	1	SCR, FLAT HD SKT CAP (6-32 X .50) CAM	690212-1
461264-1	120	REF	PLATE, ID	
3-21064-2	119	REF	SCR, RD HD MACH (6-32 X 1.50) FEED ADJ	
2-21002-2	118	1	SCR, BTN HD SKT CAP (8-32 X .50) STRIPPER	458980-1
2-21002-9	116	REF	SCR, BTN HD SKT CAP (10-32 X .75) HSG CAP	
2-21002-3	115	REF	SCR, BTN HD SKT CAP (8-32 X .38) (LOC-WEL) ANVIL	
1-24073-9	114	1	SCR, BTN HD SKT CAP (1/4-20 X .50) STR GDE PL	3-690451-2
2-21000-4	113	1	SCR, SKT HD SKT CAP (1/4-20 X .75) BASE PL	240639-1
2-21000-6	112	REF	SCR, SKT HD CAP (6-32 X 1.00) DRAG ADAPTOR	455676-1
2-21000-8	111	2	SCR, SKT HD CAP (8-32 X .62) STRIP GUIDE	22354-8
2-21000-7	110	1	SCR, SKT HD CAP (10-32 X .75) FD ROD GUIDE	455678-3
2-21000-9	109	1	SCR, SKT HD CAP (10-32 X 1.00) DRAG SPRING	240825-1
2-21000-6	108	2	SCR, SKT HD CAP (8-32 X .38) SHEAR BLADE	4-22281-1
2-21000-8	107	REF	SCR, SKT HD CAP (8-32 X .62) STRIP GUIDE	240636-1
2-21000-7	106	1	SCR, SKT HD CAP (10-32 X .75) FD ADJ PLATE	454177-1
2-21000-9	105	1	SCR, SKT HD CAP (10-32 X 1.00) DRAG SPRING	454209-1
2-21000-6	104	1	SCR, SKT HD CAP (10-32 X .62) FD ADJ PLATE	454209-1
2-21000-4	103	REF	SCR, SKT HD CAP (10-32 X .38) PIVOT BLK	454178-1
2-21000-8	102	REF	SCR, SKT HD CAP (10-32 X .88) SHEAR PLATE	4-22284-9
455745-1	101	REF	GUARD, WINDOW	
465184-9	79	REF	LUBRICATOR ASSY	
455985-1	78	1	OIL, LUBRICATING	1-690481-3
454406-1	77	1	SPACER, LUB BRACKET	23846-1
458109-1	76	1	WASHER, FLAT (SPECIAL)	240644-5
690603-1	75	REF	SPRING, ASSIST	
690517-1	74	1	SPACER	3-690482-4
22594-8	73	1	NUT, HEX	3-240655-0
240628-1	72	1	PLATE, ADJ	690474-6
240626-1	71	1	SHAFT, PIVOT	1-955892-9
240633-1	70	1	BUSHING	4-240691-8
455680-1	69	1	LEVER, INTERMEDIATE	238009-1
240629-1	68	1	BLOCK, PIVOT	1-456134-4
240632-2	67	1	SCREW, ADJ	455888-7
240659-3	66	1	PIN, CAM ROLLER	1-456403-5
240658-1	65	REF	CAM, ROLLER	
454398-1	64	REF	ROD, FEED	

CRIMPING DATA				APPLICATOR WILL APPLY	
PAD LTR	CRIMP HEIGHT	WIRE SIZE	WIRE LENGTH		
A	.049	18	.205-.235		62094
B	.043	20	.205-.235		62523
C	.040	22	.205-.235		62885
D	NOT USED				63068
					1742785

REMARKS	NO	REV
APPL USED ON MACHINE PART NO	MACH SERIAL NO	DISTRIBUTION
CUSTOMER NAME	APPL SERIAL NO	ORIGINAL
ADDRESS	PURCHASE ORDER	CUSTOMER COPY
CITY	ENG APP	FIELD ENG COPY

CRIMP	SIZE	TYPE	FEED	APPL INST
WIRE	.062	F		A18039
INSUL	.140	F	.705	
WIRE RANGE	22-13	INSULATION RANGE	.090-.130	PRESS NO
REMARKS				
AMPOMATOR				

REV	DESCRIPTION	DATE	BY	APP'D
E	ECN A157688	11-88	W/EC	
D	REV FOR ECR 5477	11/14/88	W/EC	
C	REV FOR ECR R-3858	11/14/88	W/EC	
B	REV FOR ECR R-3586	11/14/88	W/EC	
A	ADDED 62885 62929	11/14/88	W/EC	
G	ECN 0150-0325-03	3-03	W/EC	
F	0150-0499-9C	11/85	W/EC	
E	REV PER ECR R791	11/87	W/EC	
D	REV PER ECR R1773	11/87	W/EC	