

PART NUMBER	REV	TERMINATOR	FEED TYPE	DESCRIPTION
1426602-1	A	LEADMAKER	MECH POST FEED	CUTS CARRIER
1426602-2	A	BENCH	MECH PRE FEED	CUTS CARRIER
1426602-6	A	LEADMAKER	MECH POST FEED	CONTINUOUS CARRIER
7-1426602-1	A	LEADMAKER	MECH POST FEED	-1 AND SPARE PARTS
7-1426602-2	A	BENCH	MECH PRE FEED	-2 AND SPARE PARTS
7-1426602-6	A	LEADMAKER	MECH POST FEED	-6 AND SPARE PARTS
7-1426602-7	A	-	-	SPARE PARTS KIT

CRIMP DATA		HARTING TERMINAL		TYCO CRIMP SPECS	
TERMINAL NAME: HIGH DENSITY STAMPED MALE CONTACT					
CRIMP	SIZE	TYPE	RANGE		
WIRE	1.07 [.042 IN]	F	26 AWG-24 AWG		
INSUL	1.40 [.055 IN]	O	0.80-1.00 [.031-.039 IN]		
WIRE STRIP LENGTH 2.80-3.60 [.110-.142 IN]		APPL INSTRUCTIONS 408-8322			
TERMINAL APPL SPEC		FEED		5.60 [.220 IN]	
TERMINALS APPLIED			PIN SOCKET		
TYCO PN	MANUF'S PN	TYCO PN	MANUF'S PN		
1572976-1	09560008165	1572977-1	09560008265		
1572976-2	09560008167	1572977-2	09560008267		
WIRE SIZE	CRIMP HEIGHT	PINPN & LENGTH [IN]			
24 AWG	0.76 ±0.05 [.030 ±.002 IN]	5-354779-8 [.3280]			
26 AWG	0.71 ±0.05 [.028 ±.002 IN]	6-354779-2 [.3300]			

- △ RECOMMENDED SPARE PARTS.
- 2. GREASE RAM, CAM, CAM FOLLOWER AND FEED ROD LIGHTLY.
- △ CERTAIN TERMINALS REQUIRE LUBRICATION. REFER TO THE APPLICATOR INSTRUCTION SHEET FOR MORE INFORMATION.
- 4. LUBRICATE DAILY PER THE APPLICATOR INSTRUCTION SHEET SUPPLIED WITH THE APPLICATOR.
- △ CRIMP DATA CALCULATED BY TYCO ELECTRONICS.

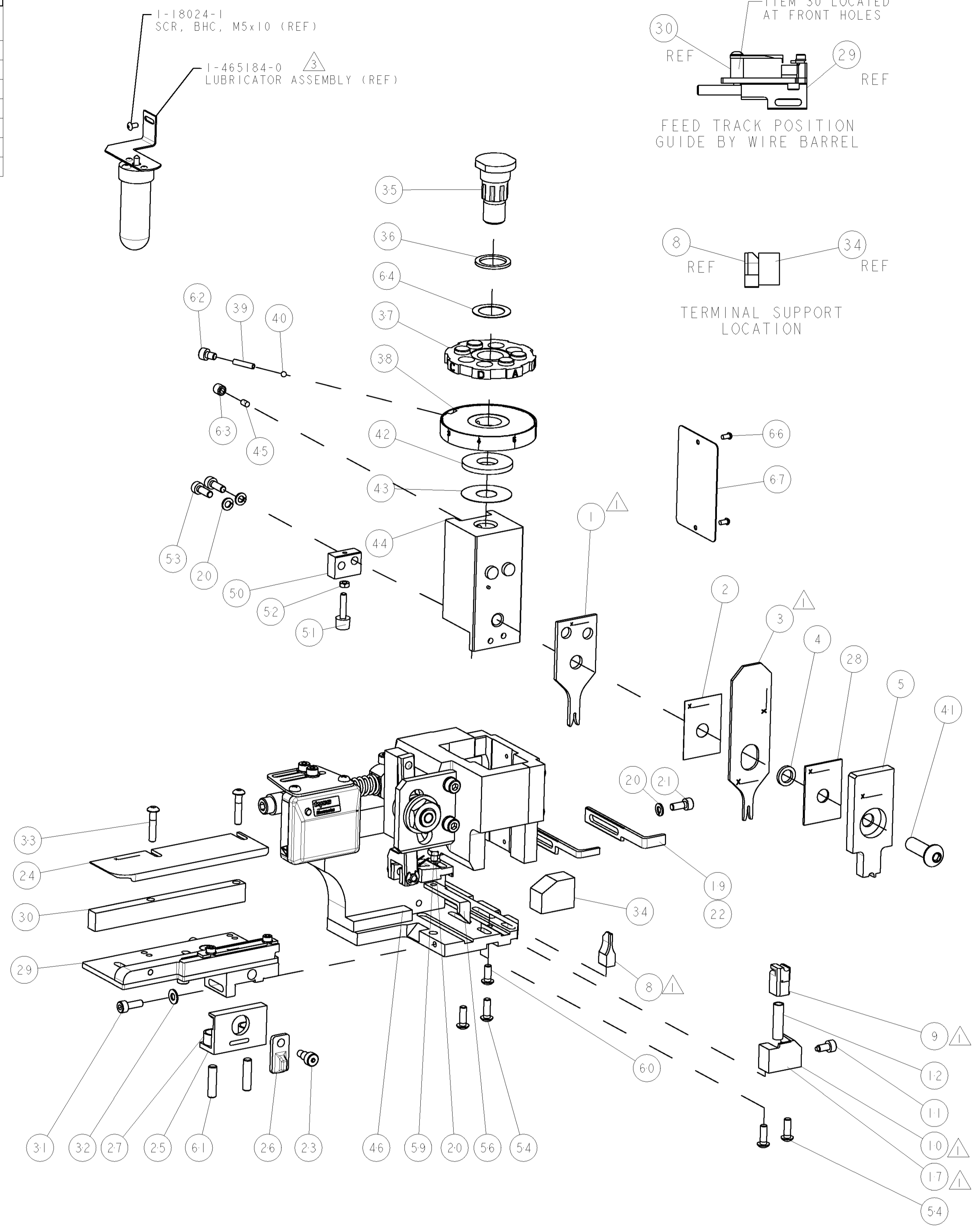
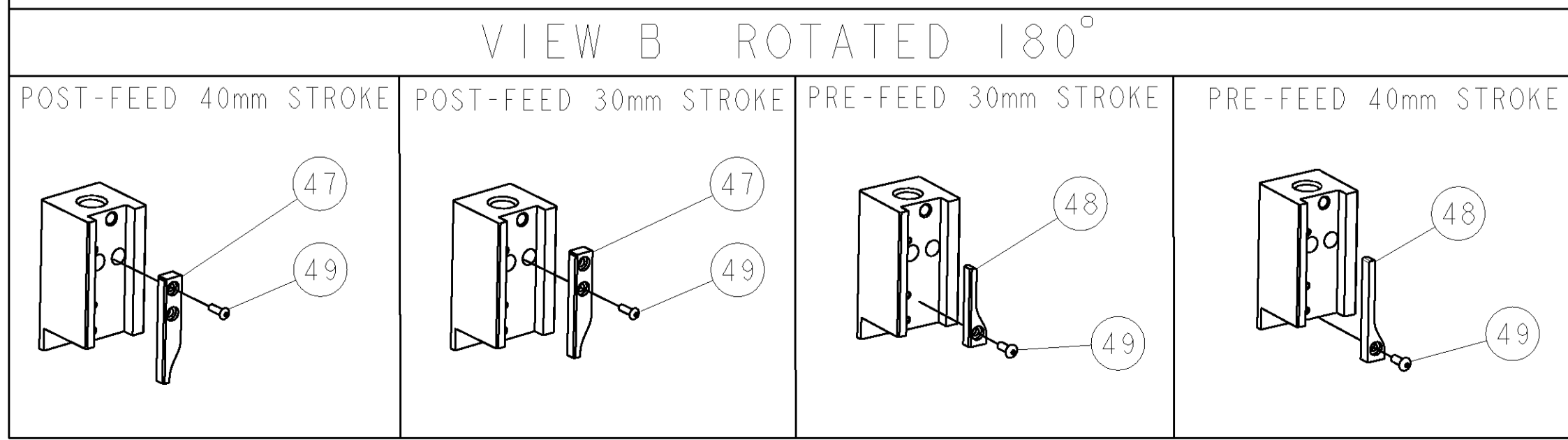

-77	-76	-72	-71	-6	-2	-1	PART NO	DESCRIPTION	ITEM NO
-	-	-	-	-	-	-	-	-	84
-	-	-	-	-	-	-	-	-	83
-	-	-	-	-	-	-	-	-	82
-	-	-	-	-	-	-	-	-	81
-	-	-	-	-	-	-	-	-	80
-	-	-	-	-	-	-	-	-	79
-	-	-	-	-	-	-	-	-	78
-	-	-	-	-	-	-	-	-	77
-	-	-	-	-	-	-	-	-	76
-	-	-	-	-	-	-	-	-	75
-	-	-	-	-	-	-	-	-	74

SET UP GAGE 458637-3		LOC	DIST	REVISIONS					
P	LTR	DESCRIPTION	DATE	BY	APPD	REV	NO	NO	
A		SEE ECO-06-008987	18APR2006	DP	MC				
-	-	-	-	-	-	-	-	73	
-	-	-	-	-	-	-	-	72	
-	-	-	-	-	-	-	-	71	
-	-	-	-	-	-	-	-	70	
-	-	-	-	-	-	-	-	69	
-	-	-	-	-	-	-	-	68	
-	-	-	-	-	-	-	-	67	
-	-	-	-	-	-	-	-	66	
-	-	-	-	-	-	-	-	65	
-	-	-	-	-	-	-	-	64	
-	-	-	-	-	-	-	-	63	
-	-	-	-	-	-	-	-	62	
-	-	-	-	-	-	-	-	61	
-	-	-	-	-	-	-	-	60	
-	-	-	-	-	-	-	-	59	
-	-	-	-	-	-	-	-	58	
-	-	-	-	-	-	-	-	57	
-	-	-	-	-	-	-	-	56	
-	-	-	-	-	-	-	-	55	
-	-	-	-	-	-	-	-	54	
-	-	-	-	-	-	-	-	53	
-	-	-	-	-	-	-	-	52	
-	-	-	-	-	-	-	-	51	
-	-	-	-	-	-	-	-	50	
-	-	-	-	-	-	-	-	49	
-	-	-	-	-	-	-	-	48	
-	-	-	-	-	-	-	-	47	
-	-	-	-	-	-	-	-	46	
-	-	-	-	-	-	-	-	45	
-	-	-	-	-	-	-	-	44	
-	-	-	-	-	-	-	-	43	
-	-	-	-	-	-	-	-	42	
-	-	-	-	-	-	-	-	41	
-	-	-	-	-	-	-	-	40	
-	-	-	-	-	-	-	-	39	
-	-	-	-	-	-	-	-	38	
-	-	-	-	-	-	-	-	37	
-	-	-	-	-	-	-	-	36	
-	-	-	-	-	-	-	-	35	
-	-	-	-	-	-	-	-	34	
-	-	-	-	-	-	-	-	33	
-	-	-	-	-	-	-	-	32	
-	-	-	-	-	-	-	-	31	
-	-	-	-	-	-	-	-	30	
-	-	-	-	-	-	-	-	29	
-	-	-	-	-	-	-	-	28	
-	-	-	-	-	-	-	-	27	
-	-	-	-	-	-	-	-	26	
-	-	-	-	-	-	-	-	25	
-	-	-	-	-	-	-	-	24	
-	-	-	-	-	-	-	-	23	
-	-	-	-	-	-	-	-	22	
-	-	-	-	-	-	-	-	21	
-	-	-	-	-	-	-	-	20	
-	-	-	-	-	-	-	-	19	
-	-	-	-	-	-	-	-	18	
-	-	-	-	-	-	-	-	17	
-	-	-	-	-	-	-	-	16	
-	-	-	-	-	-	-	-	15	
-	-	-	-	-	-	-	-	14	
-	-	-	-	-	-	-	-	13	
-	-	-	-	-	-	-	-	12	
-	-	-	-	-	-	-	-	11	
-	-	-	-	-	-	-	-	10	
-	-	-	-	-	-	-	-	9	
-	-	-	-	-	-	-	-	8	
-	-	-	-	-	-	-	-	7	
-	-	-	-	-	-	-	-	6	
-	-	-	-	-	-	-	-	5	
-	-	-	-	-	-	-	-	4	
-	-	-	-	-	-	-	-	3	
-	-	-	-	-	-	-	-	2	
-	-	-	-	-	-	-	-	1	
-77	-76	-72	-71	-6	-2	-1	PART NO	DESCRIPTION	ITEM NO
DIMENSIONS: mm [IN]		TOLERANCES UNLESS OTHERWISE SPECIFIED:		DWN D. PROUSE 06MAR2006		CHK M. CLIFFORD 06MAR2006		APVD M. CLIFFORD 06MAR2006	
0 PLC ±		1 PLC ±		2 PLC ±		3 PLC ±		4 PLC ±	
ANGLES ±		FINISH ±		MATERIAL		WEIGHT		CUSTOMER DRAWING	
SCALE 3:5		SHEET 1 OF 1		REV A		SIZE CAGE CODE DRAWING NO		RESTRICTED TO	
A1		00779		C=1426602		NAME		Tyco Electronics	
Harrisburg, PA 17105-3608		PRODUCT SPEC		APPLICATION SPEC		See Table		SIDE FEED HDI APPLICATOR	