

- NOTES: (b)**
- RoHS COMPLIANT
 - FOR WAVE SOLDERING (SOLDER BATH TEMPERATURE 260°C FOR 5 SEC. AND SOLDER PREHEAT 100°C FOR 30 SEC.)
 - METAL SHELLS: STEEL; min. 315µm TIN over 40-80µm NICKEL
 - INSULATOR: HIGH TEMPERATURE PLASTIC UL 94 V-0; BLACK
 - CONTACTS: COPPER ALLOY; PLATING (SEE PART NO.):
 PLEASE ADD A for GOLD FLASH over NICKEL (PREFERRED TYPE)
 PLEASE ADD B for 20µm HARD GOLD over min. 50µm NICKEL
 PLEASE ADD C for 30µm HARD GOLD over min. 50µm NICKEL
 PLEASE ADD J for 50µm HARD GOLD over min. 50µm NICKEL
 CONTACT TAILS PRETINNED
 - METAL BRACKETS: ZINC DIE CAST; 300µm COPPER/40-120µm NICKEL/120-200µm TIN
 - THREADED INSERTS: COPPER ALLOY; min. 200µm TIN over 80µm NICKEL
 - FIXING-PLATE: HIGH TEMPERATURE PLASTIC UL 94 V-0; BLACK
 - CAPACITANCE: 1300pF ±20%
 - DIELECTRIC WITHSTANDING VOLTAGE: 424 VDC
 - MAXIMUM TORQUE VALUE FOR THREAD: 6 in.LB
 - CONNECTOR IS PART MARKED: 241□12360X CONEC ABC (see note 5)

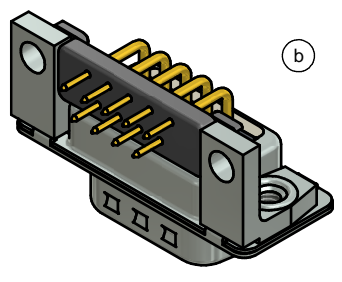

RoHS compliant **(b)**

THIS DRAWING MAY NOT BE COPIED OR REPRODUCED IN ANY WAY, AND MAY NOT BE PASSED ON TO A THIRD PARTY WITHOUT WRITTEN PERMISSION. OWNERSHIP AND COPYRIGHT OF CONEC GmbH DO NOT ALTER CAD DRAWING BY HAND	tolerance		dim. in mm		scale:	2:1 (5:1)
					material:	SEE NOTES
	date	name	title:			
	drawn 01.08.2001	Parei	D-SUB C-FILTER MALE 90°			
	appd. 01.08.2001	Mickenbecker	9pos. SOLDER PIN ANGLED 0.318inch with threaded insert, metal bracket, fixing-plate			
norm		dwg no:		DIN-A3		
d-old		24K1A155A		sh: 1		
8 x b	A5725	16.07.15	M.H.	part no: (b) 241□12360X (see note 5)		
a	Original	CONEC				
rev.	description					