

NOTES:

1. MATERIAL AND FINISH :
  - BODY AND BARREL - BRASS, NICKEL PLATING
  - CONTACT PIN - PHOSPHOR BRONZE, GOLD PLATING
  - INSULATOR - PTFE, NATURAL
  - FERRULE - BRASS, NICKEL PLATING
2. ELECTRICAL:
  - A. IMPEDANCE: 50 OHM
  - B. FREQUENCY RANGE: DC - 11 GHz
  - C. VSWR(RETURN LOSS): 1.3 (17.7 dB), MAX.
  - D. DIELECTRIC WITHSTANDING VOLTAGE: 2500 VRMS. MIN.
3. MECHANICAL:
  - A. DURABILITY: 500 CYCLES MIN.
  - B. TEMPERATURE RANGE: -65°C TO + 165°C
4. PACKAGING AND:
  - A. QUANTITY: SINGLE PACK.
  - B. MARKING: BAG TO BE MARKED  
"AMPHENOL, 82-6092-RFX, AND DATE CODE"
5. CRIMPED CONTACT PIN HEX. CRIMP SIZE .100" OR SOLDER
6. CRIMPED FERRULE HEX. CRIMP SIZE .255"

THIRD ANGLE PROJ.

REVISIONS

REV	DESCRIPTION	DATE	ECO	APPR
A	RELEASE TO MFG.	27-Jun-02	44096	CPM
B	ADD CABLE CALL OUT; ADD NOTES 2 THRU 4	12-Sep-05	45713	CPM
C	SYNC UP DRAWINGS \RD-DM17051901S7	27-May-17	03821	SC

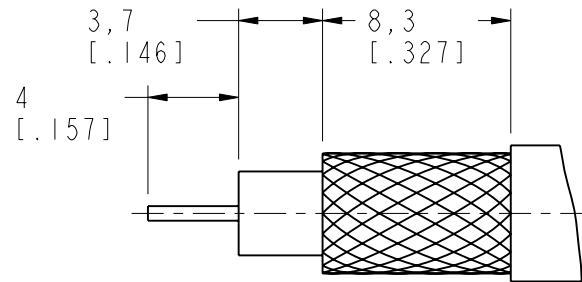

RECOMMENDED  
CABLE STRIPPING DIMENSIONS

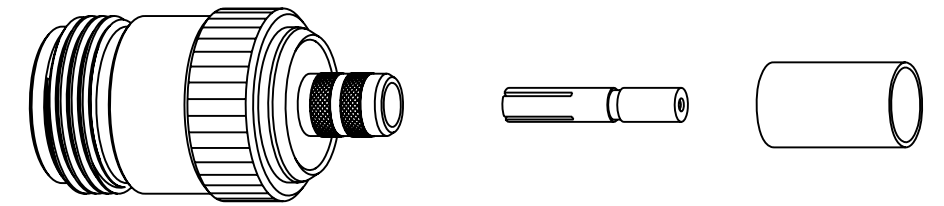

SCALE 1.500

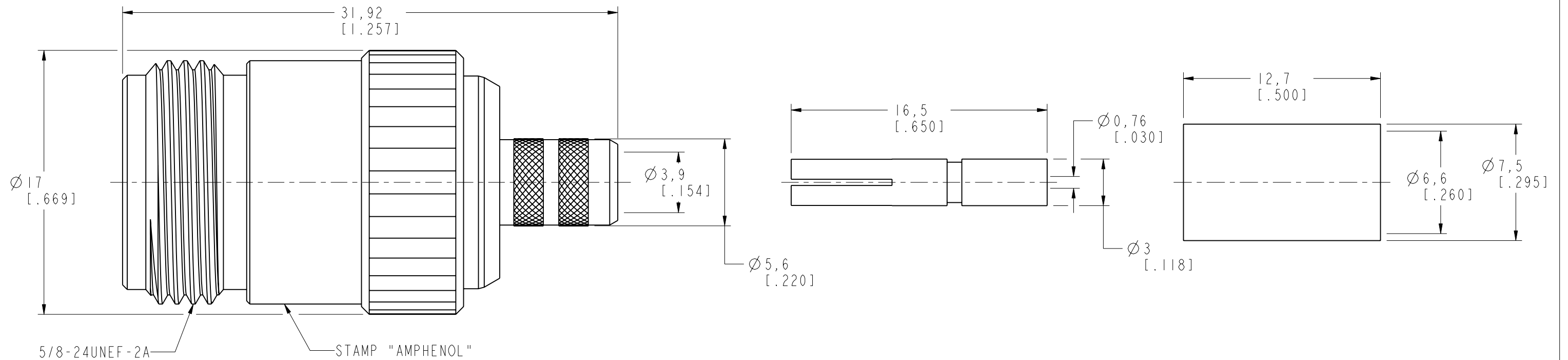

**CUSTOMER OUTLINE DRAWING**

ALL OTHER SHEETS ARE FOR INTERNAL USE ONLY

UNLESS OTHERWISE SPECIFIED, DIMENSIONS ARE IN METRIC AND TOLERANCES ARE: < 0.5mm ± 0.05mm    0.5 - 6mm ± 0.1mm    6 - 30mm ± 0.2mm    30 - 120mm ± 0.3mm    ANGLES ± 1°	MATERIAL	DRAWN STAR	DATE 27-May-17	TITLE N CRIMP JACK FOR RG 59 & 62	Amphenol RF www.amphenolrf.com
	REFERENCE AND CONFIGURATION LEVEL:	ENGINEER O. BARTHELMES	DATE 21-Jun-02		
NOTICE - These drawings, specifications, or other data (1) are, and remain the property of Amphenol corp. (2) must be returned upon request; and (3) are confidential and not to be disclosed to any person other than those to whom they are given by Amphenol Corp. the furnishing of these drawings, specifications, or other data by Amphenol Corp., or to any other person to anyone for any purpose is not to be regarded by implication or otherwise in any manner licensing, granting rights to permitting such holder or any other person to manufacture, use or sell any product, process or design, patented or otherwise, that may in any way be related to or disclosed by said drawings, specifications, or other data.	FINISH	APPROVED S. HSIEH	DATE 31-May-17	SCALE: 4.0:1.0    SHEET 2 OF 2 DWG SIZE B    REV C	