

PRODUCT NUMBER	PITCH
HNxx50x200J0G	5.08 mm

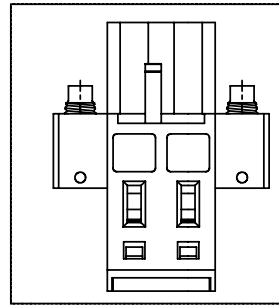

2P

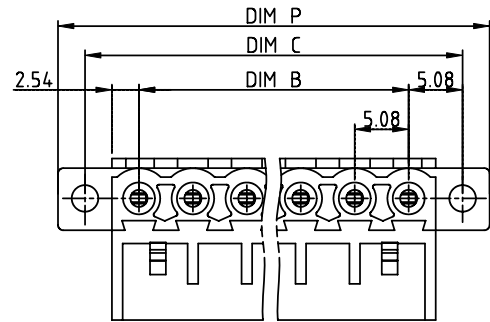
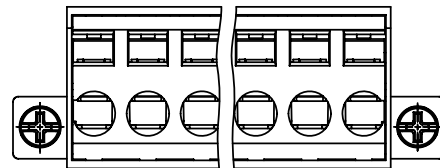
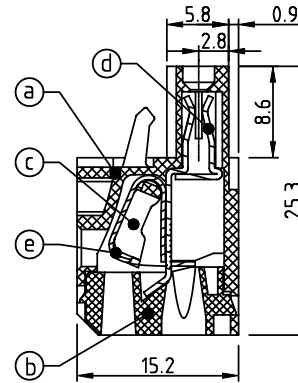
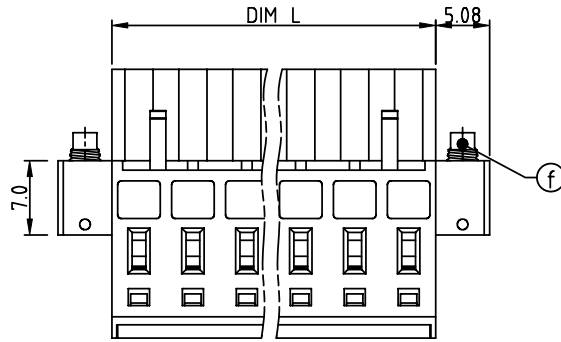

Material:

- Item (a) Terminal body: Thermoplastic (UL94V-0)
- Item (b) Terminal cover: Thermoplastic (UL94V-0)
- Item (c) Terminal spacer: Thermoplastic (UL94V-0)
- Item (d) Female contact: PhBz (CuSn) Tin plated
- Item (e) Spring clamp: Stainless Steel
- Item (f) Flange screw: Steel Zinc plating M2.5

Electrical: cULus

- Voltage rating: 300VAC
- Current rating: 10A
- Wire range:
- Solid wire(AWG): 12-26
- Stranded wire(AWG): 14-26
- Wire strip length: 9-10mm
- Withstanding Voltage: 1.6KV
- Operating temperature: -40°C to +115°C
- Safety Approval:

PART NO.: HN xx 50 x 2 00J0 G

DIMENSION

Dim P=(N-1)×5.08+15.24
Dim L=(N-1)×5.08+5.08
Dim B=(N-1)×5.08
Dim C=(N-1)×5.08+10.16

N=Number of poles

Poles	Tolerance
2P-6P	±0.15
7P-12P	±0.25
13P-18P	±0.35
19P-24P	±0.40

Solid block	No. of poles	Color	RoHS compliant (lead<4%) In copper Alloy
0	2	Black (RAL9005)	
02	2 poles	Red (RAL3001/D)	
03	3 poles	Orange(RAL2011/P)	
...	...	4 Yellow(RAL1018/A)	
...	...	5 Green(RAL6018/T)	
24	24 poles	6 Blue (RAL5015/A)	
		8 Grey(RAL7035/D)	
		9 White(RAL1102)	
		C Green(RAL6018/U)	

mat'l. code		surface ASME Y14.5	tolerance ASME Y14.5	projection	product family TERMINAL BLOCK
ltr	ecn no	dr	date		title TERMINAL BLOCK
				tolerances unless otherwise specified	scale MM
				angles X°±1°	scale X.XX±0.1
				dr	EVIN ZHONG 051414
				enr	EVIN ZHONG 051414
				chr	HANKE FENG 051414
				appd	SHI JUN 051414
sheet index	revision	A			dwg no HNxx50x200J0G
sheet	1				sheet 1 of 1
				type	CUSTOMER Drawing
				size	A4