

DISCRIPTION: DIP SOLDER MALE/STAMPED

**SPECIFICATIONS:**

**MATERIALS:**

SHELL: STEEL, NICKEL PLATED  
 INSULATOR: UL 94V-0 RATED BLACK NYLON 9T  
 CONTACT: BRASS WITH GOLD PLATING  
 RoHS COMPLIANT

**ELECTRICALS:**

CURRENT RATING: 5 AMPS  
 CONTACT RESISTANCE: 15 mOHMS MAX  
 INSULATOR RESISTANCE: 1000 MOHMS MIN  
 VOLTAGE: 500V AC FOR 1 MINUTE  
 TEMPERATURE: -50°C TO +100°C

POS.	A	B	C	D	E	F	G
9	1.213	0.984	0.666	0.756	0.329	0.109	0.496
	30.80	24.99	16.92	19.20	8.36	2.77	12.60
15	1.543	1.312	0.994	1.091	0.329	0.109	0.496
	39.19	33.32	25.25	27.70	8.36	2.77	12.60
25	2.087	1.852	1.534	1.618	0.329	0.109	0.496
	53.00	47.04	38.96	41.10	8.36	2.77	12.60
37	2.732	2.500	2.181	2.256	0.329	0.109	0.496
	69.30	63.50	55.42	57.30	8.36	2.77	12.60
50	2.638	2.406	2.079	2.169	0.445	0.109	0.606
	67.00	61.00	52.80	55.10	11.30	2.77	15.39

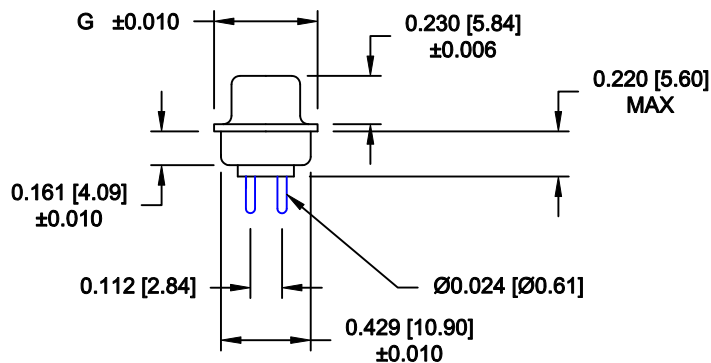
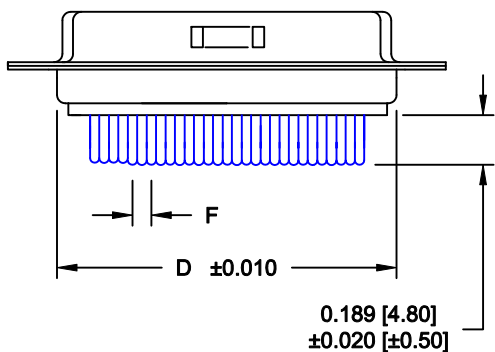
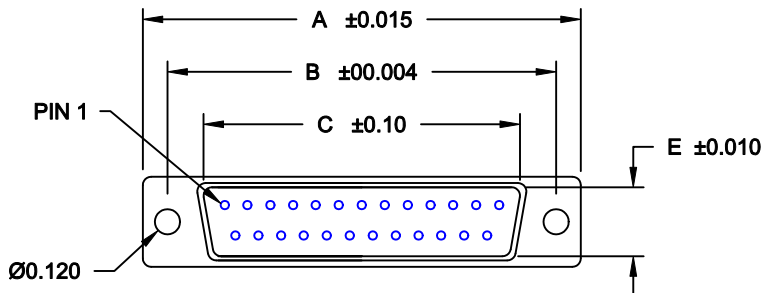

171-YYY-113RYY1

SERIES  
 POSITIONS  
 009  
 015  
 025  
 037  
 050  
 GENDER  
 1 = MALE  
 2 = FEMALE  
 TERMINATION  
 1 = DIP SOLDER  
 SHELL PLATING  
 3 = NICKEL  
 HARDWARE OPTIONS  
 00 = NO HARDWARE  
 01 = .098" 4-40 CLINCH NUT BOARD SIDE  
 02 = .236" 4-40 CLINCH NUT BOARD SIDE  
 03 = .236" 4-40 CLINCH NUT MATING SIDE  
 05 = .237" 4-40 BOARD LOCK  
 08 = .228" 4-40 BOARD LOCK  
 90 = .237" 4-40 BOARD LOCK  
 FOR 0.093" BOARD  
 91 = .237" 4-40 SPACER/BOARD LOCK  
 92 = .237" 4-40 SPACER/BOARD LOCK  
 FOR 0.093" BOARD  
 PLATING OPTIONS  
 1 = GOLD FLASH  
 2 = 30 MICRO-INCH GOLD

DO NOT SCALE FROM DRAWING



THESE DRAWINGS AND SPECIFICATIONS ARE THE PROPERTY OF NorComp AND SHALL NOT BE REPRODUCED, COPIED OR USED AS THE BASIS FOR THE MANUFACTURE OF SALE OF APPARATUS WITHOUT WRITTEN PERMISSION.

DRAWN: PAM JENKINS

DATE: 9-12-05

CHECKED:

DATE:

SCALE:

SHEET 1 OF 3 REV 11

DWG NO.

171-YYY-113RYY1

NorComp

RoHS COMPLIANT

DESCRIPTION: PCB LAYOUT - STANDARD "D" - MALE & FEMALE

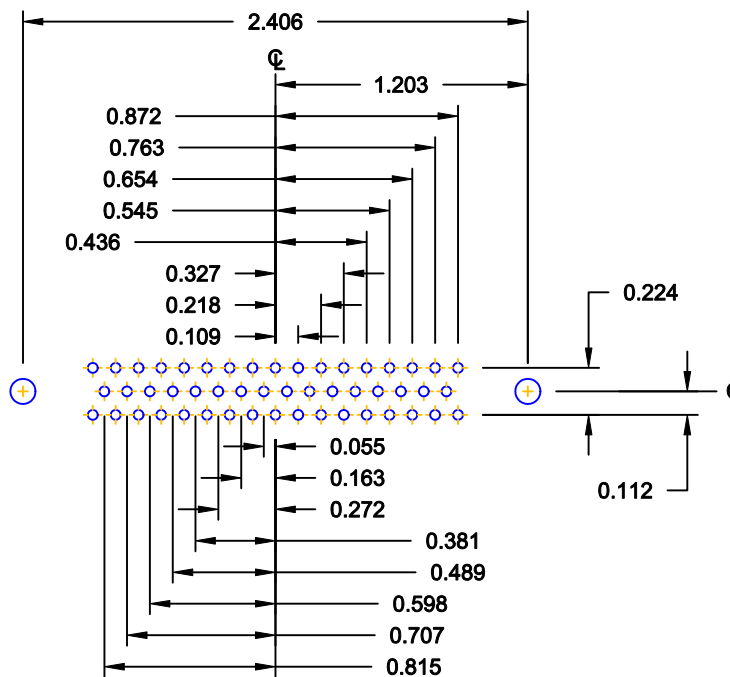
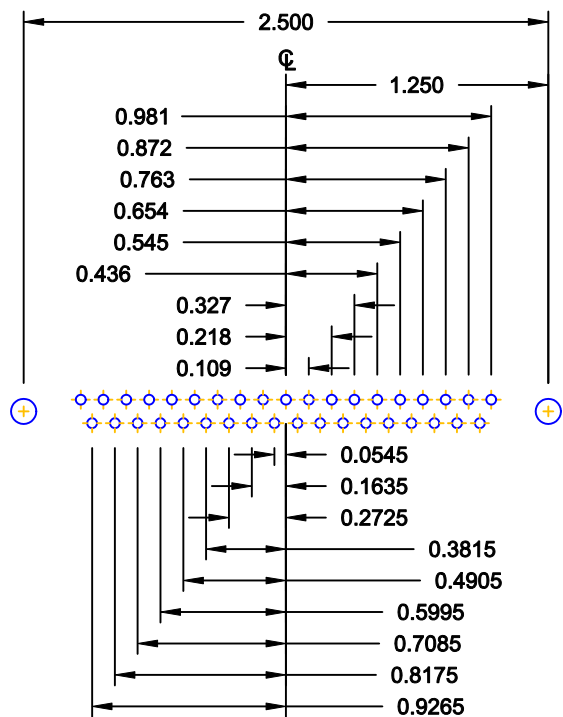
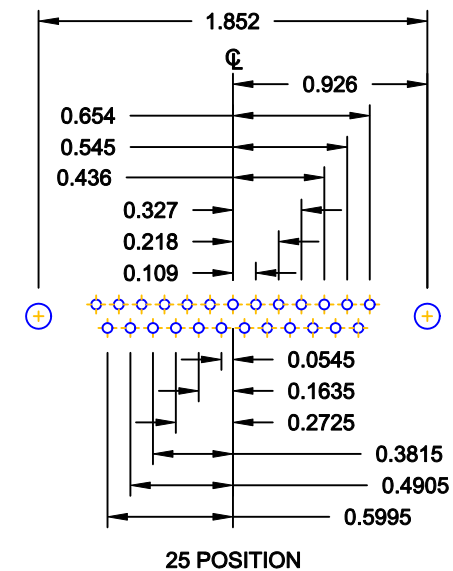
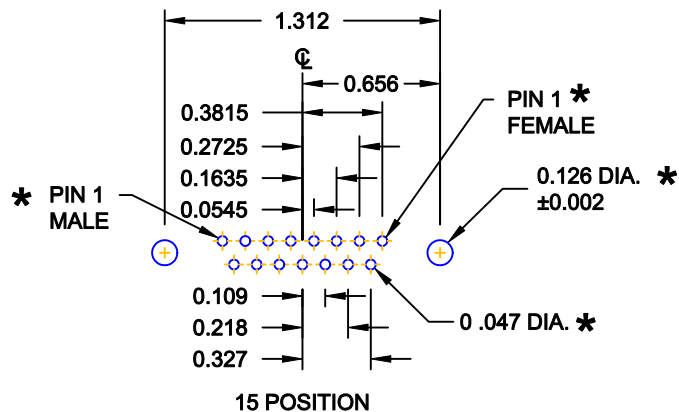
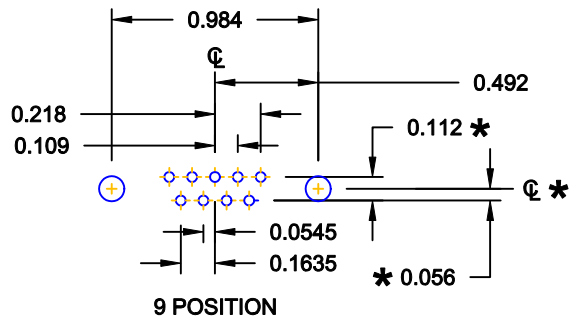

\* TYP. ON ALL SIZES

DO NOT SCALE FROM DRAWING



THESE DRAWINGS AND SPECIFICATIONS ARE THE PROPERTY OF NorComp AND SHALL NOT BE REPRODUCED, COPIED OR USED AS THE BASIS FOR THE MANUFACTURE OF SALE OF APPARATUS WITHOUT WRITTEN PERMISSION.

DRAWN: <b>C. SMITH</b>		DATE: <b>03-08-06</b>	
CHECKED:		DATE:	
SCALE: <b>FULL</b>	SHEET <b>2</b>	OF <b>3</b>	REV <b>11</b>
DWG NO. <b>171-YYY-113RYY1</b>			

**NorComp**

ALL CLINCH-NUTS ARE 4-40 INTERNAL THREADS

TOLERANCE:  
ALL DIMENSIONS ARE ±0.010

01X ..... 0.098" (BOARD SIDE) - CN1

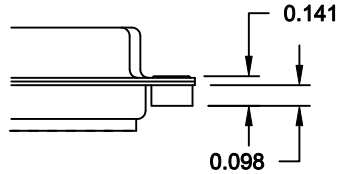

02X ..... 0.236" (BOARD SIDE) - CN2

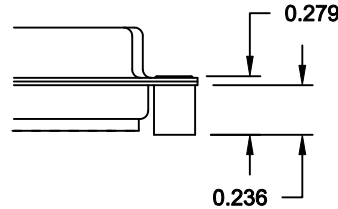

03X..... 0.236" (MATING SIDE) - CN8

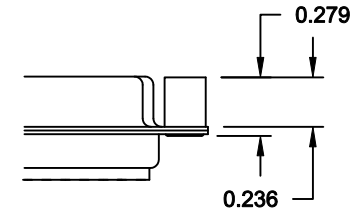

05X ..... 0.237" (BOARD SIDE) - CN10

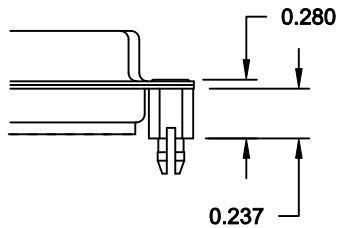

08X ..... 0.228" (BOARD SIDE) - CN3

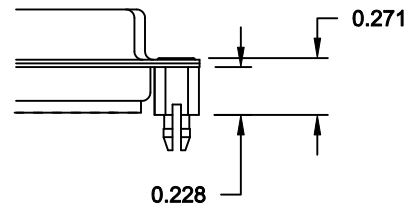

91X ..... 0.237" BOARD SIDE  
0.197" MATING SIDE  
CN10/SFSO4404

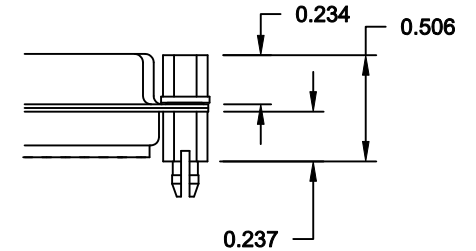

90X ..... 0.237" (BOARD SIDE) - CN10-237-093

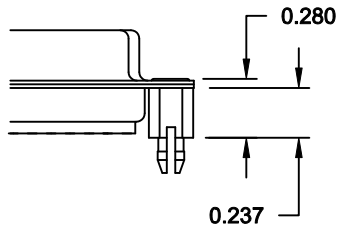

92X ..... 0.237" BOARD SIDE  
0.197" MATING SIDE  
CN10-237-093/SFSO4404

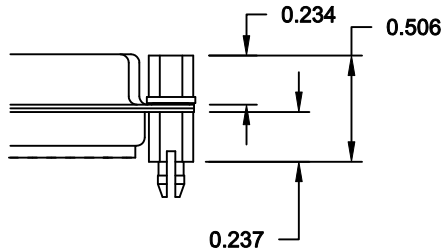

NOTE: 4-40 FEMALE SCREW LOCK IS REMOVABLE

NOTE: 4-40 FEMALE SCREW LOCK IS REMOVABLE

NOTE: 90 & 92 OPTION FOR 0.093" MAX. BOARD THICKNESS

DO NOT SCALE FROM DRAWING

RoHS COMPLIANT

	THESE DRAWINGS AND SPECIFICATIONS ARE THE PROPERTY OF NorComp AND SHALL NOT BE REPRODUCED, COPIED OR USED AS THE BASIS FOR THE MANUFACTURE OF SALE OF APPARATUS WITHOUT WRITTEN PERMISSION.		DRAWN: <b>WAYNE ROBBINS</b>	DATE: <b>11-28-05</b>	
	<h1>NorComp</h1>			CHECKED:	DATE:
SCALE:				SHEET <b>3</b> OF <b>3</b>	REV <b>11</b>
DWG NO. <b>171-YYY-113RYY1</b>					