

LOC	DIST	REVISIONS			
P	LTN	DESCRIPTION	DATE	DWN	APVD
1		INITIAL RELEASED	31JAN2015	CW	SH
3		REVISE BOM	28AUG2015	AD	SH
4		REVISE PCB PROHIBITING AREA	18SEP2016	AD	SH

- △ MATERAIL : CAGE :0.4MM THICK NICKEL SILVER ALLOY;  
 EMI SPRING: COPPER ALLOY;  
 HEAT SINK CLIP: STAINLESS STEEL;  
 HEAT SINK:ALUMINUM ALLOY;  
 RECEPTACLE COVER:ZINC ALLOY;
- △ FINISH: EMI SPRING 1.27um NICKEL PALTING OVER ALL;  
 HEAT SINK:BLACK ANODIZED COATING;  
 RECEPTACLE COVER: 1.27um MIN NICKEL PLATING OVER COPPER PLATING;  
 HEAT SINK CLIP: PASSIVATE;
- 3.MATES WITH CFP MSA COMPLIANT TRANSCEIVERS.
- △ DATUM AND BASIC DIMENSION ESTABLISHED BY CUSTOMER.
- 5.MINIMUM PC BOARD THICKNESS: SIGLE SIDE APPLICATIONS=2.99±0.63mm.
- △.PADS AND VIAS CHASSIS GROUND;
- △:REFFERENCE APPLICATION SPEC 114-32146,HOLE A, FOR  
 RECOMMENDED DRILL HOLE DIAMETER AND PLATING THICKNESS.

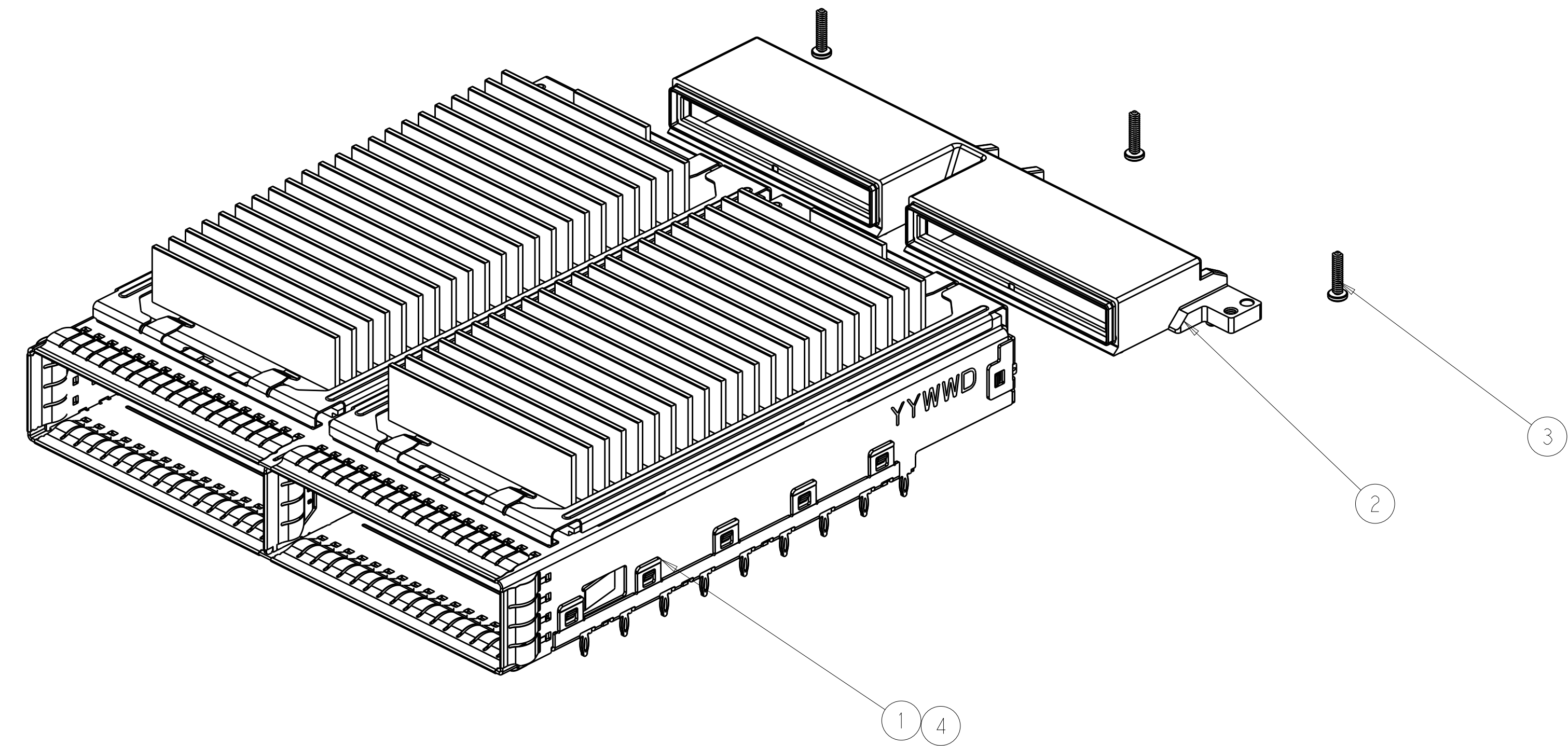

THIS PRINT IS  
**PRELIMINARY**  
 UNQUALIFIED PRODUCT  
 CONTACT PRODUCT ENGINEERING  
 BEFORE USING THIS PRINT

1	-	2293288-2	CAGE ASSEMBLY WITH H/S,CFP2 1X2	4
3	3	2292789-1	SCREW	3
1	1	2287077-1	RECEPTACLE COVER ASSEMBLY	2
-	1	2293288-1	CAGE ASSEMBLY WITH H/S,CFP2 1X2	1
-2	-1	PAR NUMBER	DESCRIPTION	ITEM

THIS DRAWING IS A CONTROLLED DOCUMENT.		DWN: 31JAN2015	<b>PRELIMINARY</b>	
DIMENSIONS: mm		CHK: Charles Wang 31JAN2015		
TOLERANCES UNLESS OTHERWISE SPECIFIED:		APVD: Sean Han 31JAN2015	NAME: CFP2 HARDWARE AND RECEPTACLE ASSEMBLY, 1X2	
0 PLC ±.025		PRODUCT SPEC: 108-32103	SIZE: A1	
2 PLC ±0.13		APPLICATION SPEC: 114-32146	CAGE CODE: -	
3 PLC ±0.10		WEIGHT: -	DRAWING NO: C=2287075	
4 PLC ±.		RESTRICTED TO: -	SCALE: 1:1	
ANGLES ±.		Customer Drawing	SHEET 1 OF 7	
FINISH: △			REV 4	

LOC		DIST		REVISIONS			
P	LYR	DESCRIPTION	DATE	OWN	APVD		
-	-	SEE SHEET 1	-	-	-	-	-

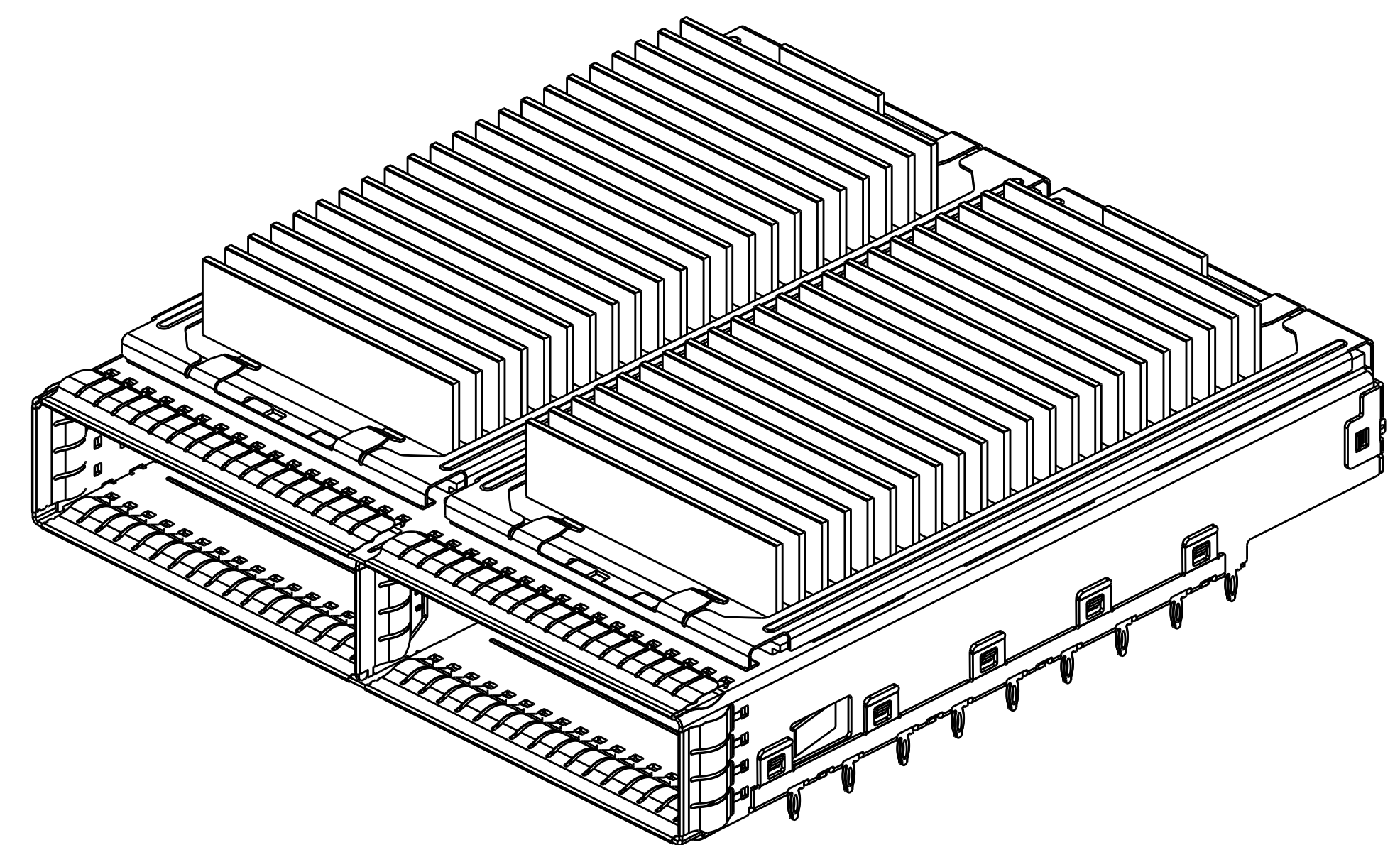
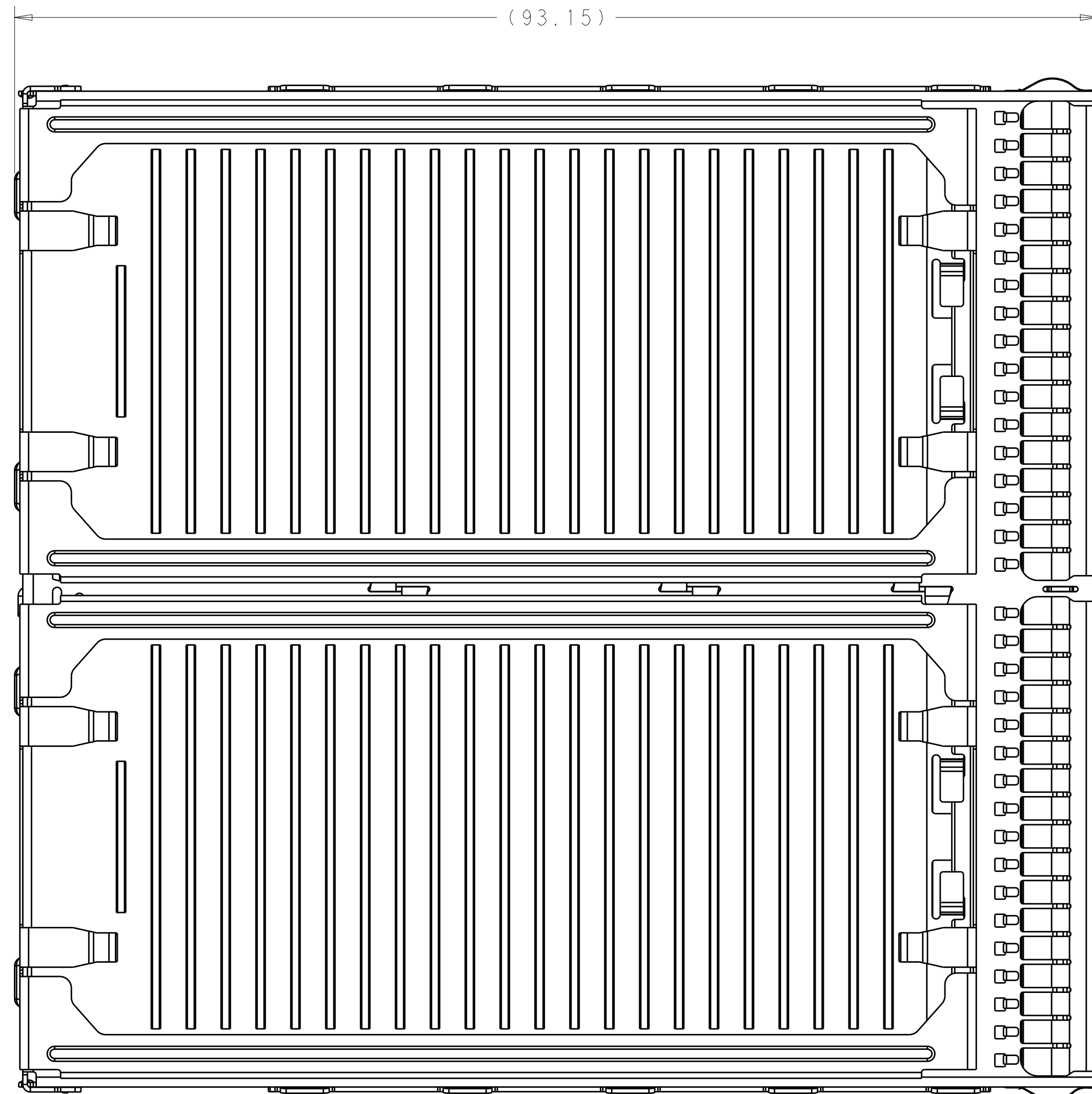

SCALE 2:1

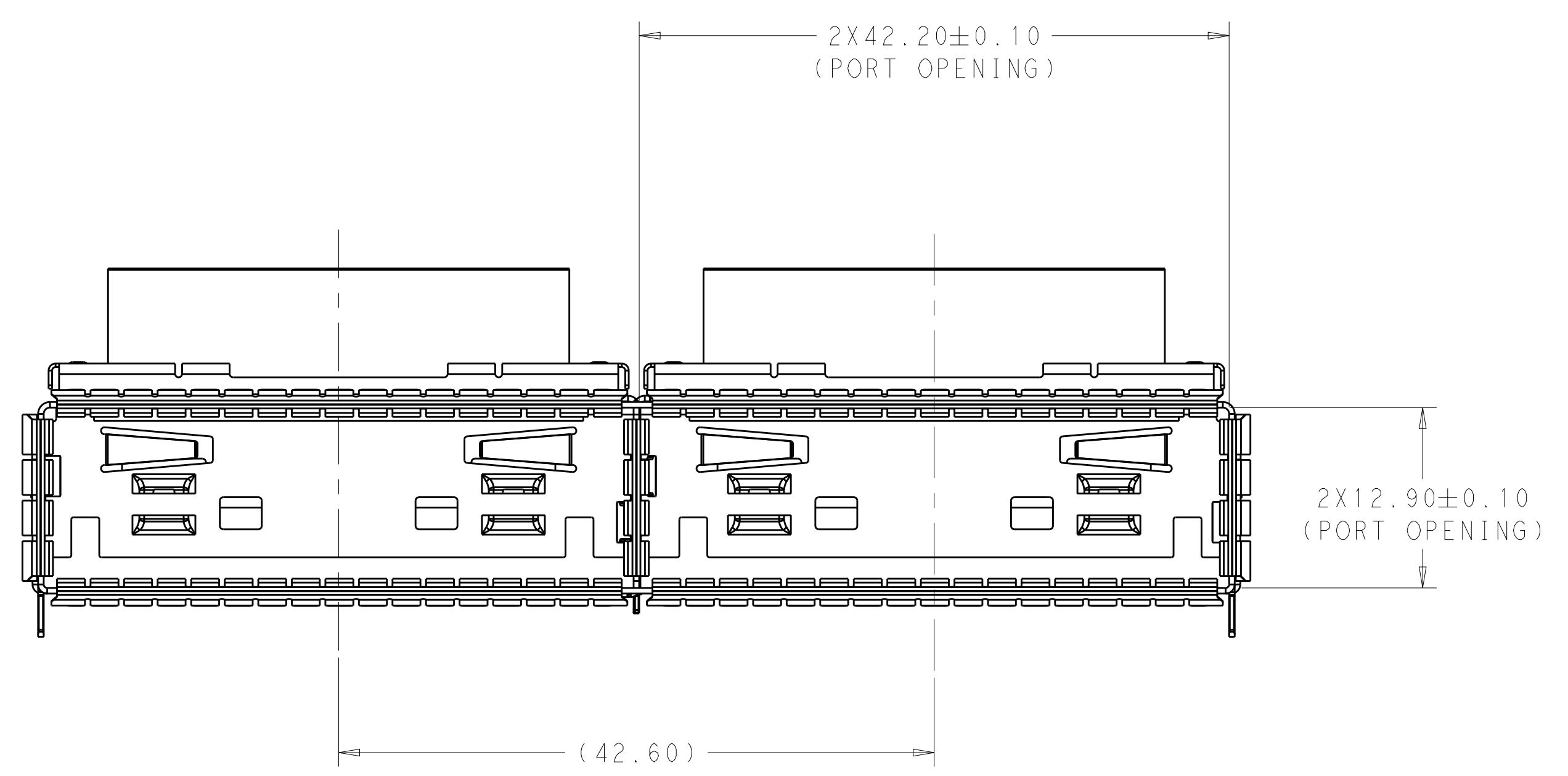
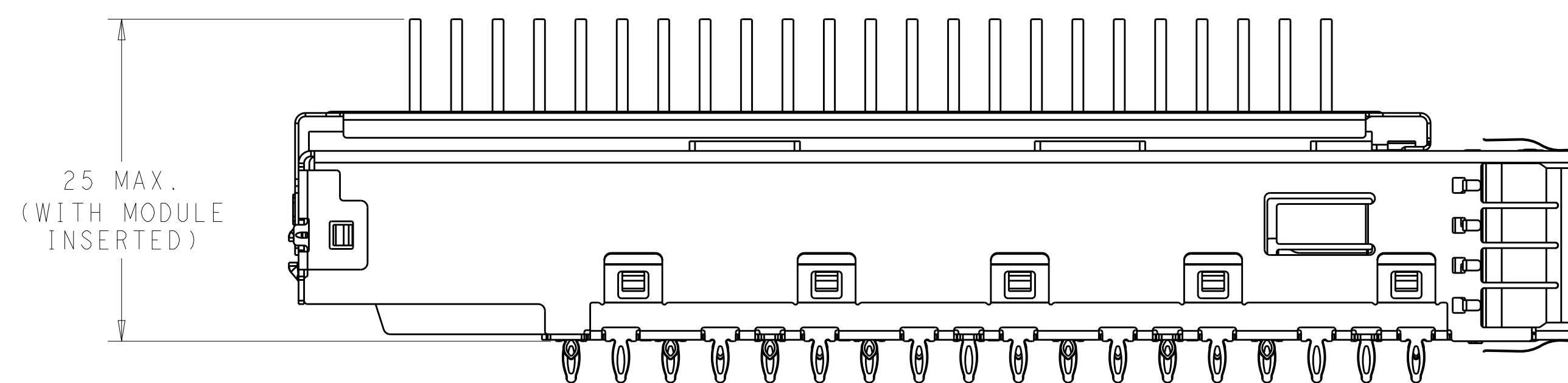

2293288-1 AS SHOWN

THIS PRINT IS  
**PRELIMINARY**  
 UNQUALIFIED PRODUCT  
 CONTACT PRODUCT ENGINEERING  
 BEFORE USING THIS PRINT

THIS DRAWING IS A CONTROLLED DOCUMENT.		OWN Charles Wan 31JAN2015	TE Connectivity
DIMENSIONS:		CHK Sean Han 31JAN2015	
mm	TOLERANCES UNLESS OTHERWISE SPECIFIED:	APVD Sean Han 31JAN2015	NAME CFP2 HARDWARE AND RECEPTACLE ASSEMBLY, 1X2
0 PLC ± 1 PLC ±0.25 2 PLC ±0.13 3 PLC ±0.10 4 PLC ± ANGLES ±	FINISH	PRODUCT SPEC	SIZE A1
MATERIAL		APPLICATION SPEC	CAGE CODE C=2287075
		WEIGHT	RESTRICTED TO
		Customer Drawing	SCALE 3:1 SHEET 2 OF 7 REV 4

LOC	DIST	REVISIONS			
P	LYR	DESCRIPTION	DATE	DWN	APVD
-	-	SEE SHEET 1	-	-	-

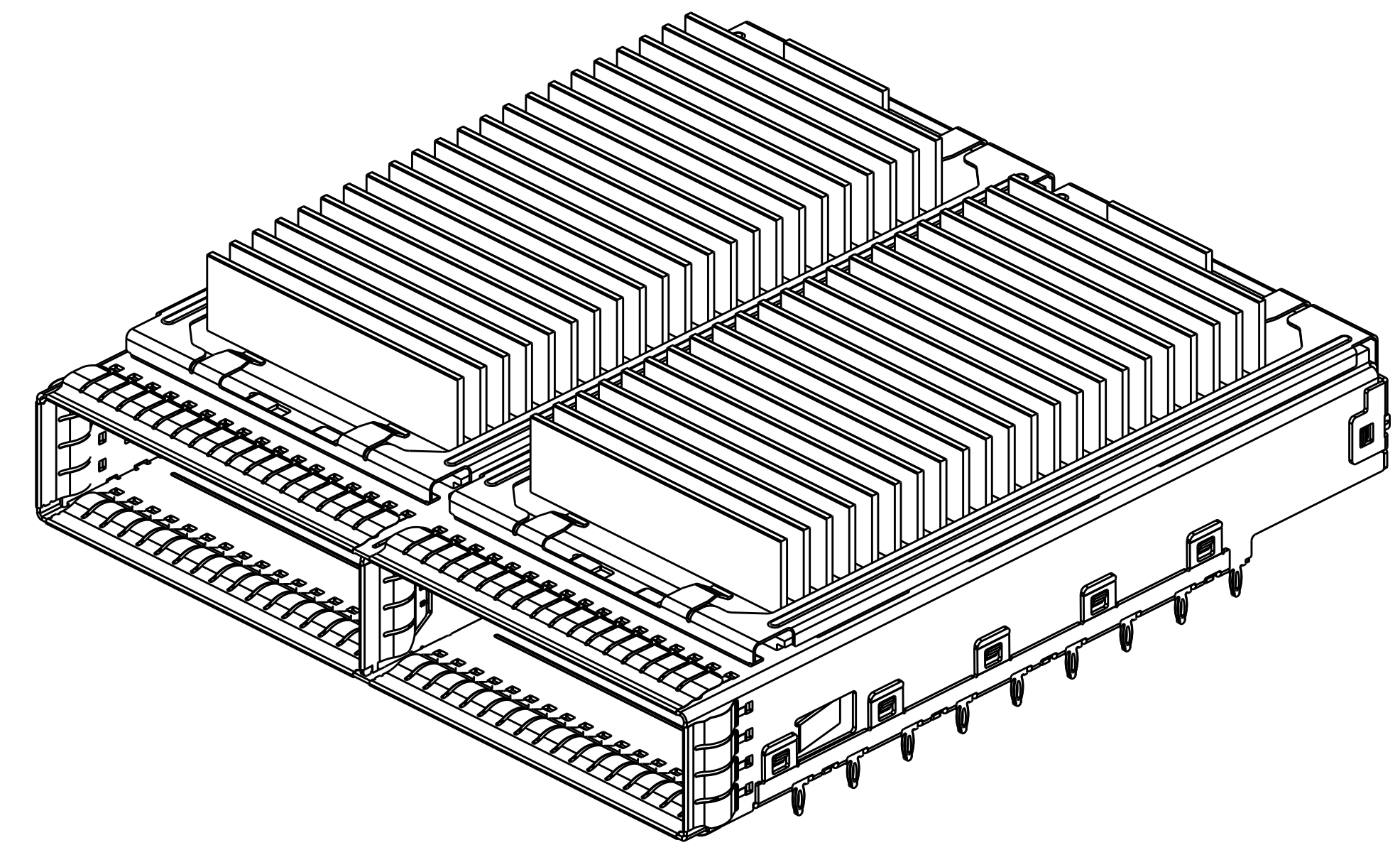

2293288-1

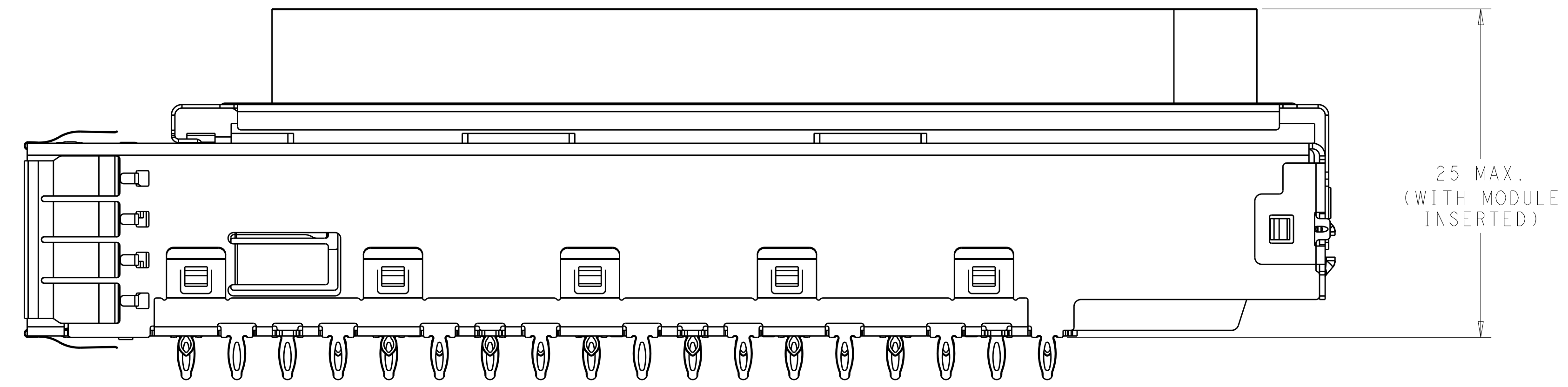

2293288-2  
 OTHER DIMENSIONS  
 SAME AS 2293288-1  
 SCALE 4:1

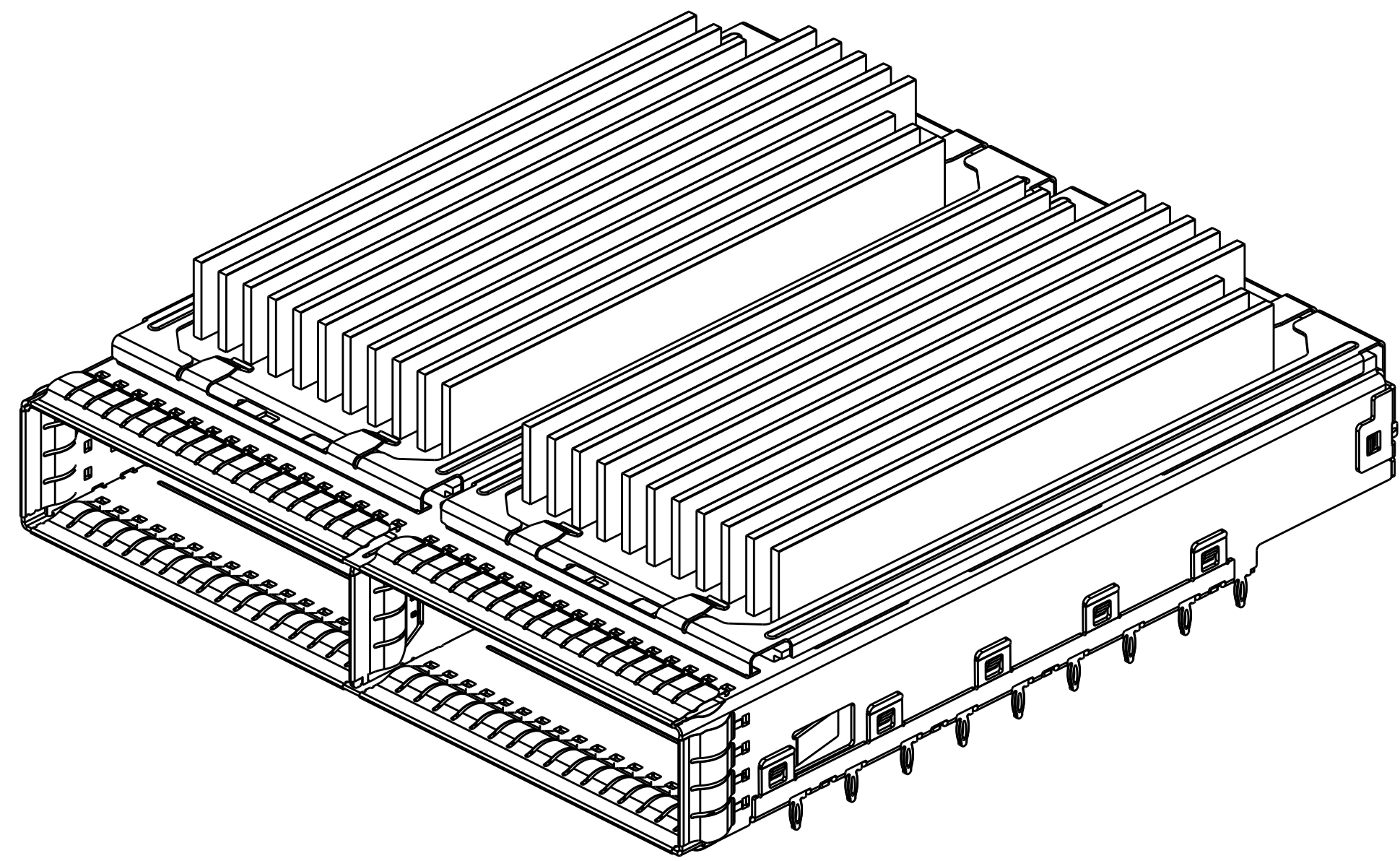

2293288-2

THIS PRINT IS  
**PRELIMINARY**  
 UNQUALIFIED PRODUCT  
 CONTACT PRODUCT ENGINEERING  
 BEFORE USING THIS PRINT

THIS DRAWING IS A CONTROLLED DOCUMENT.		DWN Charles Wan 31JAN2015	TE Connectivity
DIMENSIONS:		CHK Sean Han 31JAN2015	
mm	TOLERANCES UNLESS OTHERWISE SPECIFIED:	APVD Sean Han 31JAN2015	NAME CFP2 HARDWARE AND RECEPTACLE ASSEMBLY, 1X2
0 PLC	±	PRODUCT SPEC	SIZE A1
1 PLC	±0.25	APPLICATION SPEC	CAGE CODE -
2 PLC	±0.13	WEIGHT	DRAWING NO C=2287075
3 PLC	±0.10	RESTRICTED TO	SCALE 4:1
4 PLC	±	Customer Drawing	SHEET 3 OF 7
ANGLES	±		REV 4
MATERIAL	FINISH		

LOC		DIST		REVISIONS			
GP	00	P	LTN	DESCRIPTION	DATE	DMN	APVD
-	-	-	-	SEE SHEET 1	-	-	-

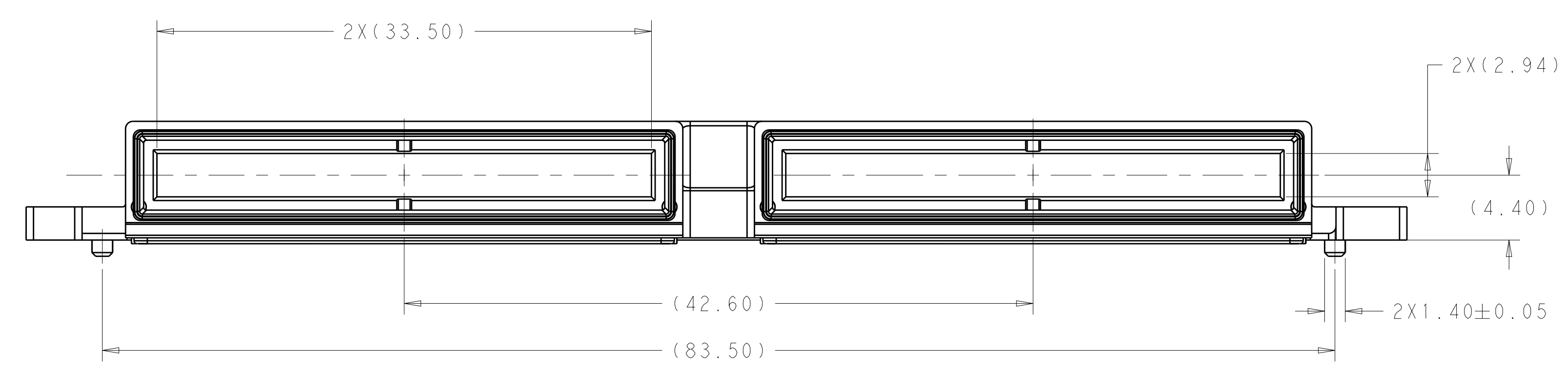
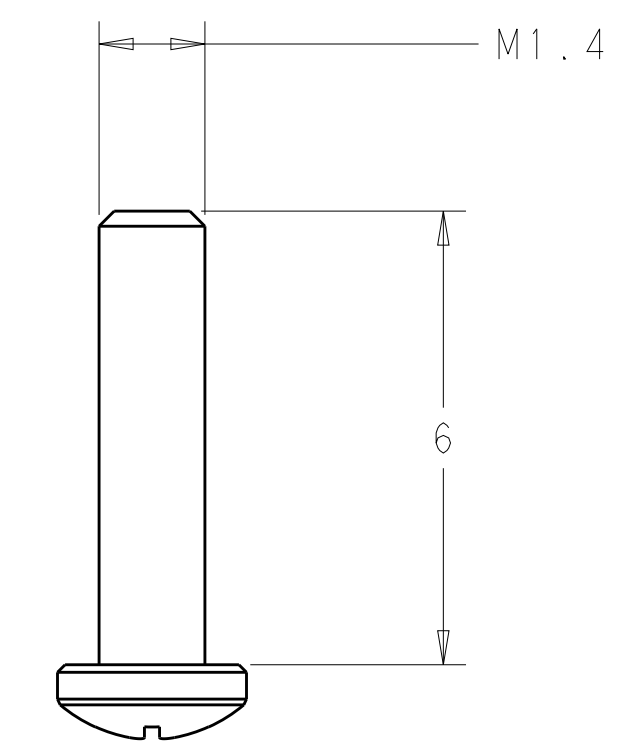
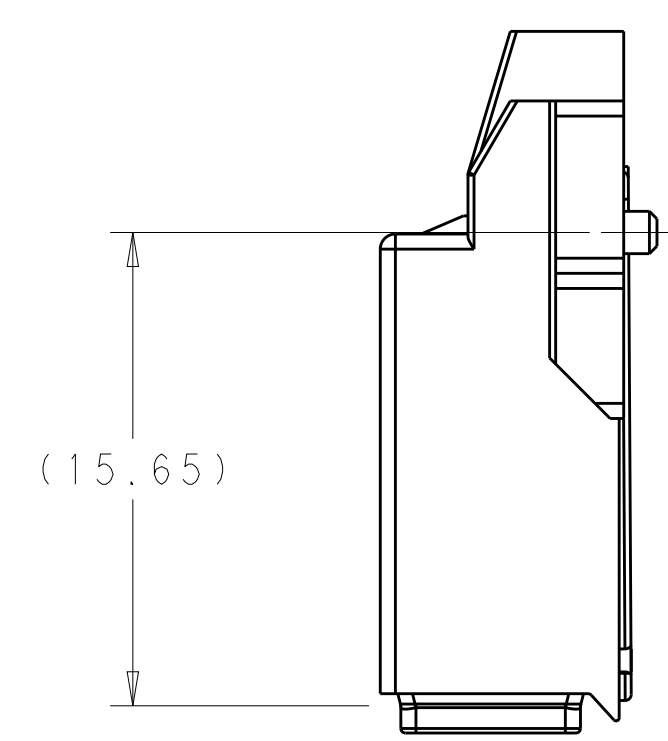
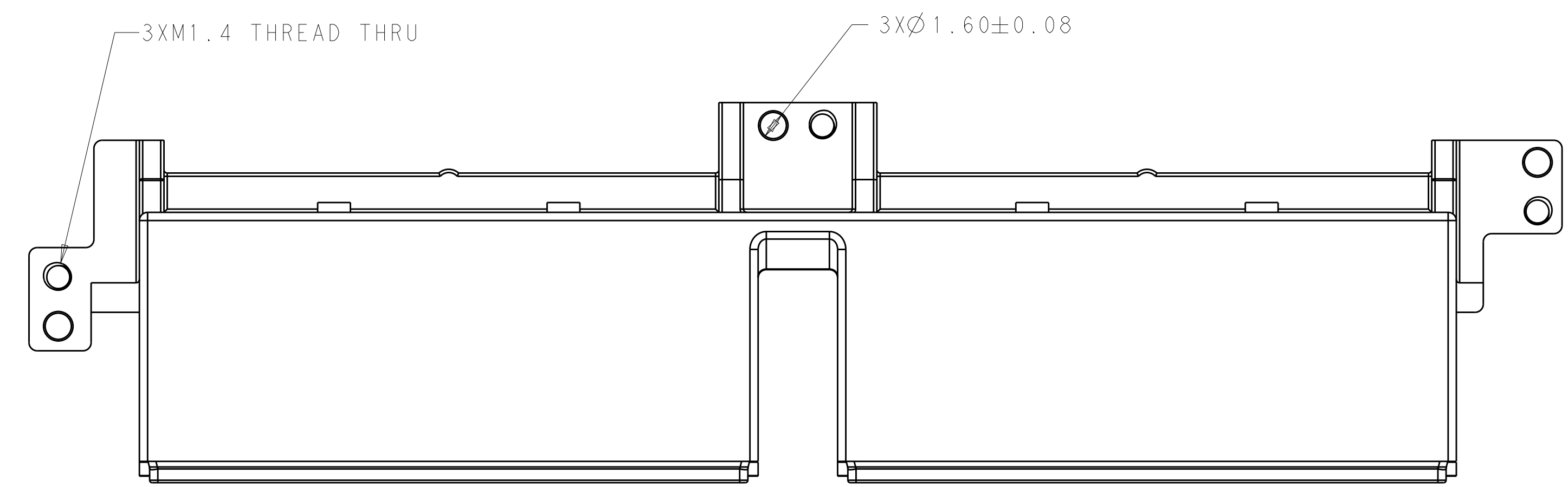

2292789-1  
 SCALE 10:1

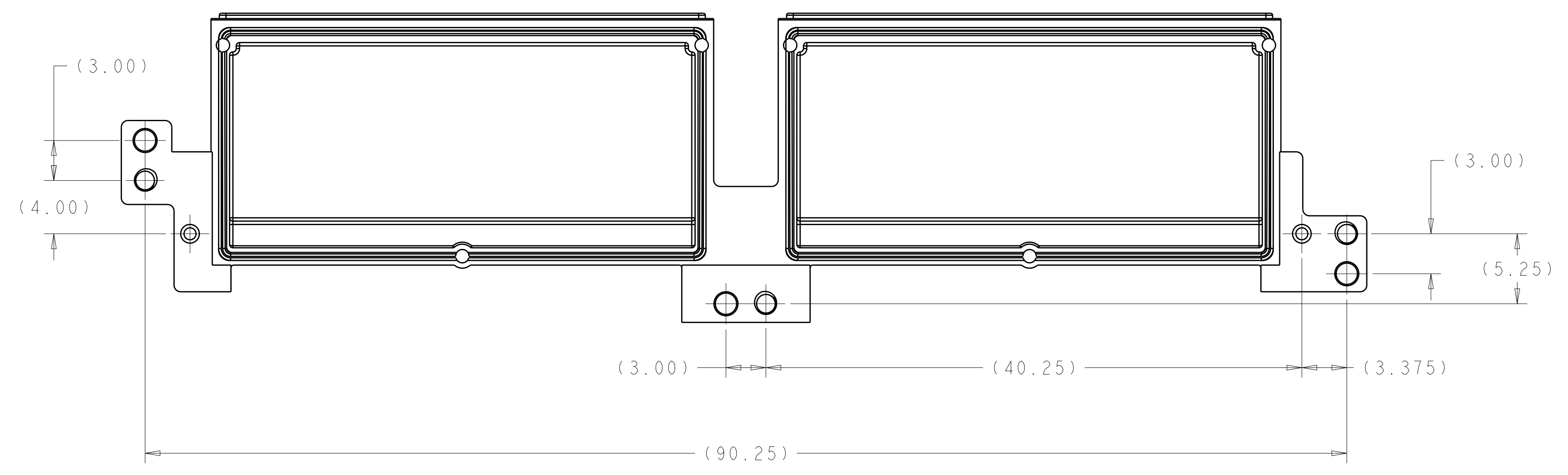

THIS PRINT IS  
**PRELIMINARY**  
 UNQUALIFIED PRODUCT  
 CONTACT PRODUCT ENGINEERING  
 BEFORE USING THIS PRINT

2287077-1

THIS DRAWING IS A CONTROLLED DOCUMENT.		DMN Charles Wan 31JAN2015	TE Connectivity	
DIMENSIONS: mm		CHK Sean Han 31JAN2015		
TOLERANCES UNLESS OTHERWISE SPECIFIED:		APVD Sean Han 31JAN2015	NAME CFP2 HARDWARE AND RECEPTACLE ASSEMBLY, 1X2	
0 PLC ±0.25	1 PLC ±0.13	PRODUCT SPEC	SIZE A1	
2 PLC ±0.10	3 PLC ±0.10	APPLICATION SPEC	CAGE CODE DRAWING NO. -	
4 PLC ±0.10	ANGLES ±0.5°	WEIGHT	RESTRICTED TO	
FINISH		Customer Drawing	SCALE 4:1 SHEET 4 OF 7 REV 4	



LOC		DIST		REVISIONS			
GP	00	P	LTH	DESCRIPTION	DATE	DMN	APVD
-	-	-	-	SEE SHEET 1	-	-	-

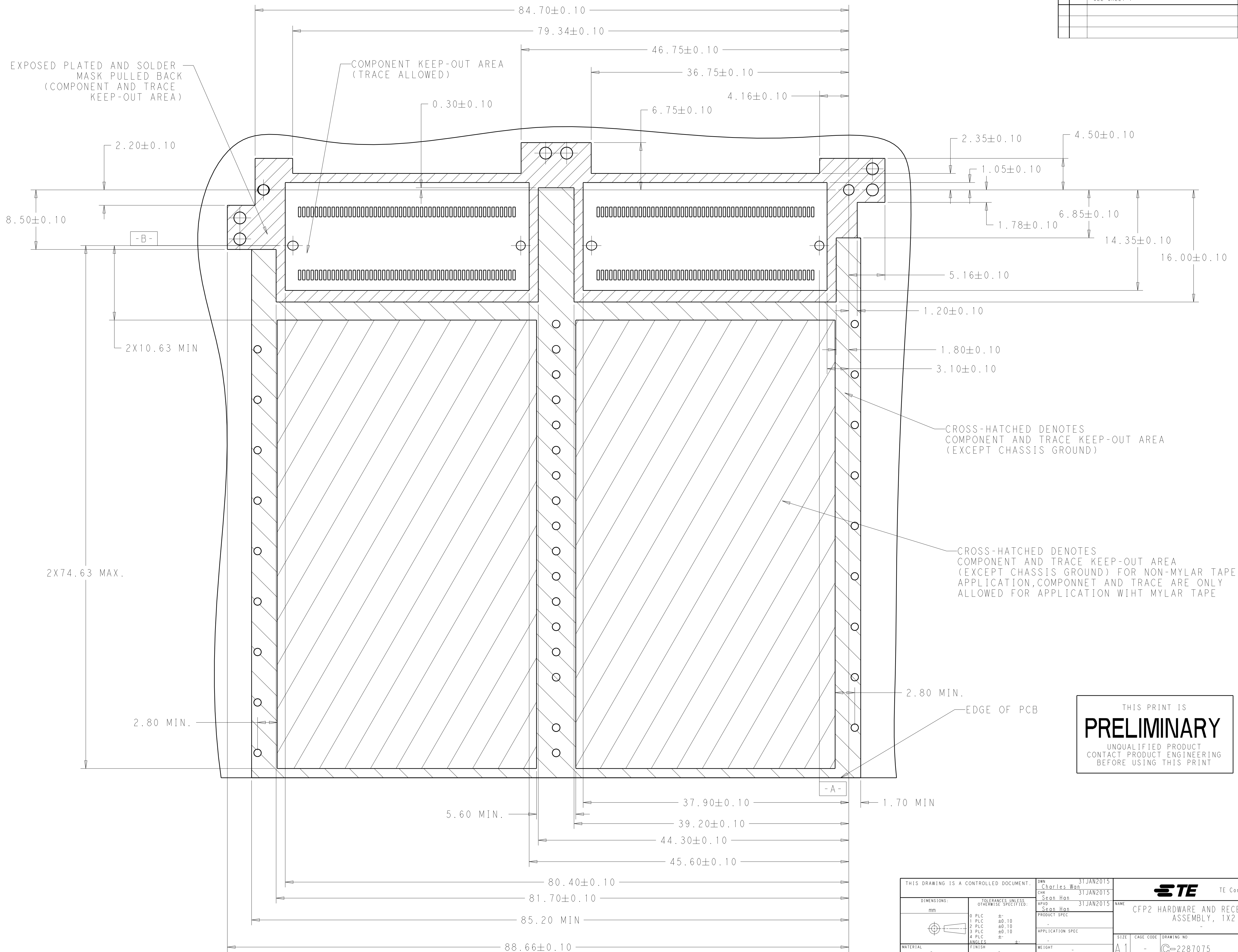

THIS PRINT IS  
**PRELIMINARY**  
 UNQUALIFIED PRODUCT  
 CONTACT PRODUCT ENGINEERING  
 BEFORE USING THIS PRINT

THIS DRAWING IS A CONTROLLED DOCUMENT.		DMN Charles Wan 31JAN2015	TE Connectivity												
DIMENSIONS: mm		CHK Sean Han 31JAN2015													
TOLERANCES UNLESS OTHERWISE SPECIFIED:		APVD Sean Han 31JAN2015	NAME CFP2 HARDWARE AND RECEPTACLE ASSEMBLY, 1X2												
<table border="1"> <tr><td>0 PLC</td><td>±</td></tr> <tr><td>1 PLC</td><td>±0.10</td></tr> <tr><td>2 PLC</td><td>±0.10</td></tr> <tr><td>3 PLC</td><td>±0.10</td></tr> <tr><td>4 PLC</td><td>±0.10</td></tr> <tr><td>ANGLES</td><td>±</td></tr> </table>		0 PLC	±	1 PLC	±0.10	2 PLC	±0.10	3 PLC	±0.10	4 PLC	±0.10	ANGLES	±	PRODUCT SPEC	SIZE A1
0 PLC	±														
1 PLC	±0.10														
2 PLC	±0.10														
3 PLC	±0.10														
4 PLC	±0.10														
ANGLES	±														
MATERIAL		APPLICATION SPEC	CAGE CODE DRAWING NO												
FINISH		WEIGHT	RESTRICTED TO												
		Customer Drawing	SCALE 1:1 SHEET 6 OF 7 REV 4												

LOC	DIST	REVISIONS			
P	LTN	DESCRIPTION	DATE	DMN	APVD
-	-	SEE SHEET 1	-	-	-

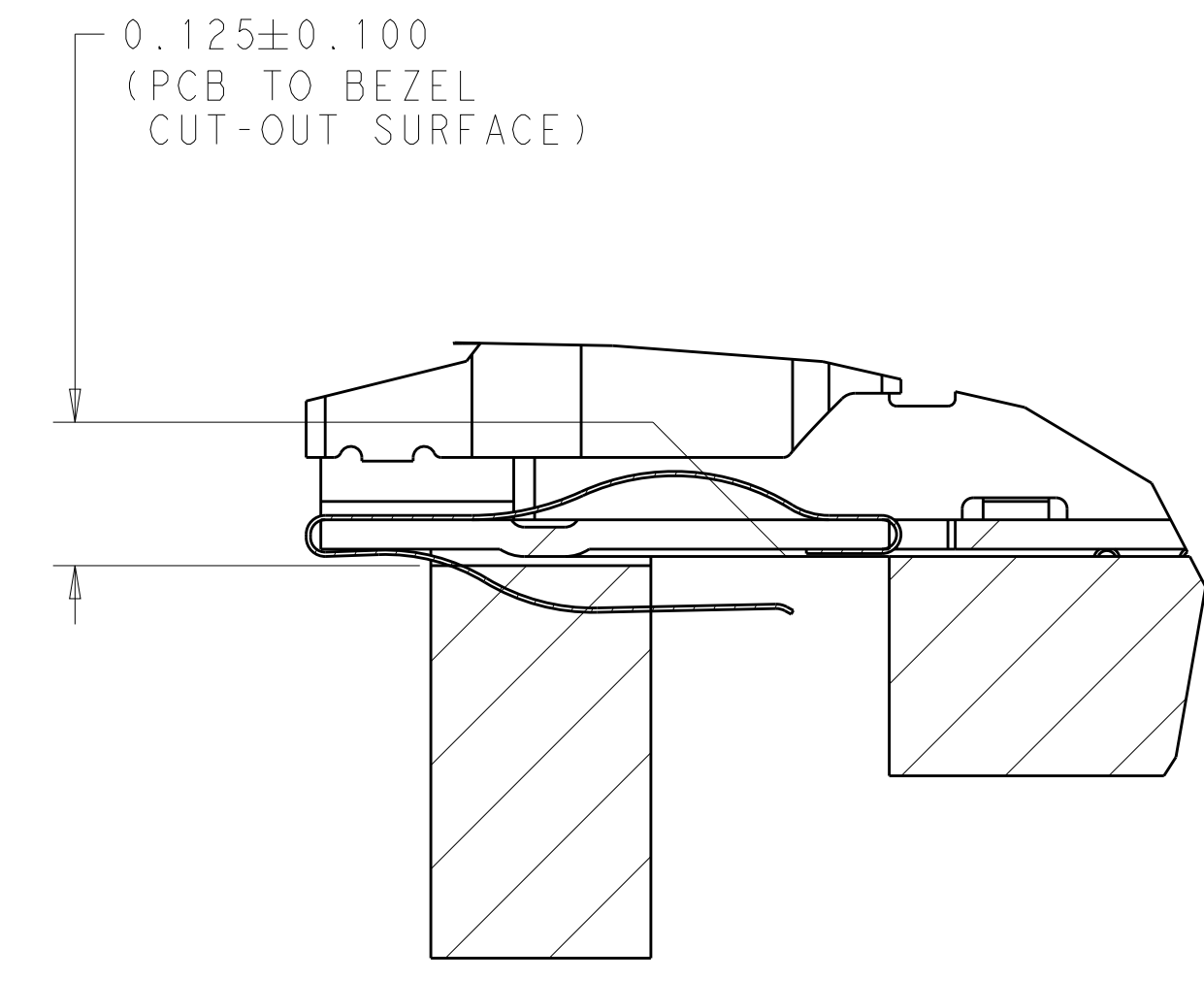
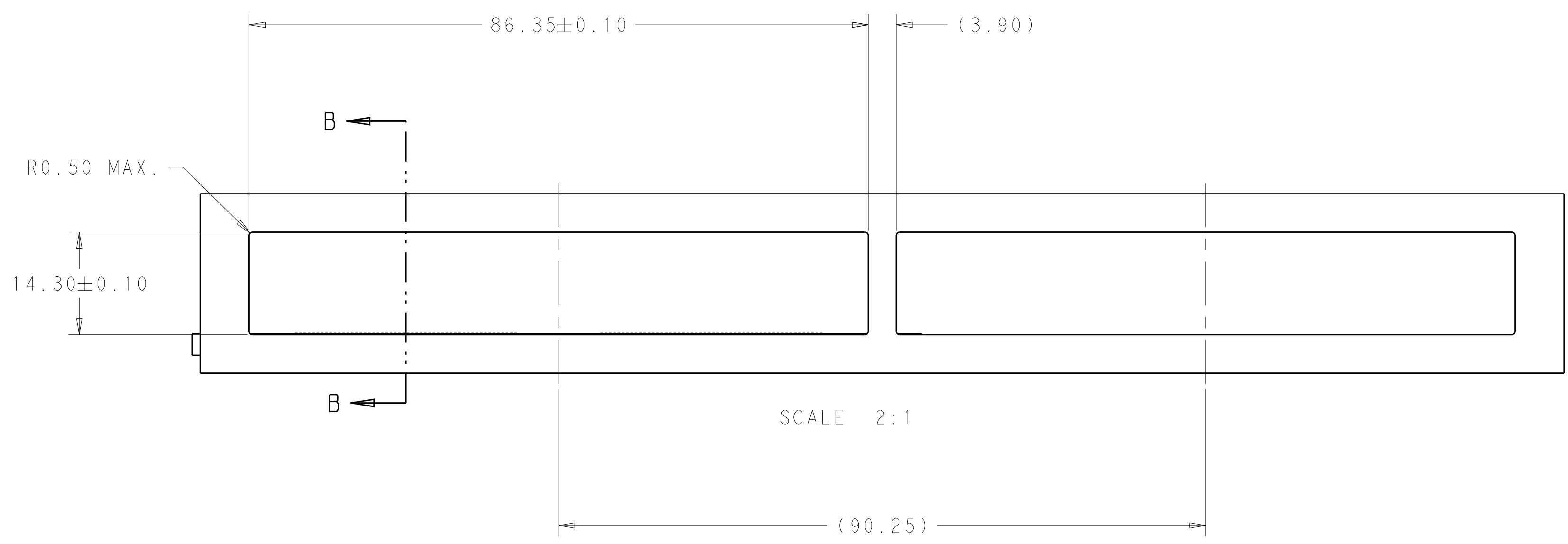

DETAIL E  
 SCALE 10:1

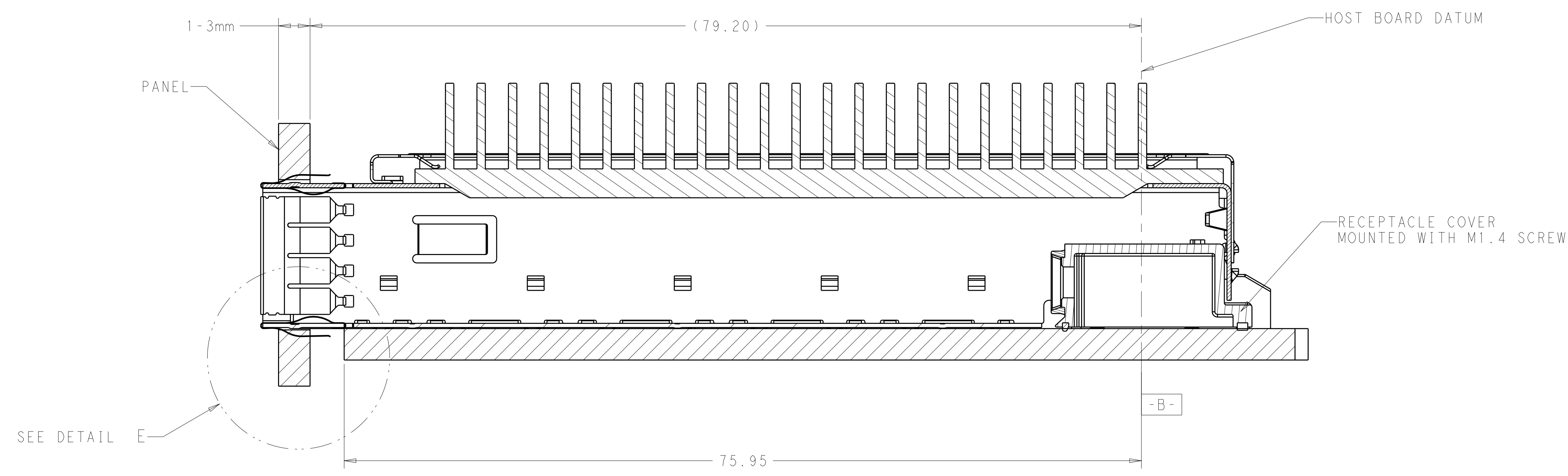

SECTION B-B  
 SCALE 4:1

SEE DETAIL E

THIS PRINT IS  
**PRELIMINARY**  
 UNQUALIFIED PRODUCT  
 CONTACT PRODUCT ENGINEERING  
 BEFORE USING THIS PRINT

THIS DRAWING IS A CONTROLLED DOCUMENT.		DMN Charles Wan 31JAN2015	TE Connectivity
DIMENSIONS: mm		CHK Sean Han 31JAN2015	
TOLERANCES UNLESS OTHERWISE SPECIFIED:		APVD Sean Han 31JAN2015	NAME CFP2 HARDWARE AND RECEPTACLE ASSEMBLY, 1X2
0 PLC ±0.25	1 PLC ±0.13	PRODUCT SPEC	SIZE A1
2 PLC ±0.10	3 PLC ±0.10	APPLICATION SPEC	CAGE CODE -
4 PLC ±0.10	ANGLES ±0.5°	WEIGHT -	DRAWING NO. C=2287075
MATERIAL -	FINISH -	Customer Drawing	RESTRICTED TO -
SCALE 1:1			SHEET 7 OF 7
REV 4			