

4

3

2

1

REVISIONS				
ZONE	LTR	DESCRIPTION	DATE	APPROVED
-	N/C	INITIAL RELEASE, ECN#T-4209	7-13-83	YB

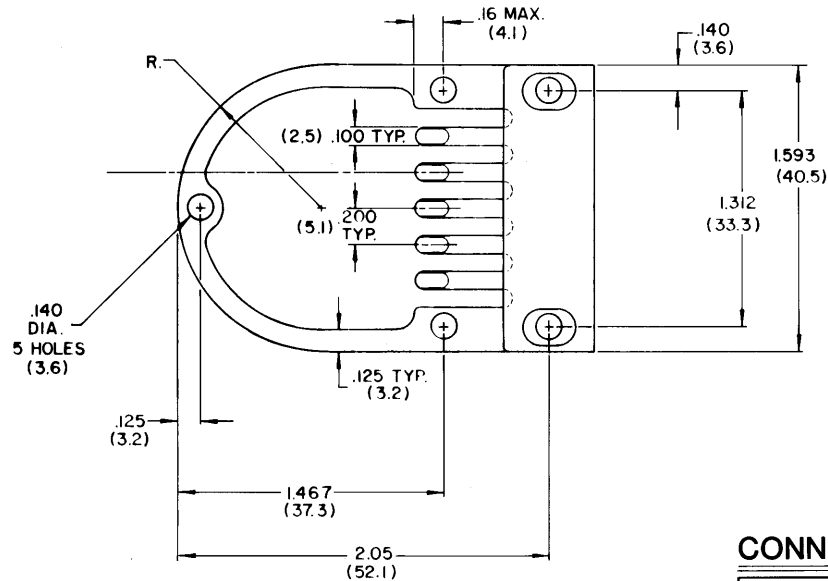
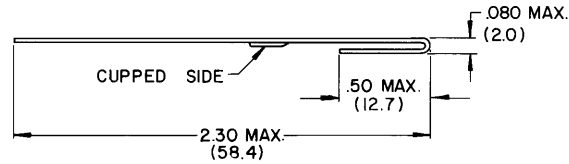

NOTES:

1. TERMINATING BUSS MATERIAL:
.020 COPPER ALLOY TIN PLATED.
2. BUSS TABS ARE DESIGNED TO
TERMINATE THE FOLLOWING SHIELDED CABLE
CONSTRUCTIONS:
88BIII, 20 THRU 26 AWG
88BII2, 20 THRU 26 AWG
88BII3, 20 THRU 26 AWG
88BII4, 20 THRU 26 AWG

© Raychem Corporation 1983

CONNECTOR SPECIFICATION CONTROL DRAWING

UNLESS OTHERWISE SPECIFIED DIMENSIONS ARE IN INCHES BRACKETED DIMENSIONS () ARE METRIC AND TOLERANCES ARE: .xxx: ± .010 .xx: ± .03 Δ: ±	DRAWN	PIERCE	6-83	Raychem <small>RAYCHEM CORPORATION 300 CONCHLETTA DRIVE MENLO PARK, CALIFORNIA 94025</small>			
	CHECKED	<i>[Signature]</i>	6-23-83				
	APPROVED	<i>[Signature]</i>	7-13-83	TITLE SHIELD, EMI BACKSHELL			
	APPROVED	<i>[Signature]</i>	1-19-83				
				SIZE C	CODE IDENT NO. 06090	DWG. NO. D-659-0088	
					WEIGHT	SHEET	OF

If this document is printed it becomes uncontrolled.
Check with the web for latest revision.

DO NOT SCALE THIS DRAWING