

THIS DRAWING IS UNPUBLISHED. RELEASED FOR PUBLICATION
 © COPYRIGHT - By - ALL RIGHTS RESERVED.

REVISIONS					
P	LTR	DESCRIPTION	DATE	DWN	APVD
	C1	REVISED PER ECR-16-007444	30MAY2016	NK	SC

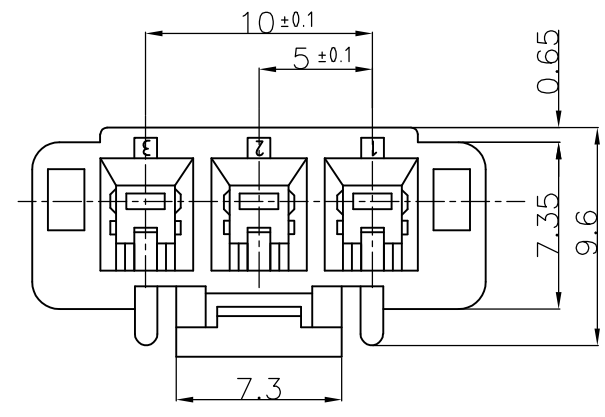

THE TYPE OF KEYING

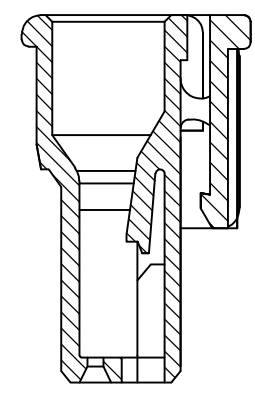
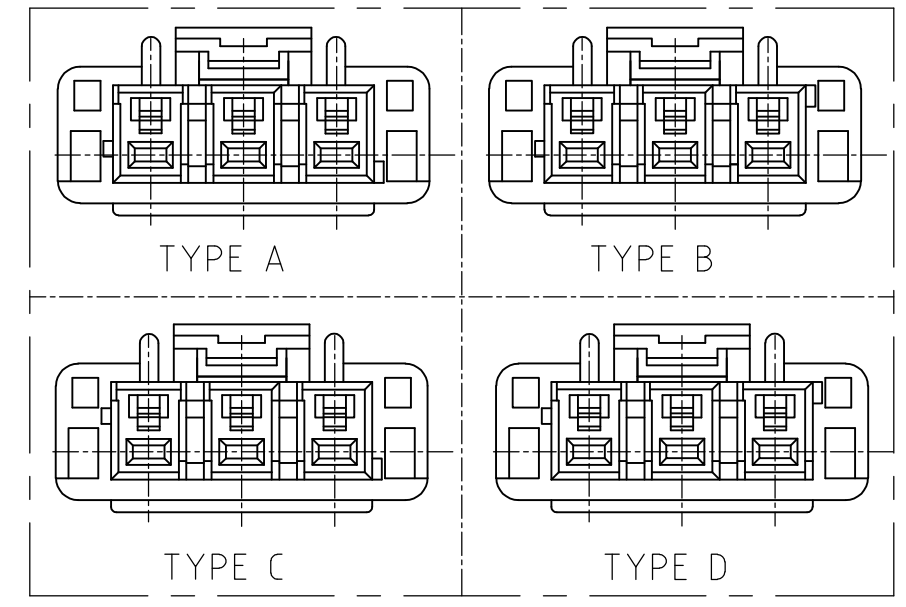

SECT A-A

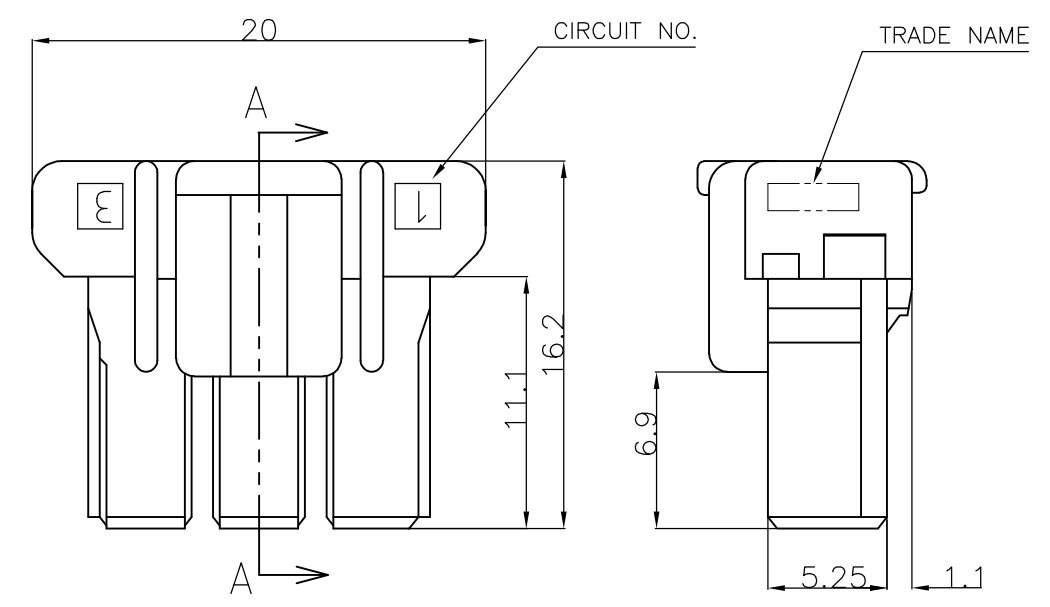

HOSING	6/6 NYLON GRASS FILLED/ NYLON 6
NAME	MATERIAL

- 1 MATING CONN. P/N
HEADER ASS'Y :SEE TABLE
REC CONTACT ;1376347-1,1376348-1
- 2 APPLICABLE PLATE P/N :1376395-1
- 3 PARTS COMPLY WITH GLOW WIRE
REQUIREMENT FOR PARTS OF NON-METALLIC
MATERIAL SUPPORTING A CURRENT-CARRYING
CONNECTION DETAILED IN IEC 60335-1,
SECTION 30 (GWT) .
- 4 NYLON 6, GWT, V-2.
- 5 NYLON 66, GWT, V-0.

4	5	5	5	5	5
1376383-5	TYPE A	NATURAL	3Pos	1376389-5	
3-1376421-4 3-1376383-4	TYPE D	YELLOW	3Pos	3-1376389-4	
2-1376421-3 2-1376383-3	TYPE C	BLUE	3Pos	2-1376389-3	
1-1376421-2 1-1376383-2	TYPE B	RED	3Pos	1-1376389-2	
1376421-1 1376383-1	TYPE A	NATURAL	3Pos	1376389-1	
MATING CONN. P/N	THE TYPE OF KEYING	Color	Pos	PART NO.	

THIS DRAWING IS A CONTROLLED DOCUMENT.		DWN A.OISHI 31AUG00	TE Connectivity		
DIMENSIONS: mm		CHK Y.KASHIWA 28AUG'00			
TOLERANCES UNLESS OTHERWISE SPECIFIED:		APVD Y.KASHIWA 28AUG'00	NAME 5.0 POWER KEY CONNECTOR 3P PLUG HOUSING		
0 PLC ± 0.2 1 PLC ± 0.2 2 PLC ± 0.2 3 PLC ± 4 PLC ± ANGLES ± 1°		PRODUCT SPEC 108-5699	SIZE A3		
MATERIAL SEE TABLE		APPLICATION SPEC 114-5292	CAGE CODE 00779	DRAWING NO C-1376389	RESTRICTED TO -
FINISH SEE TABLE		WEIGHT	SCALE 3:1		
CUSTOMER DRAWING			SHEET 1 OF 1		
			REV C1		