

THIS DRAWING IS UNPUBLISHED. RELEASED FOR PUBLICATION  
 © COPYRIGHT - By - ALL RIGHTS RESERVED.

LOC	DIST	REVISIONS			
P	LTR	DESCRIPTION	DATE	DWN	APVD
HC	00	B1	ECR-12-005726	27MAR12	RK MY

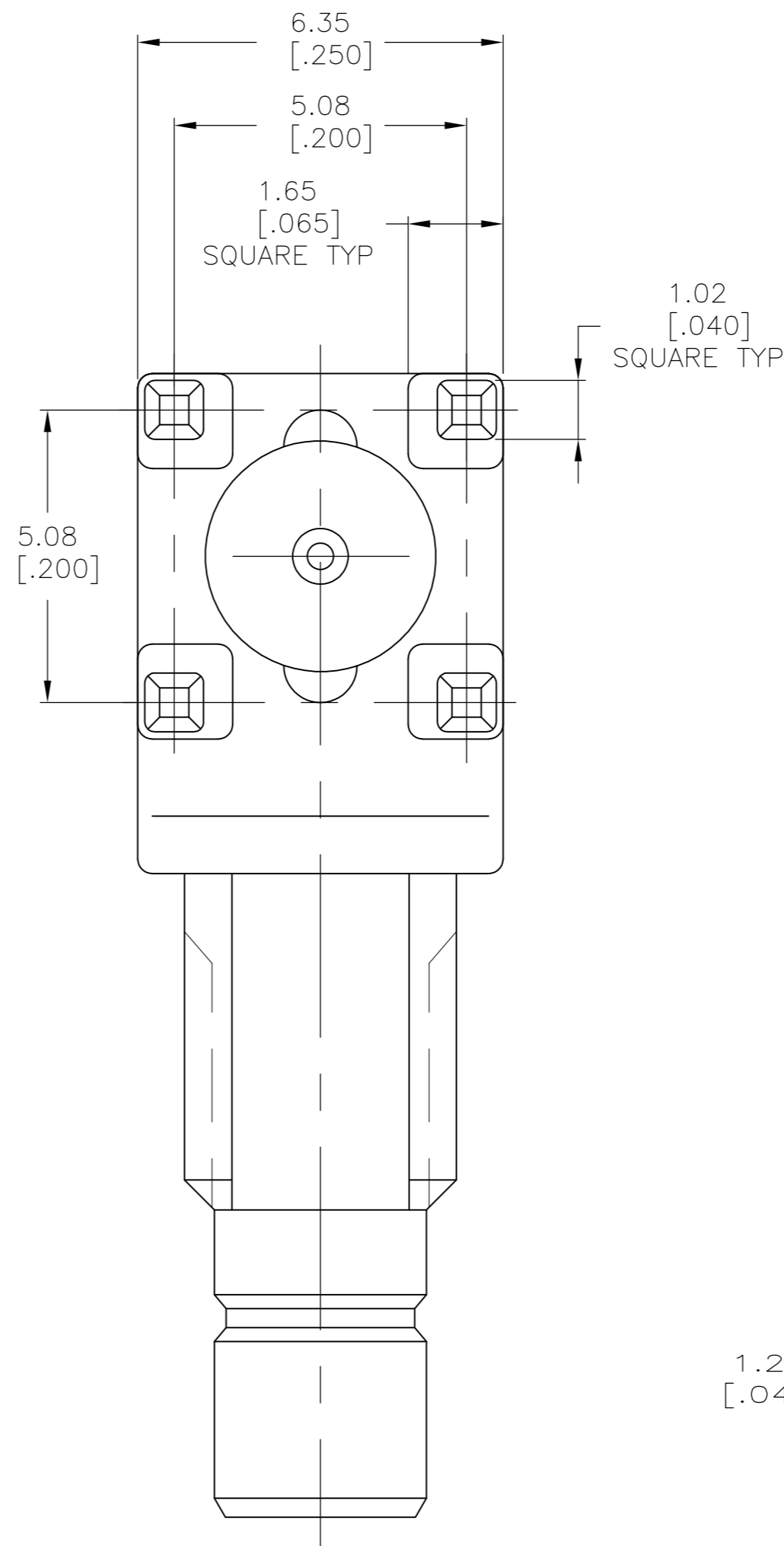

- ⚠ MATERIALS:  
 SHELL: ZINC ALLOY (ACUZINC)  
 CONTACT: BRASS PER QQ-B-626  
 DIELECTRICS: PTFE PER ASTM-D1710
- ⚠ FINISH:  
 CONTACT: GOLD PLATE PER MIL-G-45204  
 SHELL: GOLD PLATE PER MIL-G-45204
- 3. INTERFACE PER MIL-C-39012
- 4. REFERENCE HEWLETT PACKARD PART NUMBER 1250-1512.

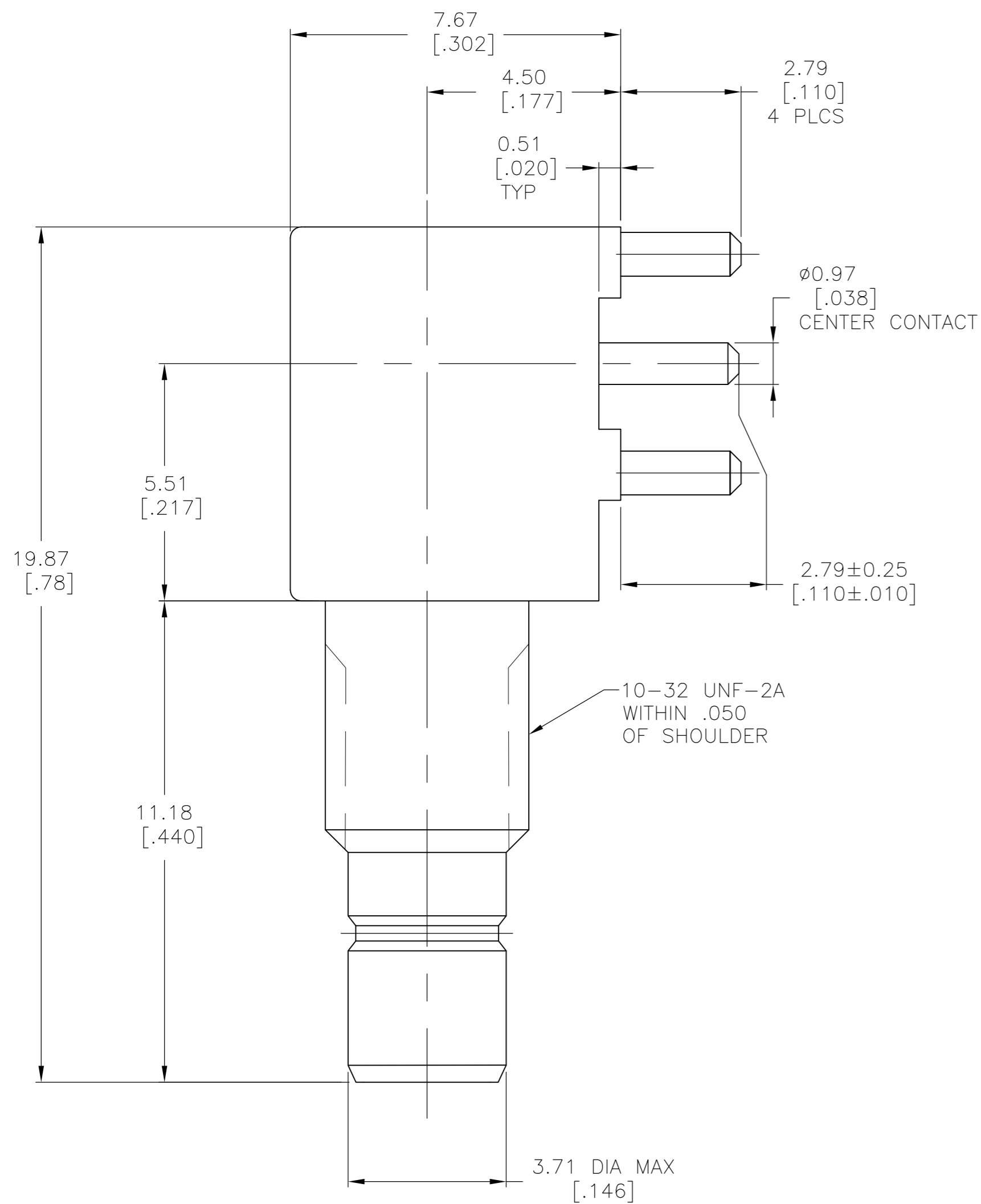
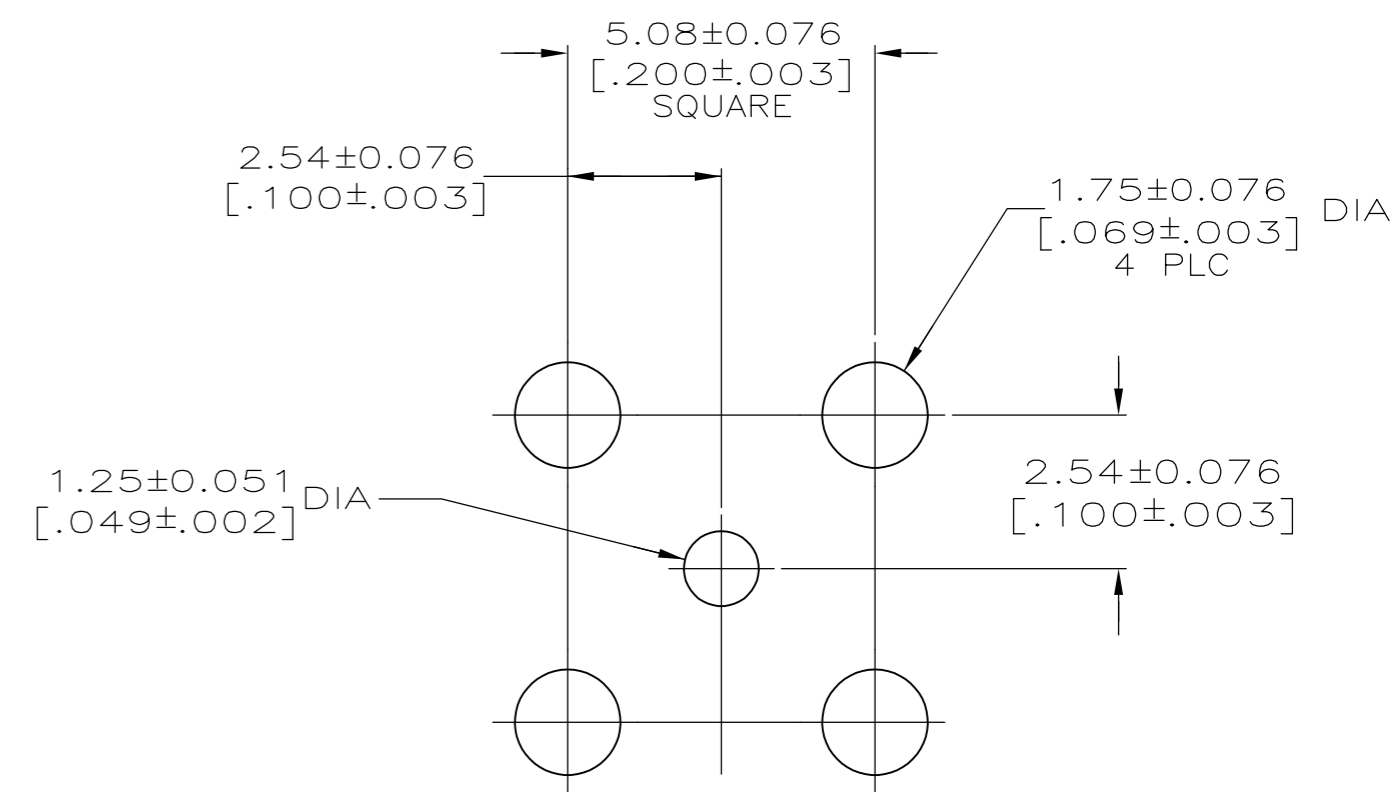

RECOMMENDED PCB CONFIGURATION

414963-1  
 PART NUMBER

THIS DRAWING IS A CONTROLLED DOCUMENT.		DWN S. BURKHOLDER 06/FEB/96	TE Connectivity	
DIMENSIONS: mm		CHK J. CABARLO 3-26-96	PCB JACK, RIGHT ANGLE, SMB	
TOLERANCES UNLESS OTHERWISE SPECIFIED: 0 PLC ± - 1 PLC ± - 2 PLC ± 0.13 [.005] 3 PLC ± - 4 PLC ± - ANGLES ± 4°		APVD J. CABARLO 3-26-96	NAME	
MATERIAL		PRODUCT SPEC	SIZE CAGE CODE DRAWING NO RESTRICTED TO	
FINISH		APPLICATION SPEC	A2 00779 C=414963	
MATERIAL		WEIGHT	SCALE SHEET REV	
CUSTOMER DRAWING		10:1	1 OF 1 B1	