

1

2

3

4

5

6

7

Male

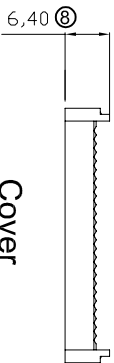
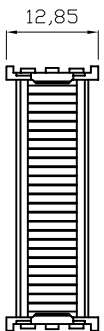
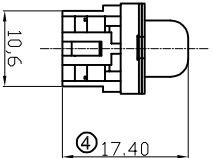
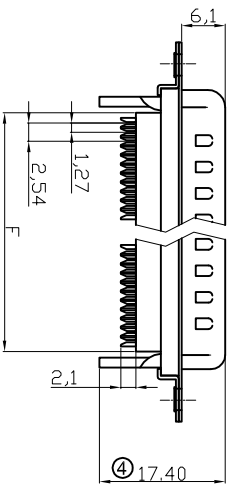
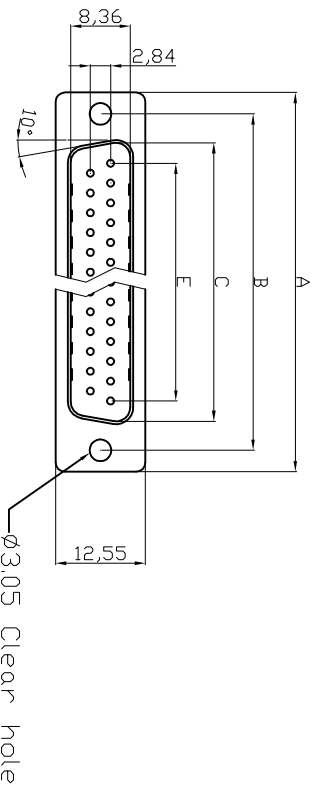

Cover

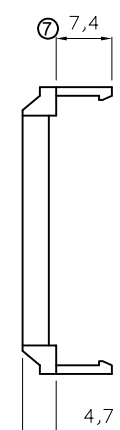

Strain Relief

Without Insulator Support

Dimensions					
Positions	A	B	C	E	F
9	30.81	24.99	16.92	11.08	13.10
15	39.20	33.30	25.25	19.39	20.70
25	53.04	47.04	38.96	33.24	33.68
37	69.40	63.50	55.42	49.86	50.30

RoHS compliant
Unit:mm

1

2

3

4

5

6

7

Scale	Free	⑧	Update the dimension	27.02.2015	Winnle
TOLERANCE					
X.	±0.38	⑦	Update the dimension & shape of cover	09.07.2014	Winnle
X.X	±0.25	⑥	Update the operating temperature	05.06.2014	Winnle
X.XX	±0.13	⑤	Correct the UL-File number	03.04.2014	Winnle
DIM	TOL	④	Update 17.58& 17.28 into 17.40& 17.10mm	07.03.2014	Winnle
X.°	±3°				
X.X°	±1.0°	③	Update the wire specification	28.06.2013	Winnle
Angle	TOL	Id.	Modification	Date	Name

Product Specification

Material
Insulator : Glass-filled Thermoplastic PBT, UL94V-0,Black
Contact : Copper alloy, plating gold flash selective gold
Shell : Steel, 1000" Tin Over 500" min Copper

Electrical

Contact Resistance : 20 milliohms Max at 1 AMP DC.
Insulation Resistance : 1000 megohms at 500 VDC.
Dielectric Withstanding Voltage : 1000 VAC/rms 60Hz for 1 minute
Current Rating : 3 AMP
Voltage Rating : 250 VAC/rms 60Hz
Wire Spec : 26 AWG-28 AWG
③ Operating Temperature: -55°C--+105°C
⑤ UL E No #E198287

Order Code:

A-DXF xx LP11/Z

Contact style: F - Female
S - Male
No. of Contacts
09 / 15 / 25 / 37
Standard: Quality class III

Customer-No.

ASSMANN WSW-No.

A-DXF xx LP11/Z

Drawing-No.

ASS 4891 CO

rev08

Replace

Sheet
1/2

H

G

G

H

H

H

H

1

2

3

4

5

6

7

Female

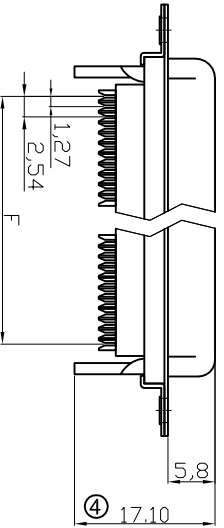
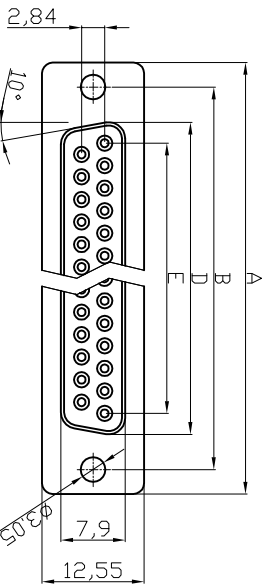

Without Insulator Support

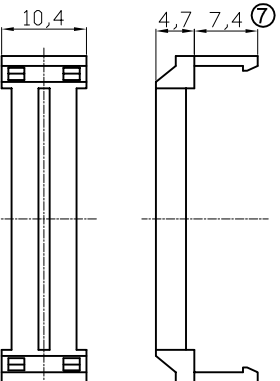
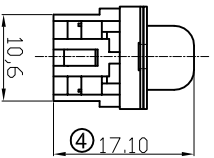

Strain Relief

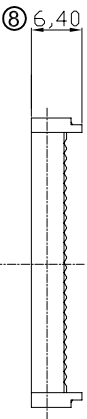

Cover

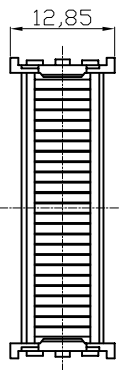

- NOTES:**
- MATERIAL**
- 1. Insulator Material: Glass-Filled Thermoplastic: PBT, UL 94V-0
 - 2. Contact Material: Copper alloy
 - 3. Shell :S'P'OC
 - 4. Plating :selective Gold Flash
- ELECTRICAL**
- 1. Current Rating : 3 AMP
 - 2. Voltage Rating : 250 V AC/rms 60 Hz
 - 3. Contact Resistance: 20mΩ max at 1 AMP DC
 - 4. Insulation Resistance: 1000MΩ at 500 VDC
 - 5. Withstand Voltage : 1000V AC/rms 60Hz for 1 minute
 - 6. Wire Spec: 26 AWG-28 AWG
 - 7. Operating temperature: -55 °C+105 °C
- UL E No #E198287

Dimensions Positions	A	B	D	E	F
9	30.51	24.99	16.33	11.08	10.16
15	39.20	33.30	24.70	19.39	17.78
25	53.05	47.04	38.40	33.24	30.48
37	69.40	63.50	54.80	49.86	45.72

RoHS compliant

Unit: mm

Scale	Free TOLERANCE	⑧ Update the dimension	27.02.2015	Winnie	Date	Name
X.	±0.38	⑦ Update the dimension & shape of cover	09.07.2014	Winnie	15.08.2012	Lucas
X.X	±0.25	⑥ Update the operating temperature	05.06.2014	Winnie	27.02.2015	Winnie
X.XX	±0.13	⑤ Correct the UL-File number	03.04.2014	Winnie		
DIM	TOL	④ Update 17.58&17.28 into 17.40&17.10mm	07.03.2014	Winnie		
X.°	±3°	③ Update the wire specification	28.06.2013	Winnie		
X.X°	±1.0°	Id.				
Angle	TOL	Modification	Date	Name		

Customer-No.

ASSMANN WSW-No.
A-DXF XX LP III/Z

Drawing-No.

ASS 4891 CO rev08

Replace

Sheet 2/2

1

2

3

4

5

6

7

H

G

F

E

D

C

B

A

H

G

F

E

D

C

B

A