

REVISION TABLE					
REV.	ECO #	DESCRIPTION	DATE	BY	APPROVED
24	AC095112	MODIFIED DIMENSIONING SCHEME UPDATED TO SOLIDWORKS	12/16/09	MF	TW

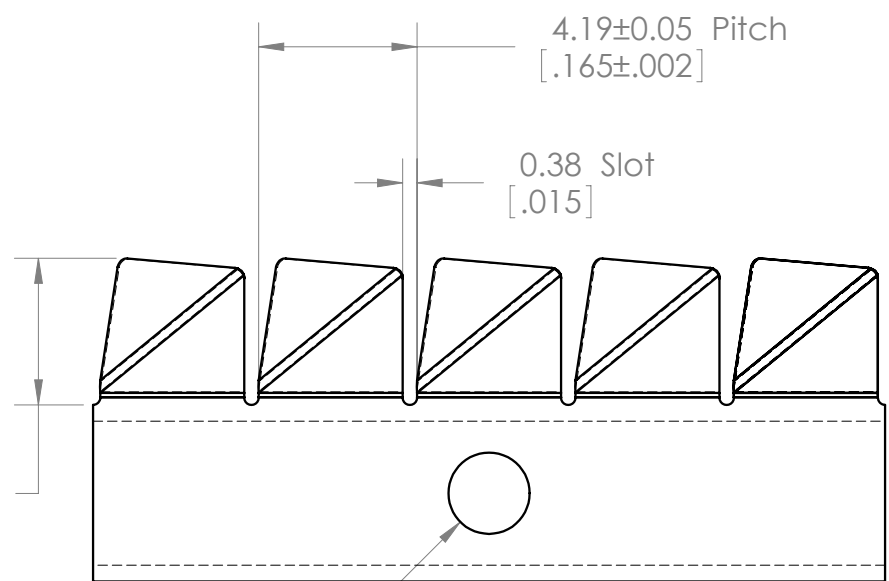

(3.88
[.153])

(Ø2.15
[.085])

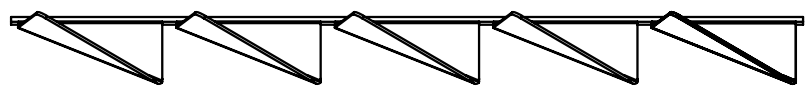
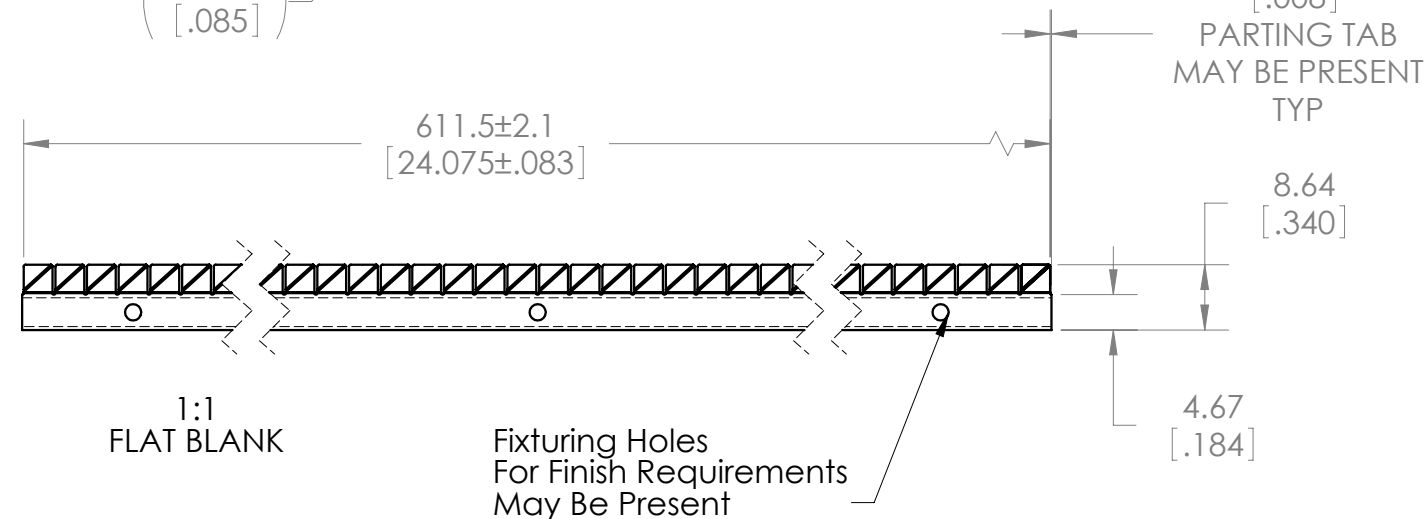

1:1
FLAT BLANK

Fixturing Holes
For Finish Requirements
May Be Present

0.19
[.008]
PARTING TAB
MAY BE PRESENT
TYP

8.64
[.340]

4.67
[.184]

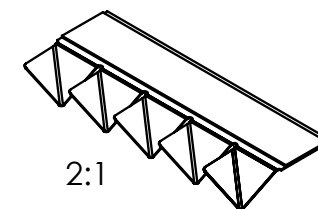

2:1

1.90
[.075]

0.26^{+0.13}
-0.25
[.010^{+0.005}
-0.010]

Optional
PSA Tape

(3.8
[.150]
Tape)

(0.13 Tape
[.005])

APPROVED
By Tim Wrona at 7:22 am, Dec 17, 2009

This 2d drawing is generated from a 3d solid model. Refer to 3d model for any dimensions not shown on this drawing. 3d model dimensions will always take precedent over drawing dimensions.

Block tolerances apply to metric units only. Dual dimensions shown are for reference only and are displayed in 3 places for conversion purposes only.

CAD MAINTAINED
DRAWING. MANUAL
CHANGES UNAUTHORIZED

STD PART REFERENCE:
0077-00xx

UNITS: MM (INCH)

TOLERANCES:
.X = ± .4
.XX = ± .2
.XXX = ± .1

ANGULAR:
X.X° = ± 3.0°
X.XX° = ± 1.0°



3RD ANGLE
PROJECTION
DESIGNED IN SOLIDWORKS

MATERIAL:
BECU ALLOY 25 1/2 H

HEAT TREAT:
DHP 383 MINIMUM
(500 GRAM LOAD)

FINISH:
PLATING OPTIONS AS REQUIRED

STD THICKNESS: (0077)
0.076 ± .005 [.0030]
ULTRA SOFT THICKNESS: (0078)
0.051 ± .005 [.0020]

PRODUCTION DRAWING
CONTROLLED DOCUMENT

ROHS COMPLAINT: (BASE PART)
YES

PART NUMBER SERIES: STANDARD
0097-0555
REV: 24
DATE: 12/16/2009
PART NUMBER SERIES: ULTRA SOFT
0078-0555
MODEL/DRAWN BY: MF
APPROVED BY: TW

INFORMATION CONTAINED IN THIS DOCUMENT IS CONFIDENTIAL AND PROPRIETARY TO LAIRD TECHNOLOGIES. IT MAY NOT BE DISCLOSED TO ANYONE WITHOUT WRITTEN AUTHORIZATION FROM LAIRD TECHNOLOGIES

SCALE: 5:1

SHEET 1 OF 1

SIZE
B