

PC board drilling dimensions(after plating)  
(thickness ≤ 3.20±0.30mm)

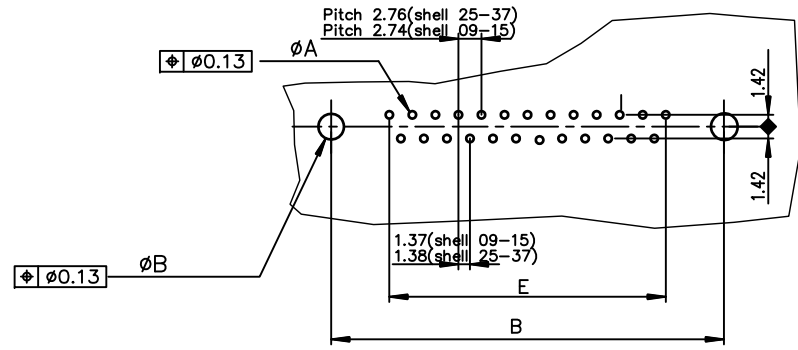
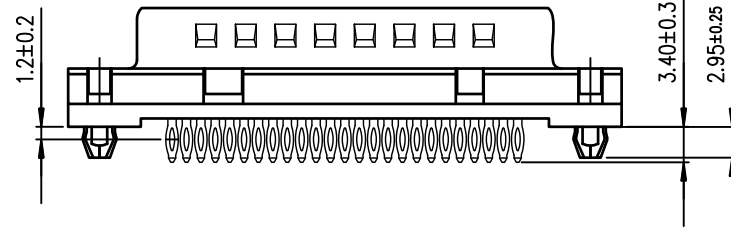

ROHS PART NUMBER

SHELL	A±0.38	B±0.12	C±0.10	D±0.25	E±0.07	Gold Flash	0.76µ Gold	1.25µ Gold
09	30.81	24.99	16.96	16.79	10.96	D09P90C4GL00LF	D09P90C6GL00LF	D09P90C8GL00LF
15	39.14	33.32	25.18	25.12	19.18	D15P90C4GL00LF	D15P90C6GL00LF	D15P90C8GL00LF
25	53.03	47.04	39.12	38.84	33.12	D25P90C4GL00LF	D25P90C6GL00LF	D25P90C8GL00LF
37	69.32	63.50	55.68	55.30	49.68	D37P90C4GL00LF	D37P90C6GL00LF	D37P90C8GL00LF

GENERAL CHARACTERISTICS AND ROHS INFORMATIONS:  
SEE DRAWING C01-8646-0001

mat'l. code		surface	tolerance	projection	product family
		ISO 1302	ISO 406 ISO 1101		D-SUB
ltr	ecn no	dr	date	title	
H	ELX-I-12654	AB	2015-10-26	MALE DELTA-D LOW PROFILE STRAIGHT PRESS-FIT	
J	ELX-I-24020	AAB	2016-06-06		
		angles	linear	mm	scale 2:1
		0±2'	.0±0.1		
			.00±0.1		
			.000±0.1		
		dr	PESSON	1995-10-03	dwg no
		engr	MITHUN PAUL	2016-06-06	sheet 1 of 1
		chr	ATHUL A.B	2016-06-06	size
		appd	BIJU K PAUL	2016-06-06	A3
		Amphenol FCI			C01-8646-0369
		type			Product Customer Drawing
sheet index	revision	J			
	sheet	1			