

Technical specification :

Rated voltage: 60 V
IEC 61076-2-104

Current rating: 3 A at 40°C
IEC 61076-2-104

Insulation resistance: >=100 MΩ
IEC 60512

Pollution degree: 3/2
IEC 60664-1

Degree of protection: IP 67, in mated condition
IEC 60529

Temperature range: -30°C ... +80°C
EN 60512-11-10
-40°C ... +85°C
EN 60512-11-4

Mating cycles: >=100
IEC 60512-9a

Cable specification:

Temperatur range:
static -20°C ... +80°C
flexibel -5°C ... +80°C

Materials:

Contact: CuZn, Ni b / Au 0,2 gal.

Contact carrier: PA, UL 94 V-0

Sealing: FPM

Coupling nut: GD-Zn, Nickel plated

Moulding body: TPU, UL 94 HB, grey

Installation specification:

Recommended torque: 0,4 Nm

Conec installation tool: Torque wrench: 36-000200
Insert across flats 9: 36-000210

Contact assignment:

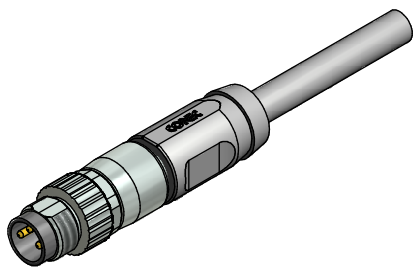
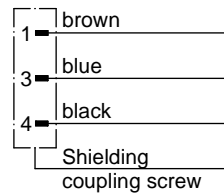

Part no:	Description:	Length L:	Cable:
42-10859	SAL - 8S - RS3 - 2 / G3	2m	PVC, UL 2464, grey, 3x0,25mm ² Cable: 781-G32300
42-10860	SAL - 8S - RS3 - 3 / G3	3m	
42-10861	SAL - 8S - RS3 - 5 / G3	5m	
42-10862	SAL - 8S - RS3 - 10 / G3	10m	
42-xxxxx	SAL - 8S - RS3 - ... / G3	x	

DO NOT ALTER CAD DRAWING BY HAND RoHS & REACH compliant	Index: b 29.04.16 rob Ä6110 data sheet modified, moulding updated		dim. in mm		title: Male connector M8x1 axial, 360°-shielding	
			date	name		
	tolerance of cable: L ≤ 4m: L + 40mm L > 4m: L + 1%		drawn	27.10.09	Franz	dwg no: 42K1A180
	general tolerance: 0 ± 0,50mm 0,0 ± 0,25mm 0,00 ± 0,10mm + ± 5°		appd.	27.10.09	Burschik	
	THIS DRAWING MAY NOT BE COPIED OR REPRODUCED IN ANY WAY, AND MAY NOT BE PASSED ON TO A THIRD PARTY WITHOUT WRITTEN PERMISSION. OWNERSHIP AND COPYRIGHT OF CONEC GmbH		CONEC®		part no: see table	