

**59075 Heavy Duty Features and Benefits**



**Features**

- 2 Part Magnetically Operated Proximity Sensor
- Heavy Duty Stainless Steel Threaded Barrel with retaining nuts
- M12 by 1.00mm thread
- 5000mm (197") Heavy duty double insulated flying leads

**Benefits**

- Robust construction makes this sensor well suited to harsh industrial environments
- Simple installation and adjustment using supplied retaining nuts
- No standby power requirement
- Operates through non-ferrous materials such as wood, plastic or aluminium
- Hermetically sealed, magnetically operated contacts continue to operate long after optical and other technologies fail due to contamination

**Applications**

- Off road and heavy vehicles
- Farm machinery

**DIMENSIONS**

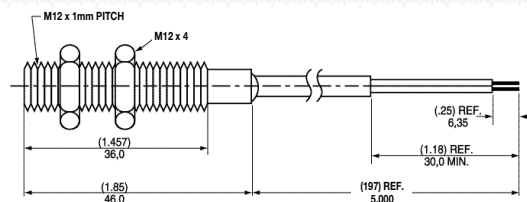
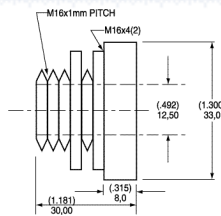

**Recommended Activating Positions:**

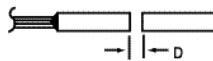

Sensors and Matching Actuators (Note 2)		Actuator	Sensor
<b>Must Actuate</b>	<b>Must Release</b>		
.393 (10,0)	1.18 (30,0)	57075-000	59075-010

Electrical Specifications and Operating Characteristics			Form A SST-NO Standard
<b>Contact Type</b>			
Contact Rating		Watt - max.	10
Voltage	Switching	Vdc - max.	200
	Breakdown	Vdc - min.	250
Current	Switching	A - max.	0.5
	Carry	A - max.	1.2
Resistance	Contact, Initial	- max.	0.2
	Insulation	- min.	10 <sup>0</sup>
Capacitance	Contact	p F - typ.	0.3
Temperature	Operating	°C	-40 to + 105
	Storage	°C	-65 to + 105
Time	Operate	ms - typ.	1.0
	Release	ms - typ.	1.0
Shock	11ms 1/2 sine	G - max.	100
Vibration	50-2000 Hz	G - max.	30

- Notes:
1. Flying Leads
  2. Order Actuators as a separate item.
  3. 59075 PVC Double Insulated Cable, BS 6500, 3A 16/0.2 (0.5mm)

INFORMATION PROVIDED ON THIS DATA SHEET IS PROVIDED FOR INFORMATION PURPOSES ONLY AND SHOULD NOT BE RELIED UPON AS BEING ACCURATE FOR ANY PARTICULAR PURPOSE. Product performance may be affected by the application to which the product is put. Upon request, HAMLIN will assist purchasers by providing information specific to any particular application. HAMLIN disclaims any and all liability whatsoever for any purchaser's reliance upon the information contained on this data sheet without further consultation with authorised representatives of HAMLIN.

**Breed Electronics USA** Tel: 001 920 648 3000 • Fax: 001 920 648 3001 • Email: sales@hamlin.com  
**Breed Electronics UK** Tel: +44 (0)1379 649700 • Fax: +44 (0)1379 649702 • Email: uksales@breedtech.com  
**Breed Electronics Germany** Tel: +49 (0) 6181 953660 • Fax: +49 (0) 6181 9536666 • Email: hamlin-electronics.de@breedtech.com  
**Breed Electronics France** Tel: +33 1 46 87 02 02 • Fax: +33 1 46 86 67 86 • Email: hamectrol@hamectrol.fr  
**www.breedelectronics.com**